

PARENT PARCEL: 04-00-016-000-001 THRU -005

CHILD PARCEL: XX-XX-XXX-XXX-XXX

STARTING POINT: PLAT VOL. 107 PG. 35

19-04229-C

SURVEYOR'S CERTIFICATION

I DO HEREBY CERTIFY THAT THE BUILDING FOUNDATIONS OF UNITS 1-5 OF CONCORD VILLAGE NO.2 CONDOMINIUMS PHASE 1, INCLUDING THE LOCATION, OUTSIDE DIMENSIONS, FINISHED FLOOR ELEVATIONS OF EACH FAMILY UNIT AND COMMON AREAS ARE SHOWN ON THIS DRAWING AS CONSTRUCTED. I HEREBY CERTIFY THAT THIS DRAWING ACCURATELY REFLECTS THE LOCATION OF APPURTENANT IMPROVEMENTS AND RECORDED EASEMENTS, AND THERE WERE NO ENCROACHMENTS OFF OF OR ON TO THE PROPERTY AT THE TIME OF THE SURVEY DATED 9/24/19.

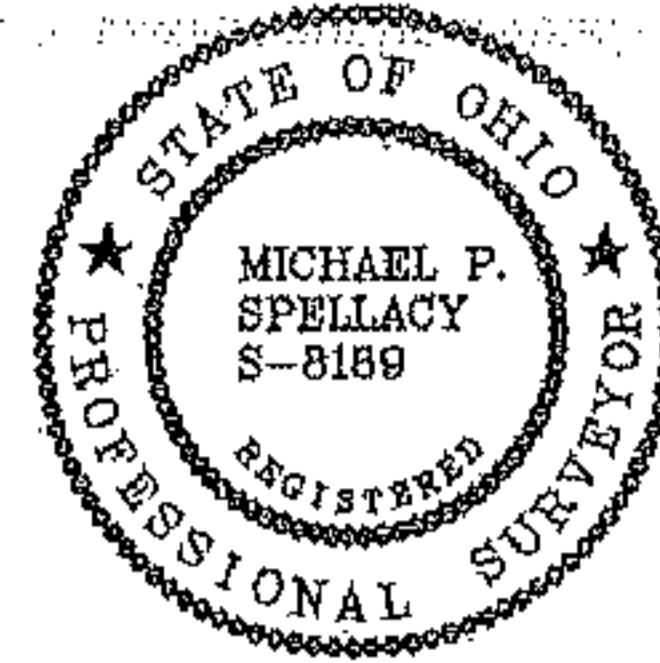

Michael P. Spellacy

MICHAEL P. SPELLACY, P.S. No. 8169

11/21/2019

TO CORRECT LIMITED COMMON ELEMENT UNIT NUMBERS AND SURVEYOR'S CERTIFICATION UNIT NUMBERS SHOWN ON THE RECORDED PLAT VOL. 107, PG. 35 L.C.P.R.

S 89°29'38" E

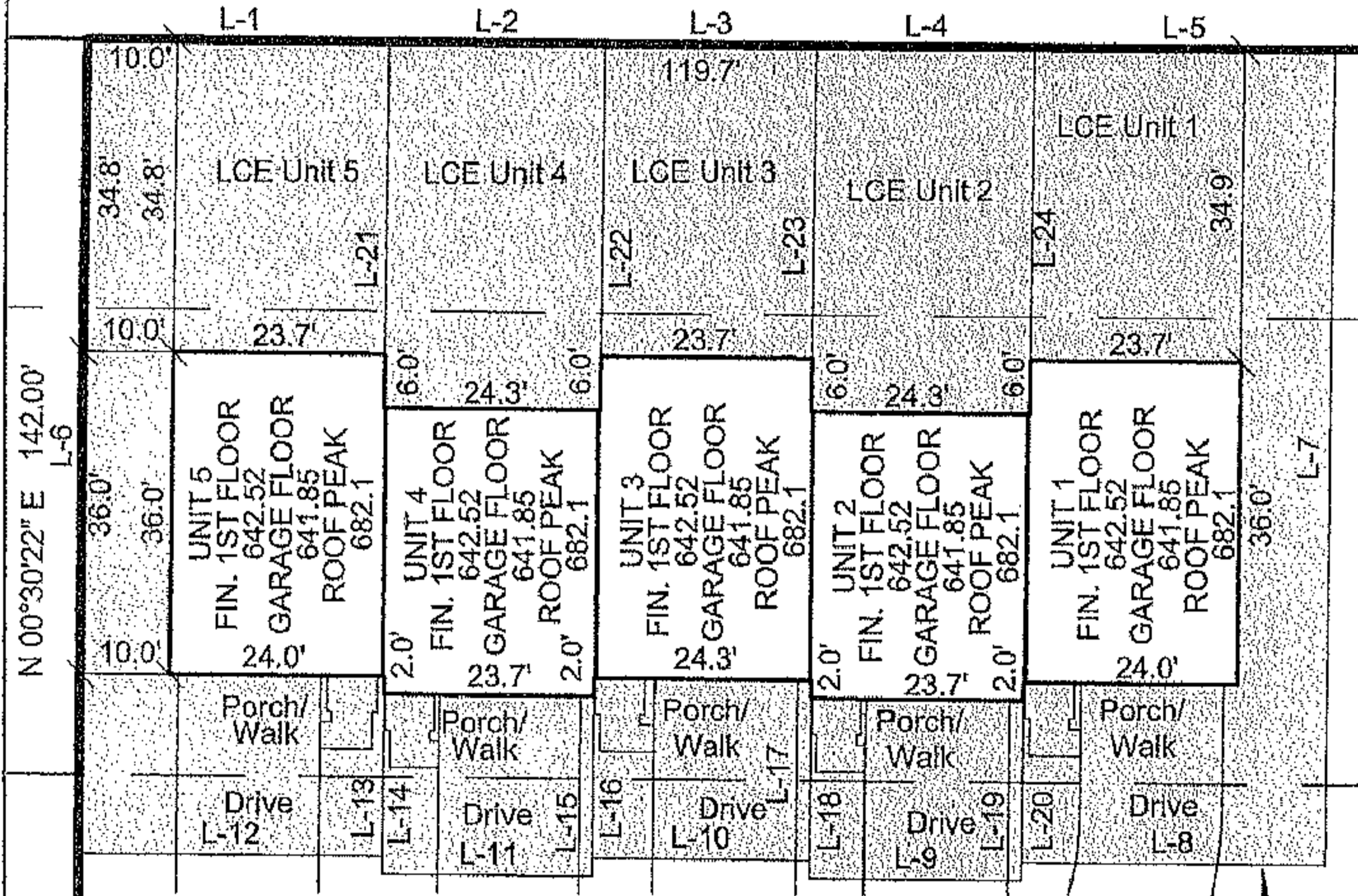

DETAIL: 1 INCH = 20 FEET

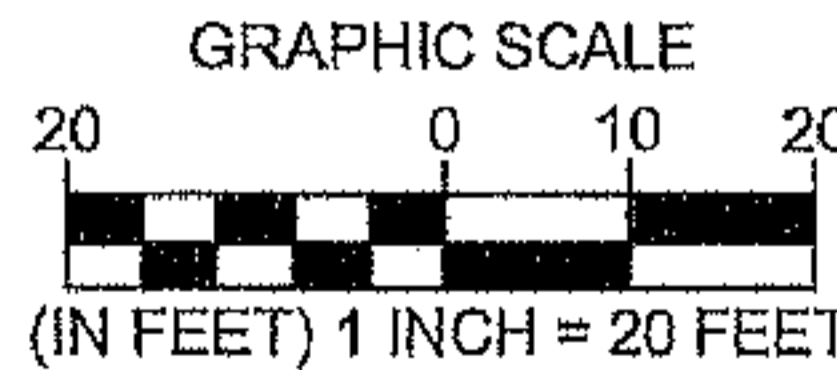

LIMITED COMMON ELEMENTS (LCE)

CERTIFICATE OF CORRECTION	POLARIS ENGINEERING & SURVEYING, INC. 34600 CHARDON ROAD - SUITE D WILLOUGHBY HILLS, OHIO 44094 (440) 944-4433	CONCORD VILLAGE NO.2 CONDOMINIUMS	CONTRACT NO. 19071
---------------------------	---	---	-----------------------

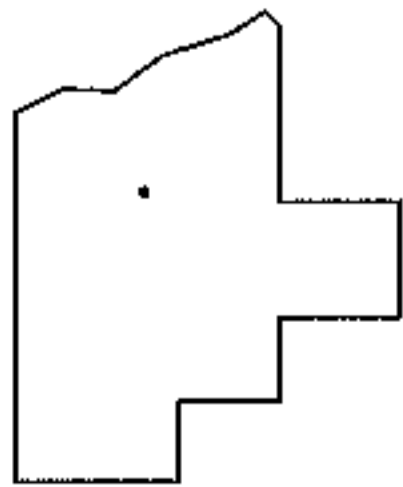

SPLITS/DEEDS PROCESSED

LORAIN COUNTY TAX MAP DEPARTMENT
226 MIDDLE AVE. ELYRIA, OHIO

SURVEYED BY: MICHAEL SPELLACY

CLOSURE: NA

MAP PAGE(S): 04-00-016

APPROVED BY: TJS DATE: 12/2/19

SCALE: 1"= 100 PRIOR INST.: NA