

PARENT PARCEL: 15-00-055-104-091, -094

CHILD PARCEL: 15-00-055-104-099 THRU -102

STARTING POINT: SOUTHEAST CORNER OF O.L.55

20-04102

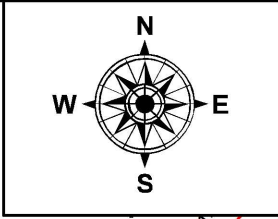

340.60

330.18

900

-003  
1.23

80

80

145.01

~~340.57~~

195.57

185.04

~~330.05~~

145.01

448.85

~~-099~~  
1.49

447.63

~~-091~~  
3.50

~~-100~~  
2.01

446

~~-102~~  
1.88  
1.89

~~-094~~  
3.36

444.45

~~-101~~  
1.48

443.24

AC.CORR.PER.SURV.  
R.LUMBREZER

145

~~340.40~~

195.40

184.30

~~329.30~~

145

1290

7-028

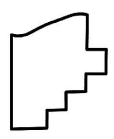

**SPLITS/DEEDS PROCESSED**  
LORAIN COUNTY TAX MAP DEPARTMENT  
226 MIDDLE AVE. ELYRIA, OH

SURVEYED BY: RONALD J. LUMBREZER  
CLOSURE: 1:153,697  
MAP PAGE(S): 15-00-055  
APPROVED BY: RRM DATE: 3-12-20  
SCALE: 1" = 100 PRIOR INSTRUMENT: 20200750747