

PARENT PARCEL: 07-00-036-000-535

CHILD PARCEL: CERTIFICATE OF CORRECTION

STARTING POINT: RESERVE AT WINFIELD FARM NO. 1 PV. 104 PG. 6

19-04075-C

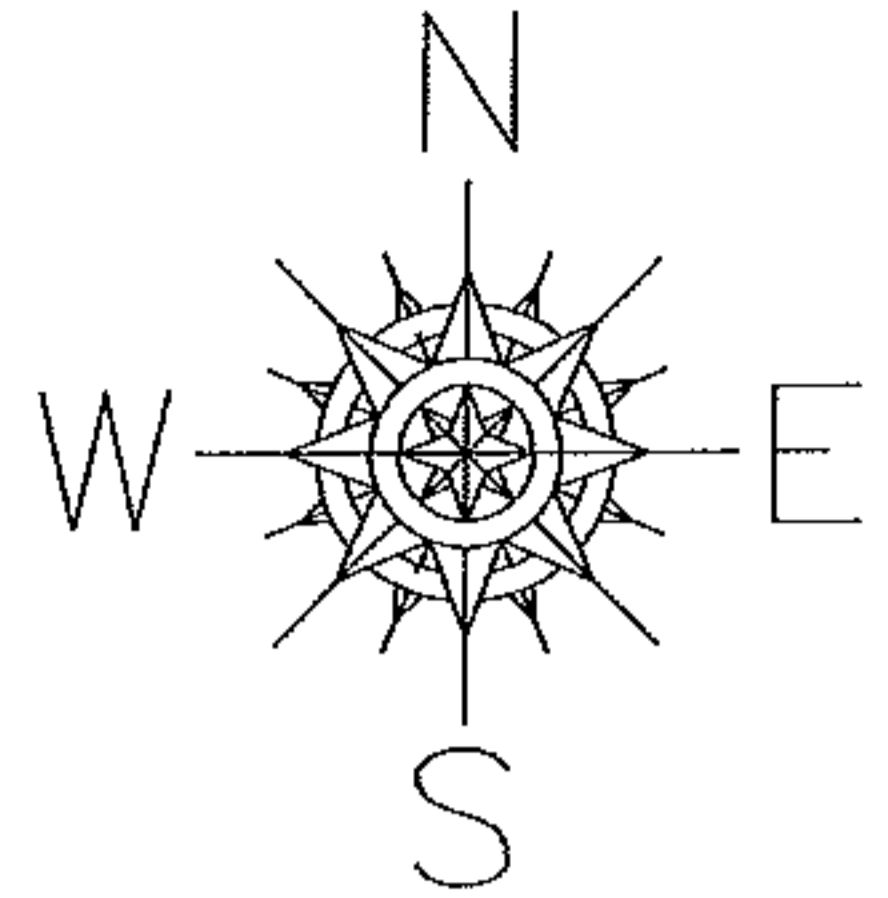

# CERTIFICATE OF CORRECTION

THE RESERVE AT WINFIELD FARM NO. 1  
PLAT VOL. 104, PG. 06  
FILE NO. 2017-0649466

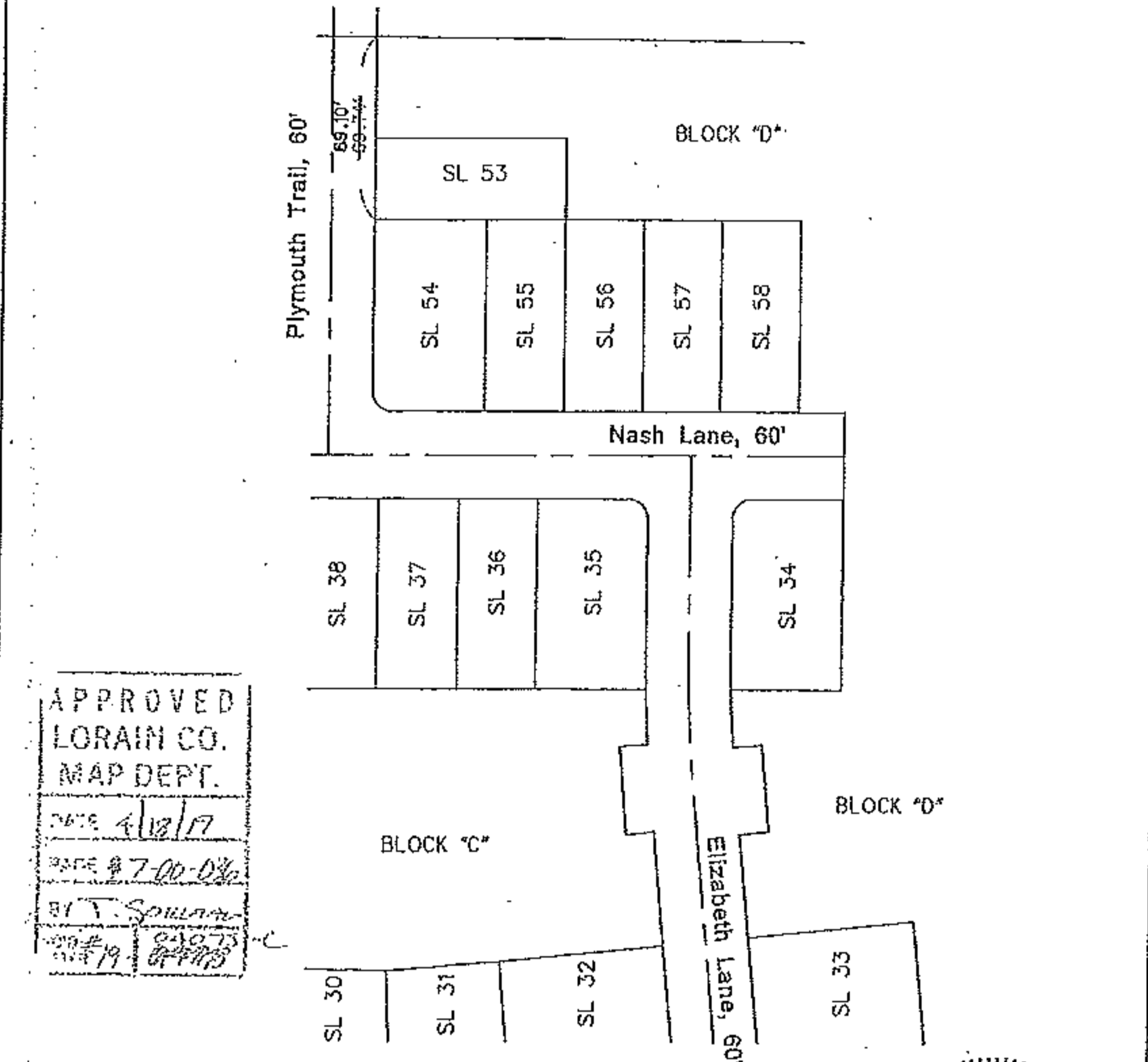

APPROVED  
LORAIN CO.  
MAP DEPT.

DATE 4/18/19  
PAGE # 7-00-036  
BY T. Spillman  
4/18/19

### SURVEYOR'S CERTIFICATION

This is to certify that certain corrections need to be made to the plot of The Reserve at Winfield Farm No. 1, as recorded in Lorain County Plat Vol. 104, Pg. 6.

The corrections required are as follows:

1. Revise a dimension on the easterly right of way line of Plymouth Trail from 69.74' to 69.10' (see above exhibit)

*Jeremy M. Sack*  
Jeremy M. Sack, P.S. S-8557

2-28-2019  
Date

Before me a notary public in and for Medina County, Ohio, personally appeared the above named Jeremy M. Sack, P.S. S-8557 who acknowledged the making of the foregoing instrument and the signing of this certificate of correction to be their own free act and deed. In testimony whereof I have hereunto set my hand and official seal at

Sharon Center, Ohio this 28<sup>th</sup> day of February, 2019.

*Sharon Center*  
Notary public and  
Attorney at Law

My commission expires has no expiration date  
pursuant to Ohio Rev. Code Sec. 147.03



Prepared by  
TSS Engineering, LLC  
12345678901234567890  
12345678901234567890  
12345678901234567890



WINFIELD FARM NO. 1

PROJECT NUMBER  
1417

DATE  
2/18/2019

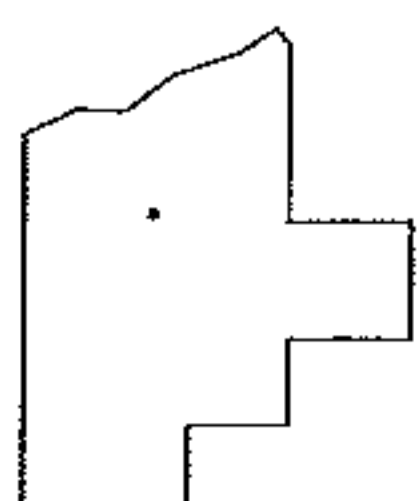

## SPLITS/DEEDS PROCESSED

LORAIN COUNTY TAX MAP DEPARTMENT  
226 MIDDLE AVE. ELYRIA, OHIO

SURVEYED BY: JEREMY SACK  
CLOSURE: NA  
MAP PAGE(S): 07-00-036  
APPROVED BY: TJS DATE: 4/18/19  
SCALE: NA PRIOR INST.: DV XXXX/XXX