

RASTER

PARENT PARCEL: 16-00-068-000-003

CHILD PARCEL: 16-00-068-000-027,-028

STARTING POINT: INTERSECTION OF C/L OF LAW RD. AND C/L OF ISLAND RD.

NO. 01776

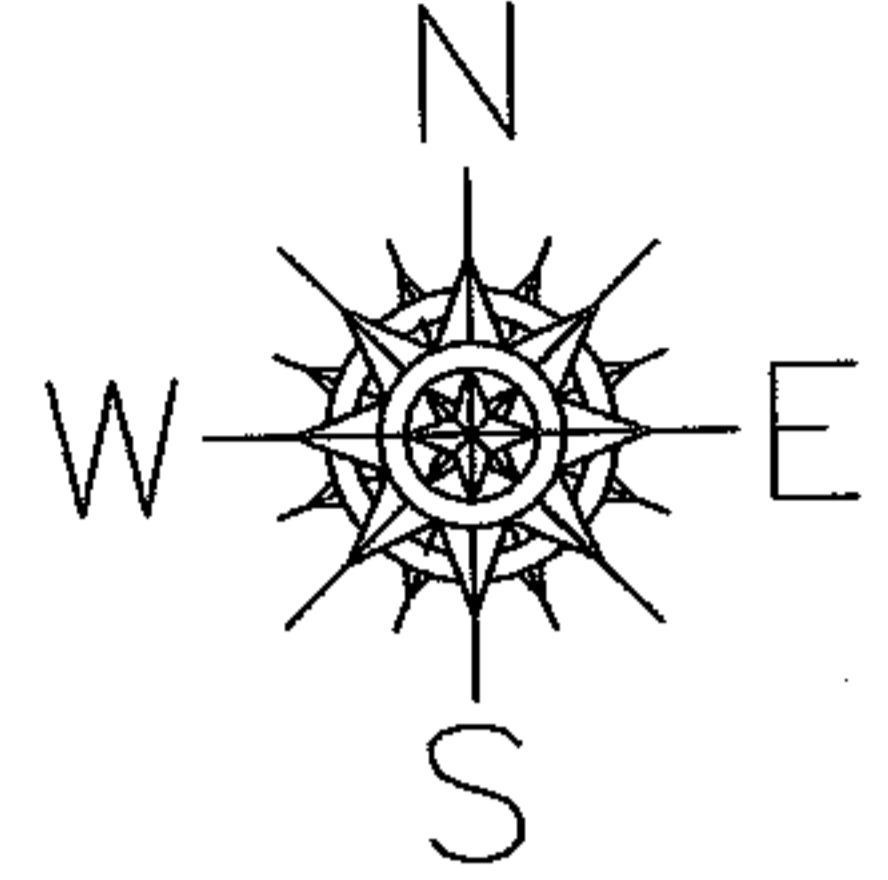

ISLAND RD.

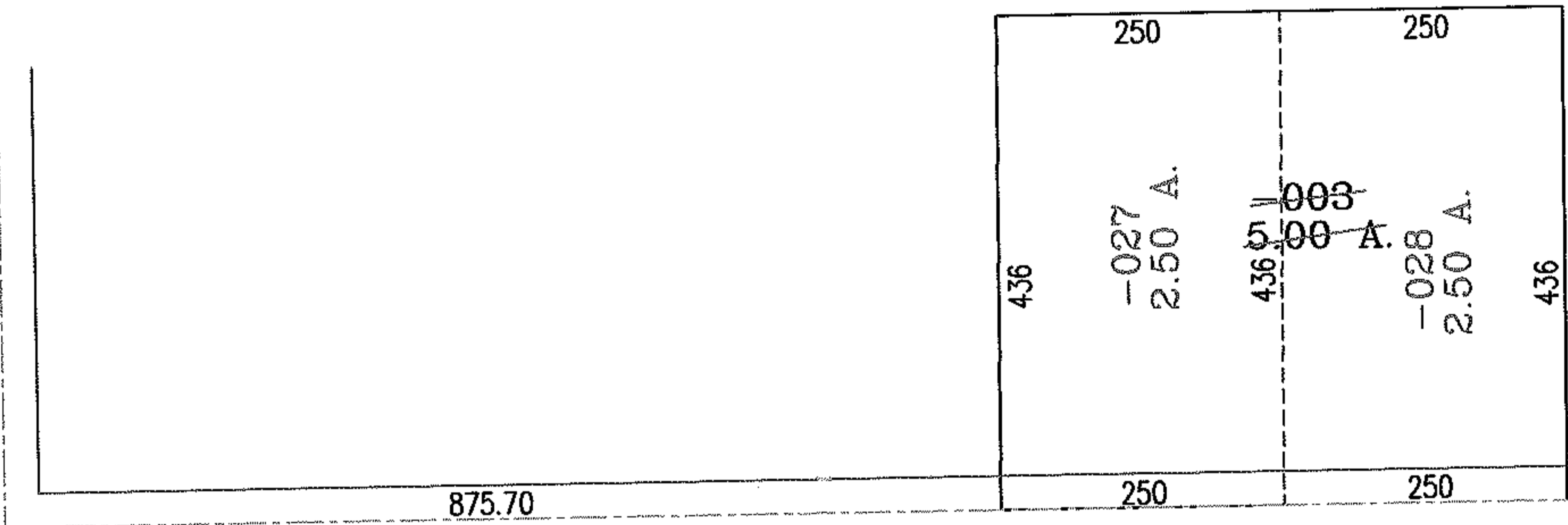

875.70

LAW RD.

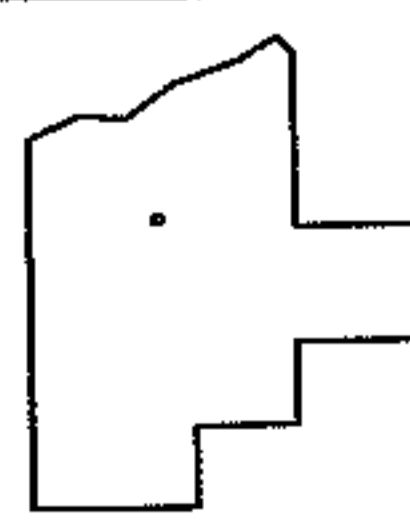

**SPLITS/DEEDS PROCESSED**  
**LORAIN COUNTY TAX MAP DEPARTMENT**  
 226 MIDDLE AVE. ELYRIA, OHIO

SURVEYED BY: RICHARD D. CARLSON  
 CLOSURE: .00:10.000  
 MAP PAGE(S): 16-00-068-A  
 APPROVED BY: RRM DATE: 10-13-04  
 SCALE: 1" = 200 PRIOR INSTRUMENT: 20020829455