

MASTER

PARENT PARCEL: 04-00-020-104-625

CHILD PARCEL: 04-00-020-104-626 THRU 635

STARTING POINT: INT CL SAWMILL DR AND DEERFIELD DR

NO. 01747

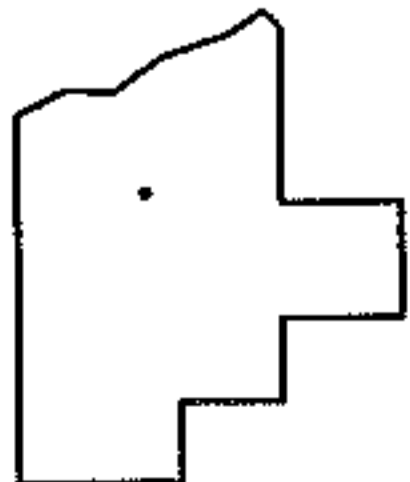
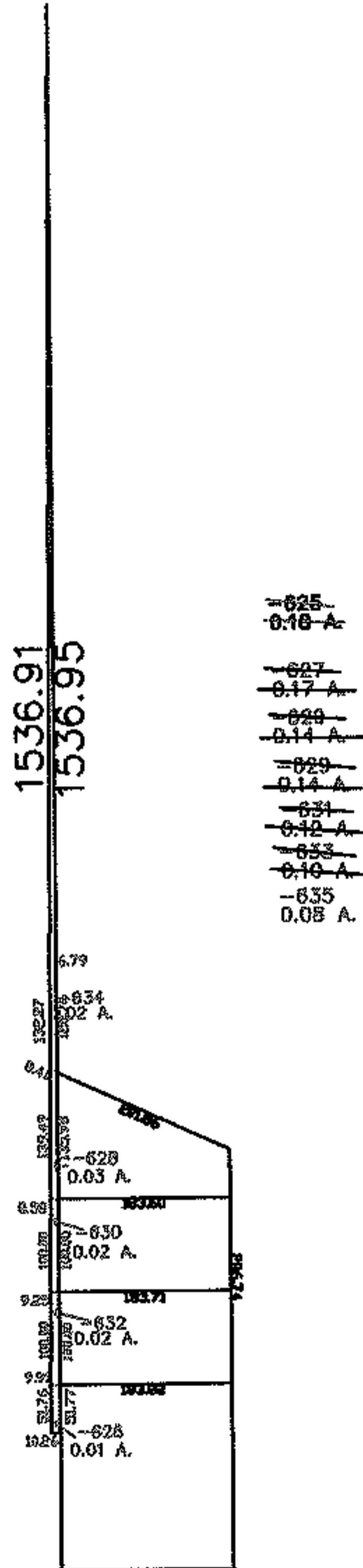
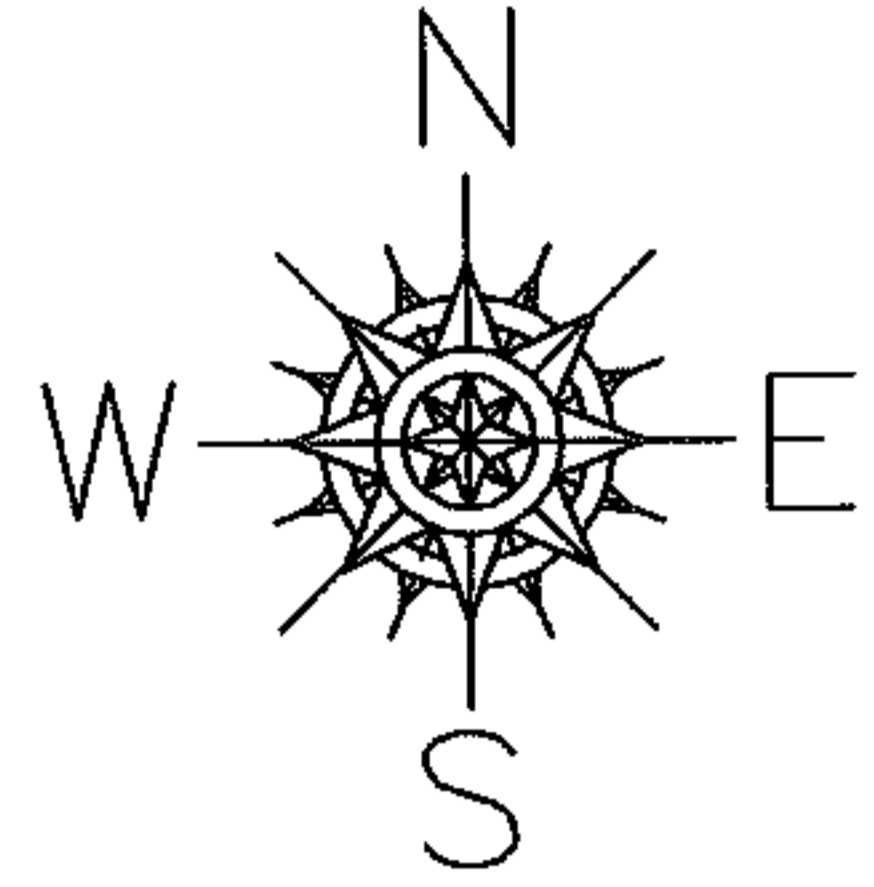

SPLITS/DEEDS PROCESSED
 LORAIN COUNTY TAX MAP DEPARTMENT
 226 MIDDLE AVE. ELYRIA, OHIO

SURVEYED BY: GEORGE A. HOFMANN
 CLOSURE: 1:10.000
 MAP PAGE(S): 04-00-020-H
 APPROVED BY: JAH DATE: 8-26-04
 SCALE: 1" = 300 PRIOR INSTRUMENT: NONE