

PARENT PARCEL: 09-00-088-105-007,-008,09-00-098-000-001
CHILD PARCEL: 09-00-088-105-053,09-00-098-000-052,-053
STARTING POINT: INTERSECTION OF C/L OF PARSONS RD. AND C/L OF OBERLIN RD.

NO. 01638

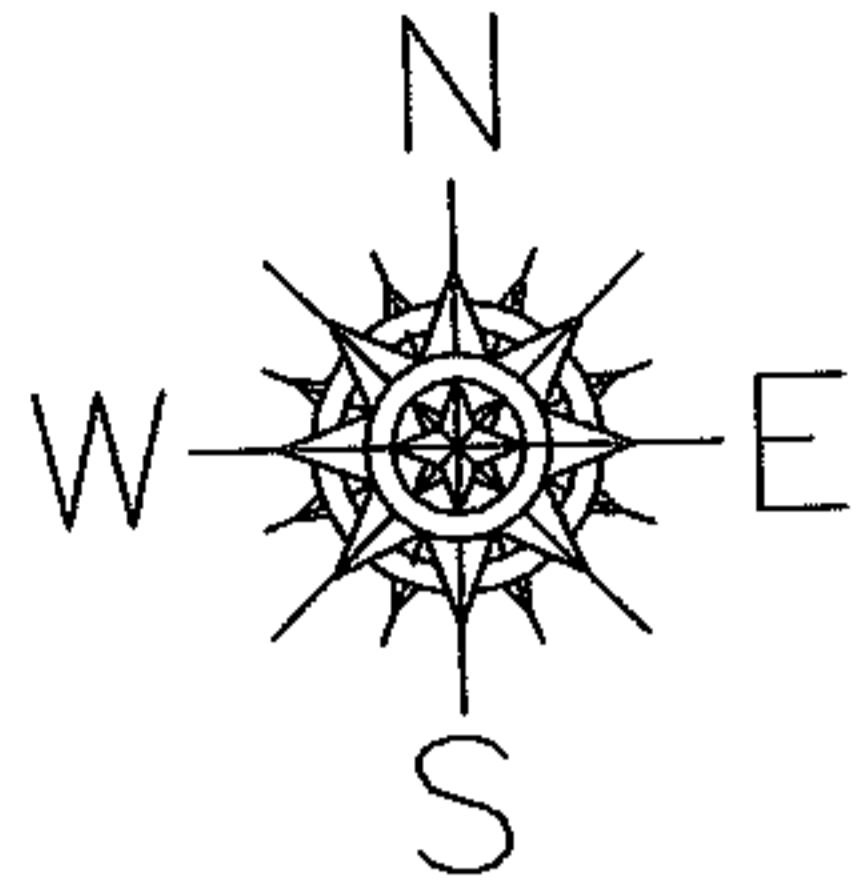
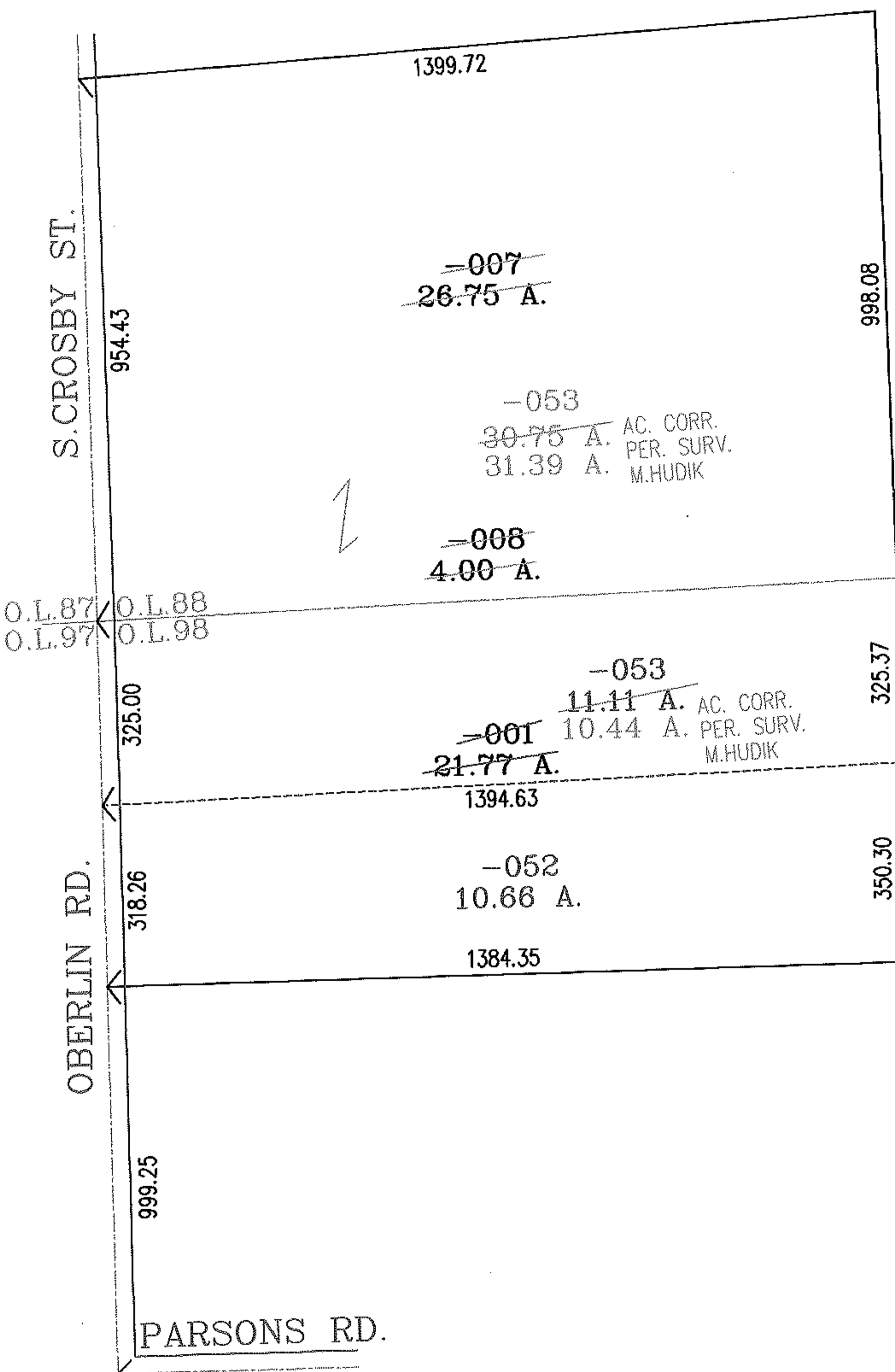

SPLITS/DEEDS PROCESSED
LORAIN COUNTY TAX MAP DEPARTMENT
 226 MIDDLE AVE. ELYRIA, OHIO

SURVEYED BY: MICHAEL J. HUDIK
 CLOSURE: .00:10.000
 MAP PAGE(S): 9-00-088-A,9-00-098-A
 APPROVED BY: RRM DATE: 4/28/04
 SCALE: 1" = 300 PRIOR INSTRUMENT: DV 1217/867