

PARENT PARCEL: 07-00-018-101-058, -07-00-018-101-252

CHILD PARCEL: --SAME--

STARTING POINT: NE CORNER OF S/L 9 AND N ROW OF HIGHLAND DR.

NO. 01626

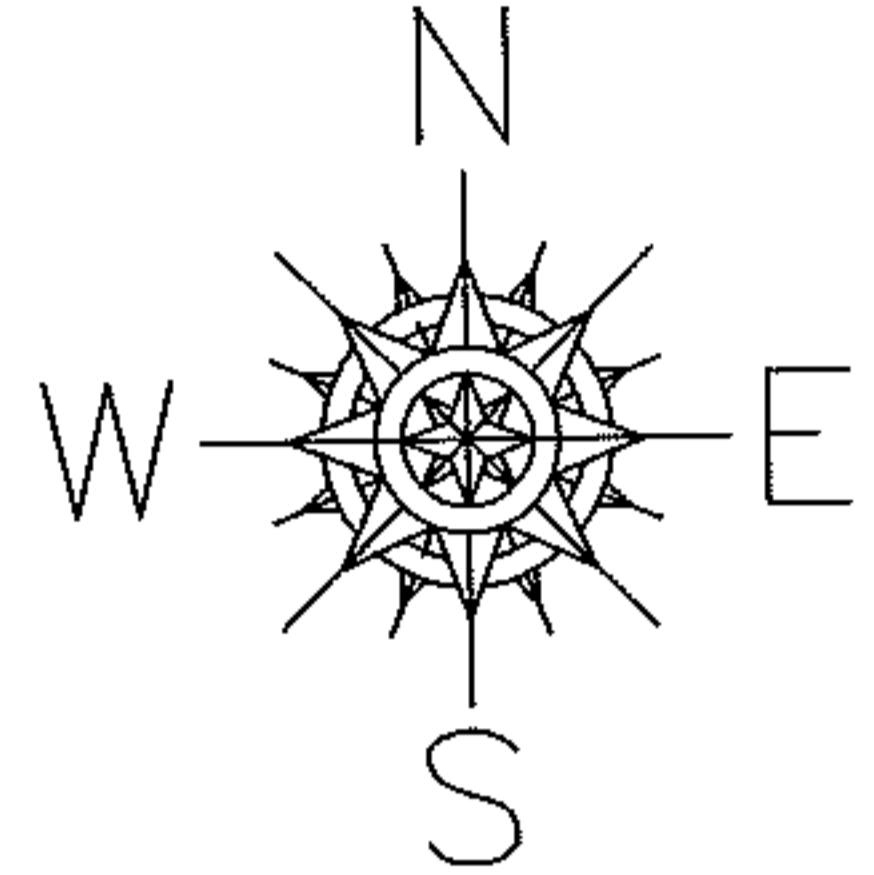

HIGHLAND DR

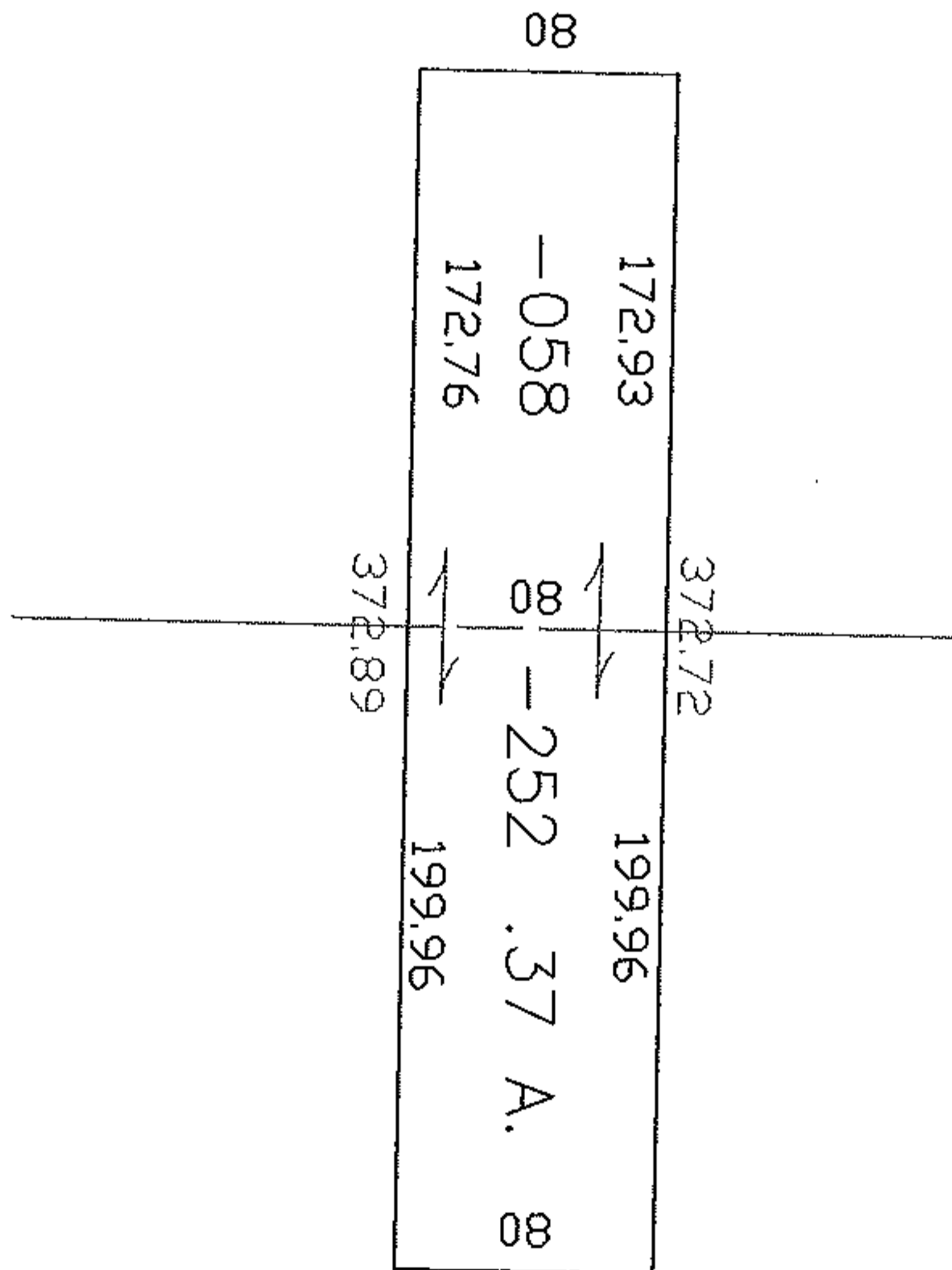

SPLITS/DEEDS PROCESSED

LORAIN COUNTY TAX MAP DEPARTMENT
226 MIDDLE AVE. ELYRIA, OHIO

SURVEYED BY: DANE HAPONEK

CLOSURE: 1:10,000

MAP PAGE(S): 07-00-018-A

APPROVED BY: DRH DATE: 4/8/2004

SCALE: 1" = 100' PRIOR INSTRUMENT: 480341