

RASTER

PARENT PARCEL: 15-00-006-000-046, -047

CHILD PARCEL: 15-00-006-000-048 THRU -051

STARTING POINT: CENTERLINE OF LAGRANGE RD. & O.L. 6

NO. 01610

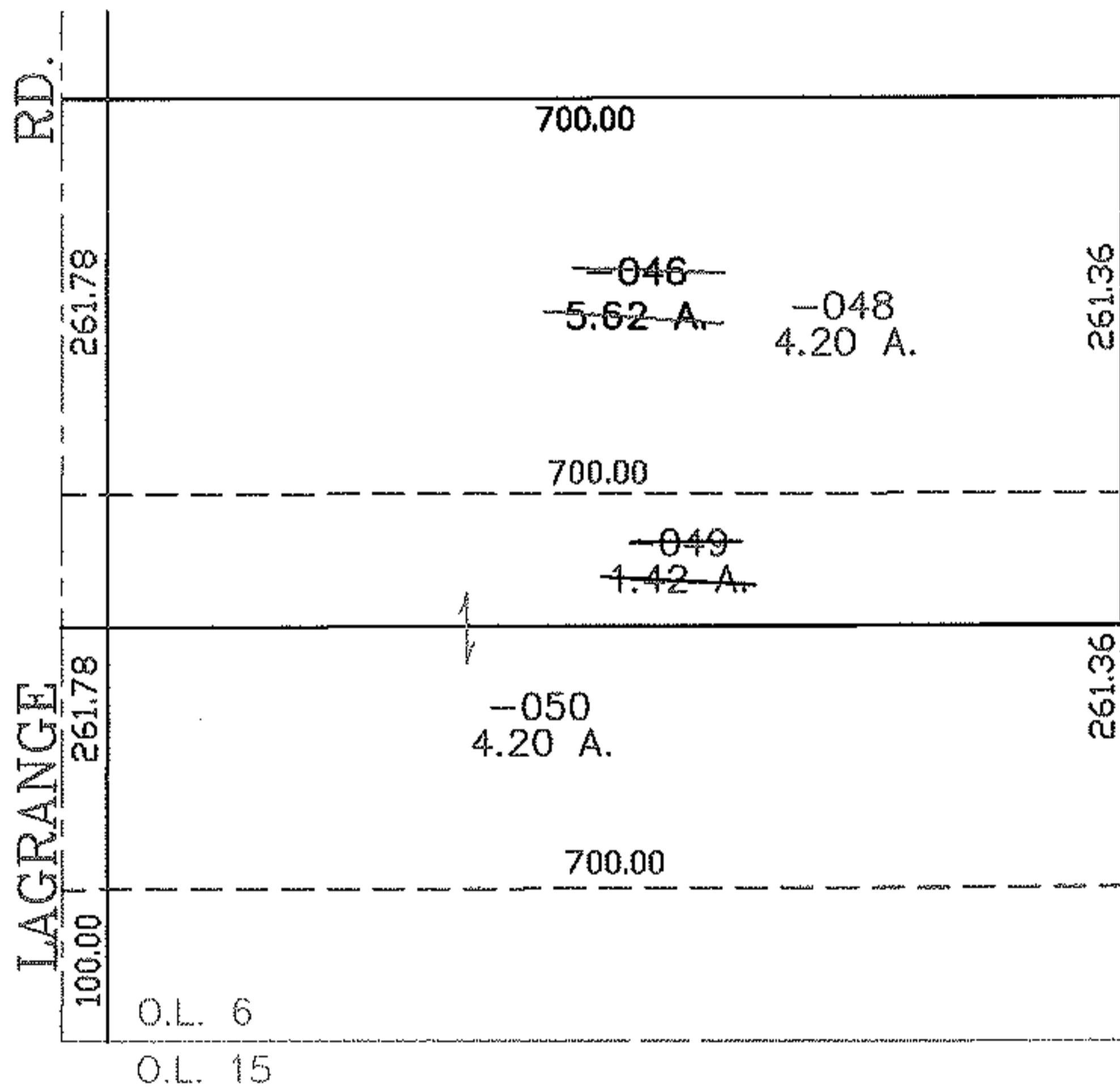
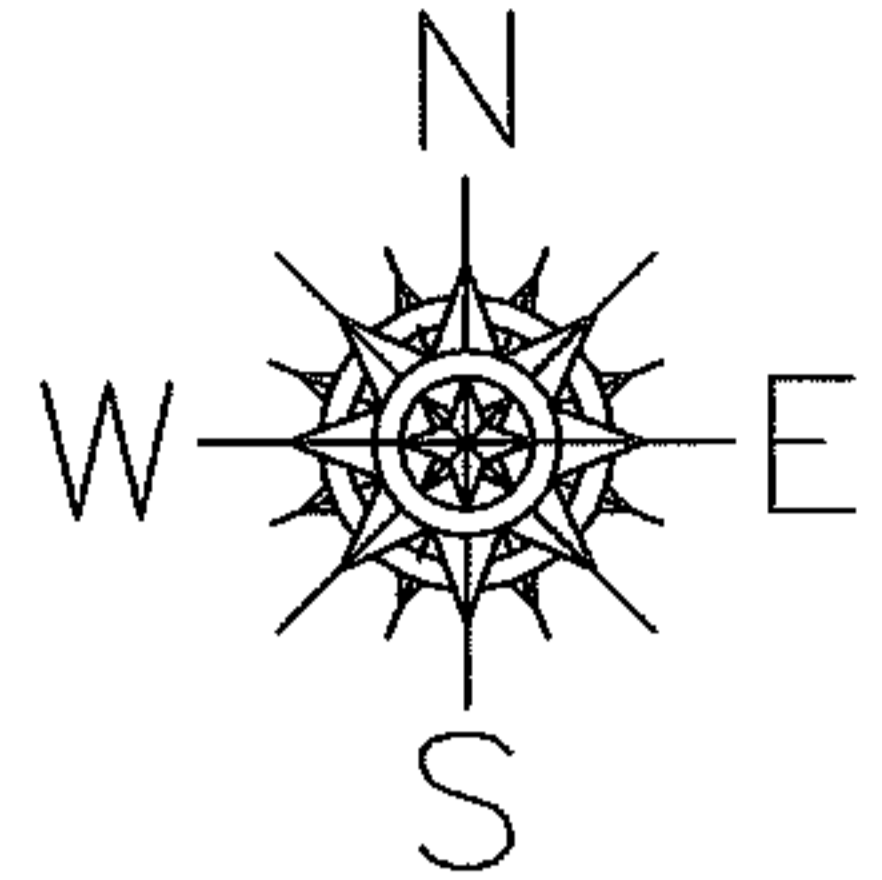

~~-047~~  
~~44.51 A.~~  
 -051  
 41.73 A.

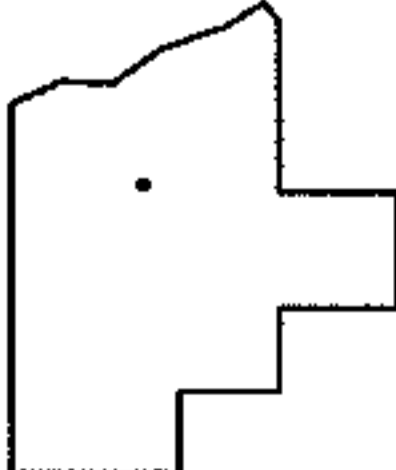

**SPLITS/DEEDS PROCESSED**  
 LORAIN COUNTY TAX MAP DEPARTMENT  
 226 MIDDLE AVE. ELYRIA, OHIO

SURVEYED BY: THOMAS J. NEFF  
 CLOSURE: 0.00 : 10,000  
 MAP PAGE(S): 15-00-006-A  
 APPROVED BY: JAH DATE: 3-15-04  
 SCALE: 1" = 200 PRIOR INSTRUMENT: 20030956326