

RASTER

PARENT PARCEL: 21-01-010-000-002

CHILD PARCEL: --SAME--

STARTING POINT: INTCL CLARK RD AND SOUTHERLY LINE OF O.L. 10

NO. 00958-A



AC. CORR.
PER SURVEY
THOMAS M. SNEZEK

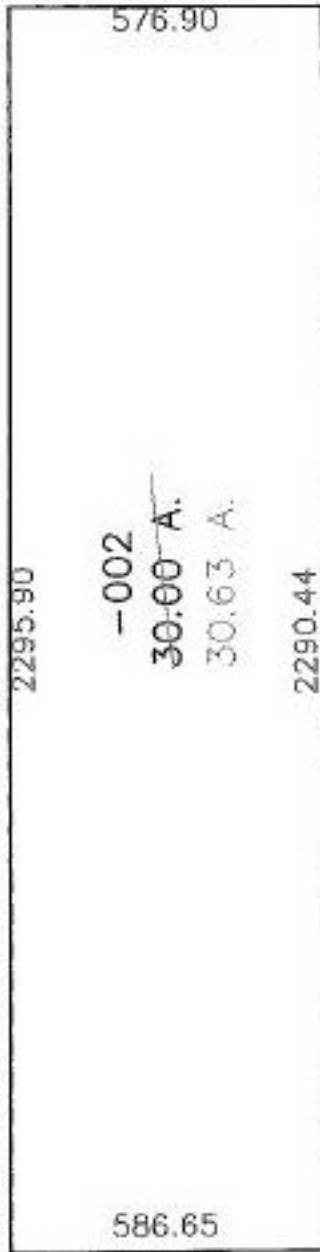

CLARK ROAD 60'

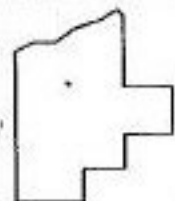

SPLITS/DEEDS PROCESSED
LORAIN COUNTY TAX MAP DEPARTMENT
226 MIDDLE AVE. ELYRIA, OHIO

SURVEYED BY: THOMAS SNEZEK
CLOSURE: 1:10,000
MAP PAGE(S): 21-01-010
APPROVED BY: DRH DATE: 1/9/2004
SCALE: 1" = 400' PRIOR INSTRUMENT: O.R. 386/165