

PARENT PARCEL: 09-00-074-101-044, -045

CHILD PARCEL: 09-00-074-101-058

STARTING POINT: INTERSECTION OF C/L OF PYLE SOUTH AMHERST RD. AND C/L OF W. LORAIN ST.

18-03878

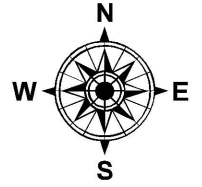

2679.94

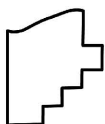
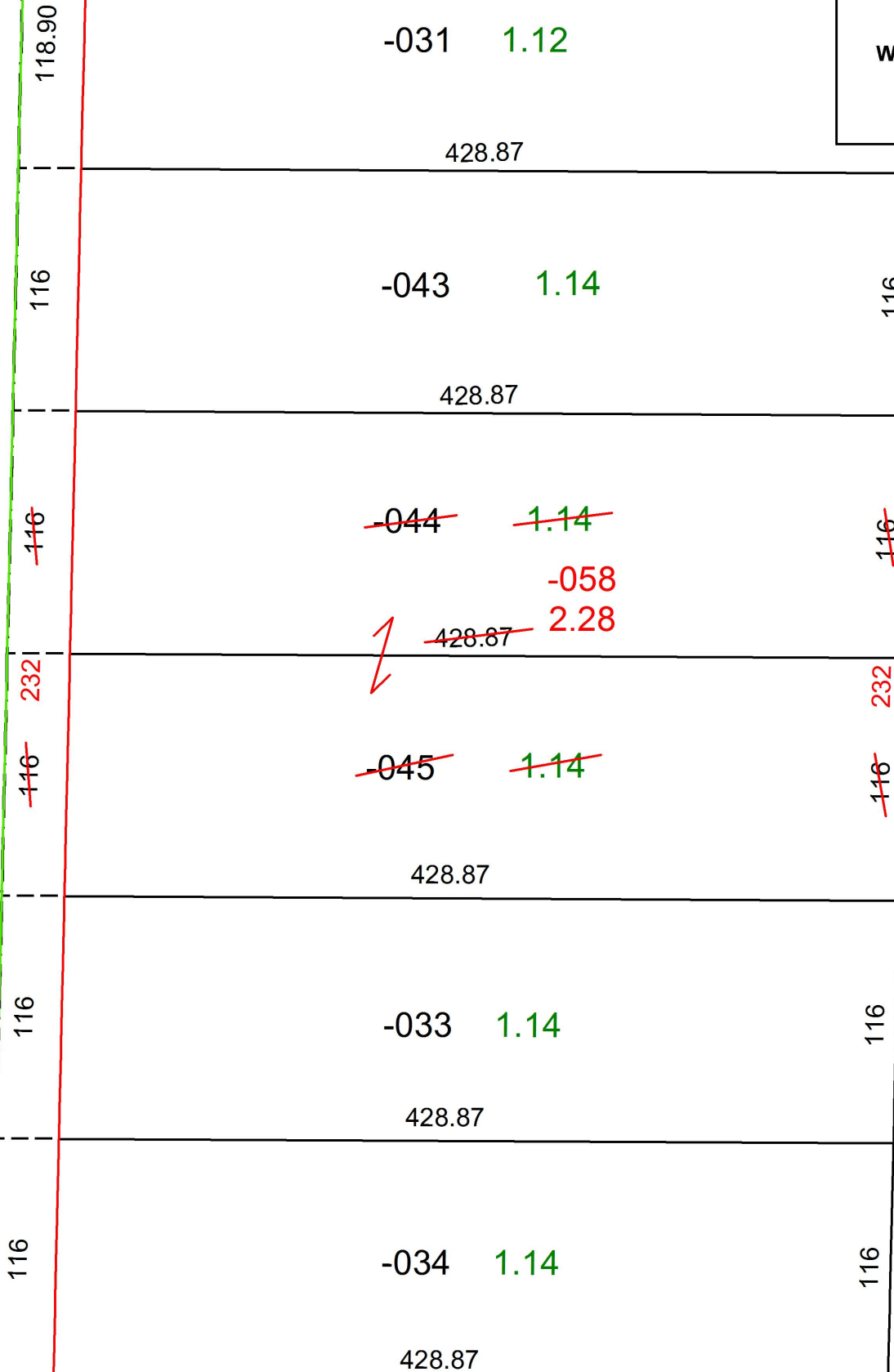

**SPLITS/DEEDS PROCESSED**  
LORAIN COUNTY TAX MAP DEPARTMENT  
226 MIDDLE AVE. ELYRIA, OH

SURVEYED BY: THOMAS A. SIMON

CLOSURE: 1: 2147483648

MAP PAGE(S): 9-00-074

APPROVED BY: RRM DATE: 9-25-18

SCALE: 1" = 75' PRIOR INSTRUMENT: 20150535523