

PARENT PARCEL: 15-00-016-000-009

CHILD PARCEL: 15-00-016-000-010,-011

STARTING POINT: AT A MON BOX AT THE INTERSECTION OF C/L OF S.R.301 AND NORTH LINE OF O.L.16

15-03445

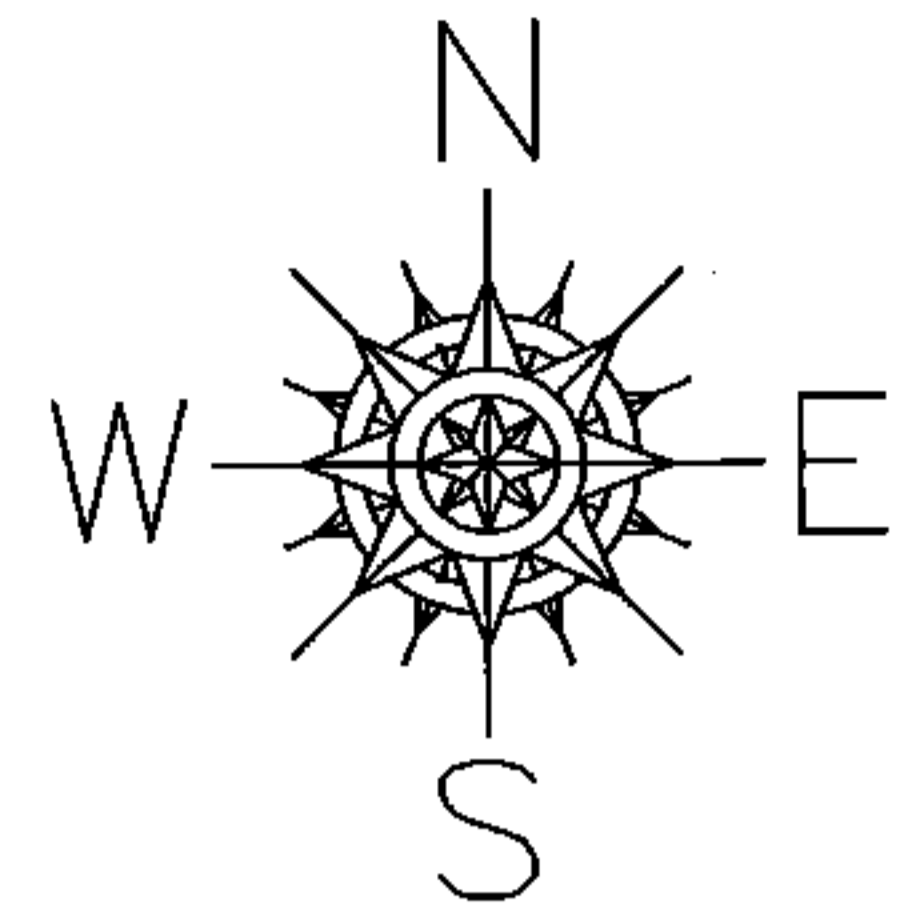

O.L.5  
O.L.16

831.70

LATTASBURGH - ELYRIA RD. (S.R.301)

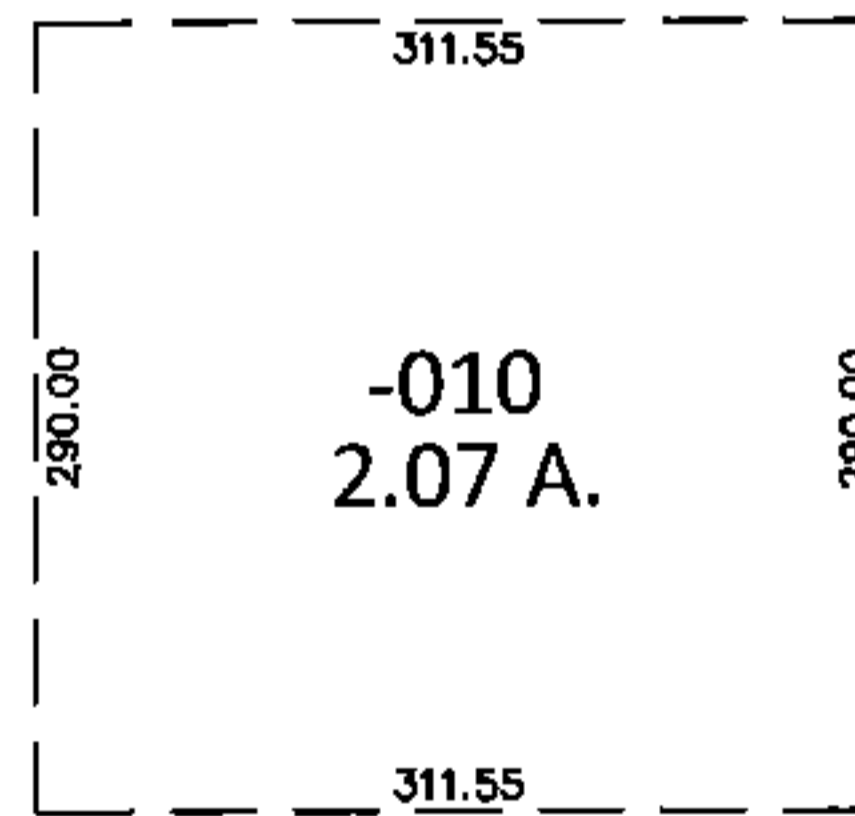

~~-009~~  
~~102.12 A.~~

-011  
100.05 A.

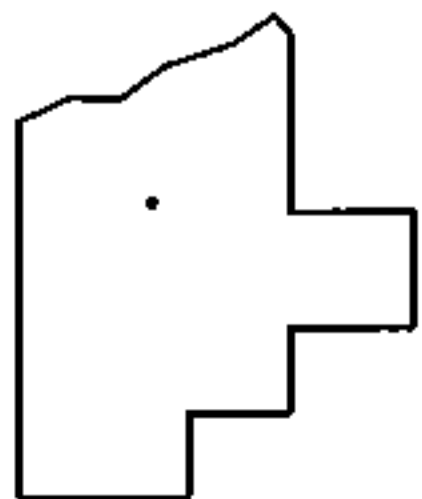

**SPLITS/DEEDS PROCESSED**

LORAIN COUNTY TAX MAP DEPARTMENT  
226 MIDDLE AVE. ELYRIA, OHIO

SURVEYED BY: RICHARD D. CARLSON

CLOSURE: .00:10.000

MAP PAGE(S): 15-B

APPROVED BY: RRM DATE: 11-23-15

SCALE: 1" = 200 PRIOR INST.: 20140512033