

PARENT PARCEL: 06-25-163-000-025, -026

CHILD PARCEL: \_\_\_\_\_

STARTING POINT: AT A MON BOX AT THE SOUTHEAST CORNER OF O.L.163

16-03363-C

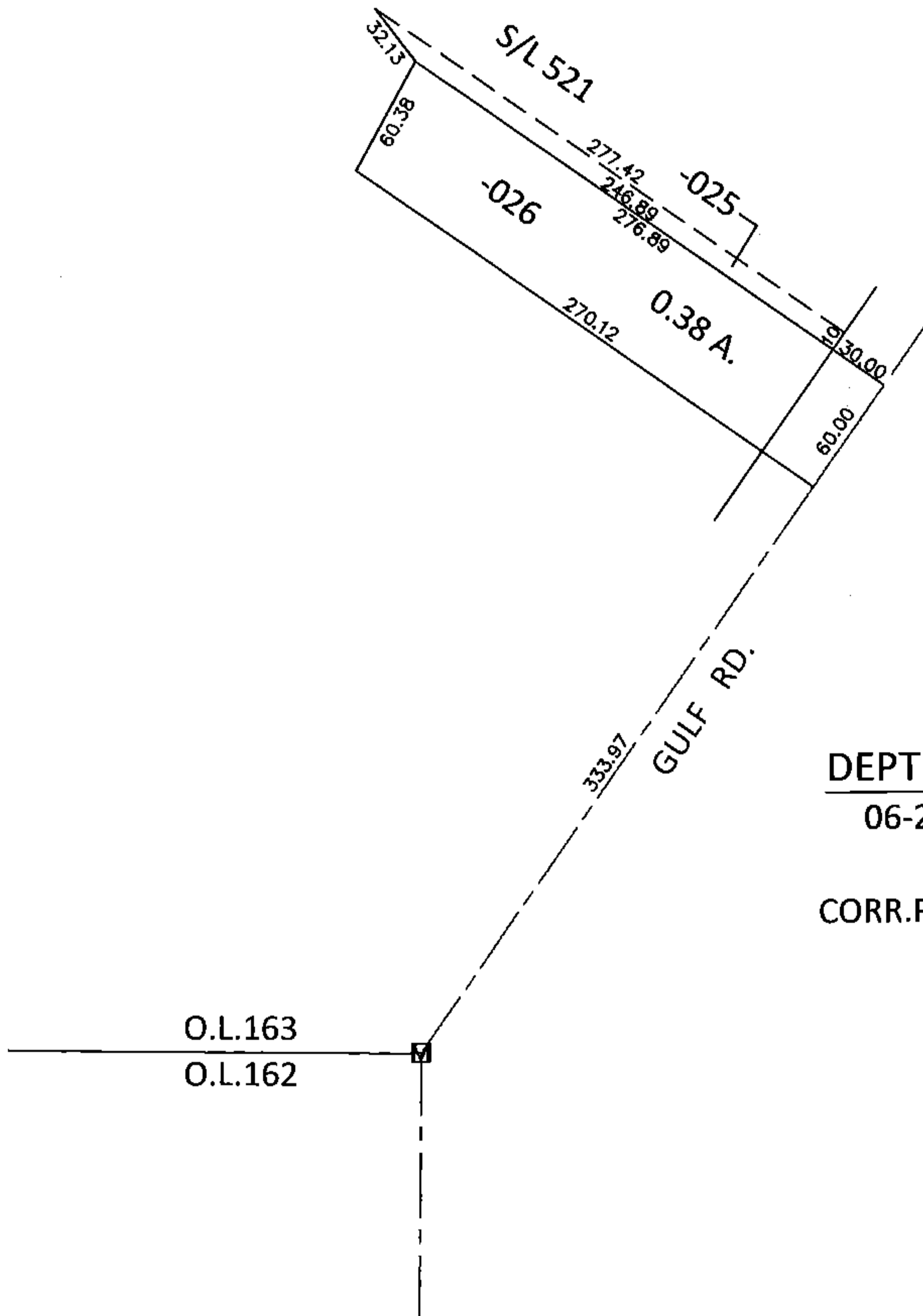
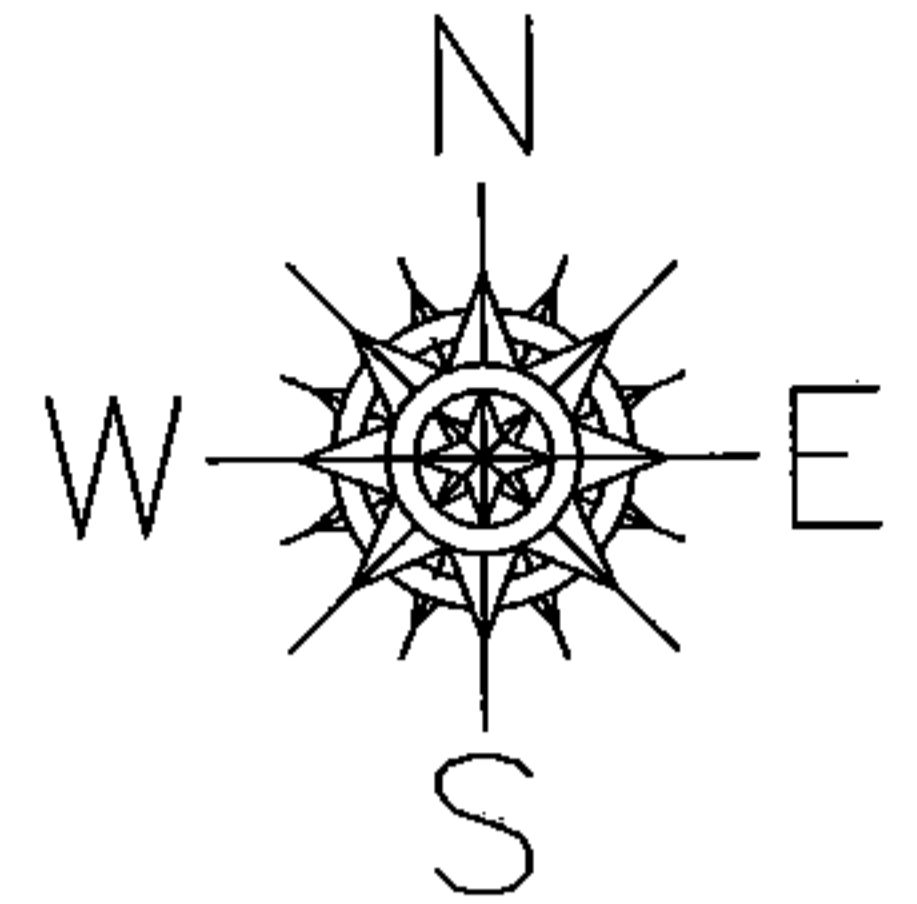

**DEPTH CORRECTION**

06-25-163-000-025

277.42

10 X ~~387~~

CORR.PER.SURV. T.SIMON

O.L.163

O.L.162

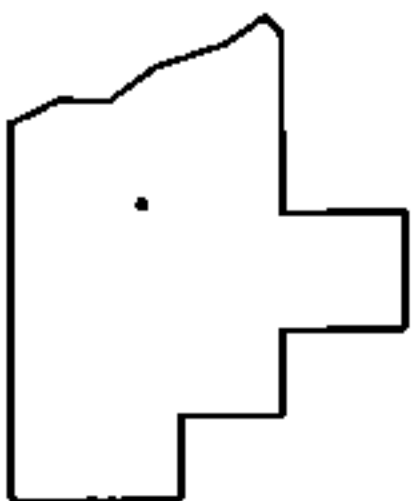

**SPLITS/DEEDS PROCESSED**

LORAIN COUNTY TAX MAP DEPARTMENT  
226 MIDDLE AVE. ELYRIA, OHIO

SURVEYED BY: THOMAS A. SIMON

CLOSURE: .01:10,000

MAP PAGE(S): 6-68

APPROVED BY: RRM DATE: 1-19-16

SCALE: 1"= 100 PRIOR INST.: 20120427986