

PARENT PARCEL: 04-00-007-108-006, -008

CHILD PARCEL: 04-00-007-108-017

STARTING POINT: AT A MON BOX AT THE INTERSECTION OF C/L OF MOOREWOOD AVE. AND C/L OF ELECTRIC BLVD.

15-03352-X

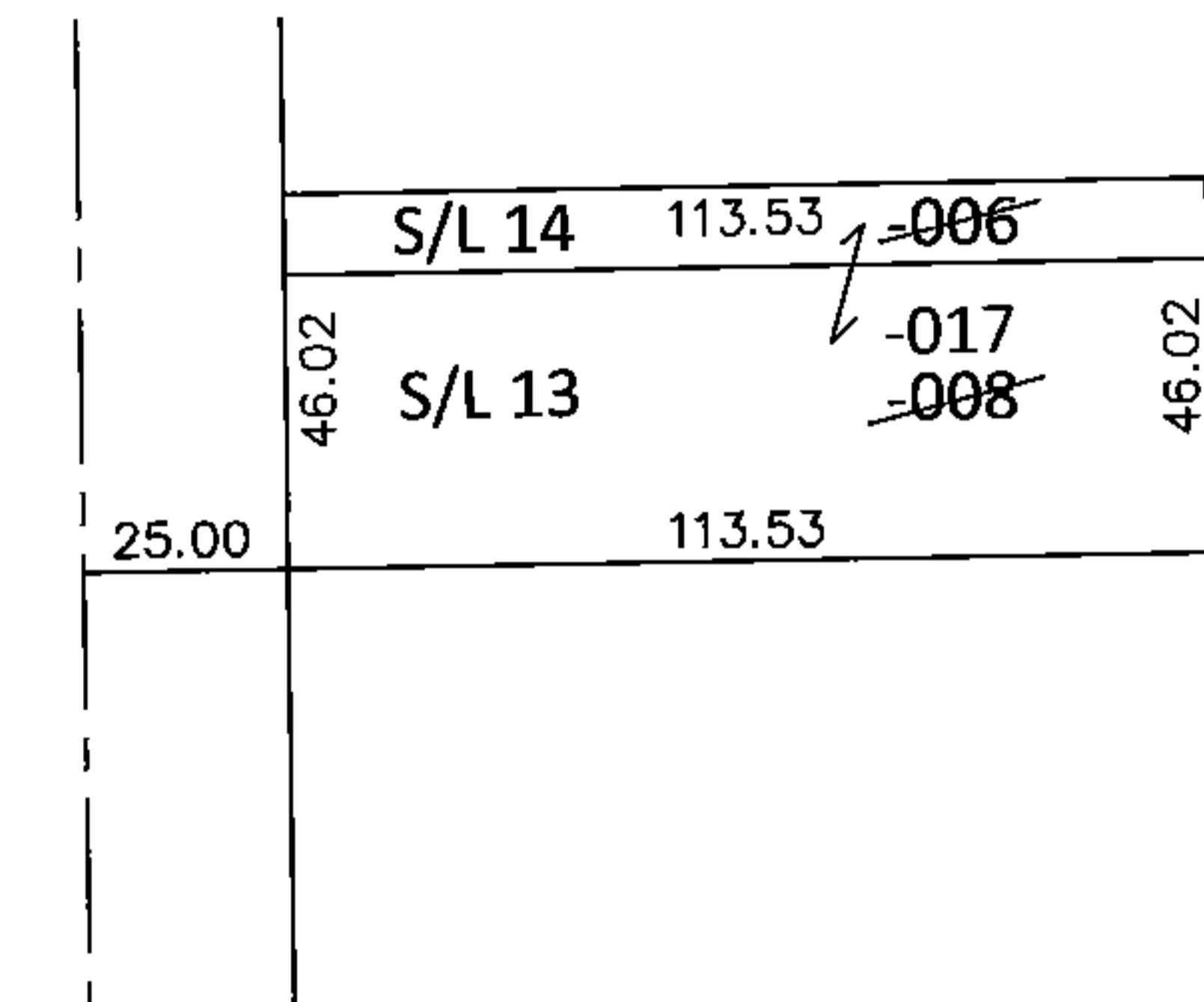
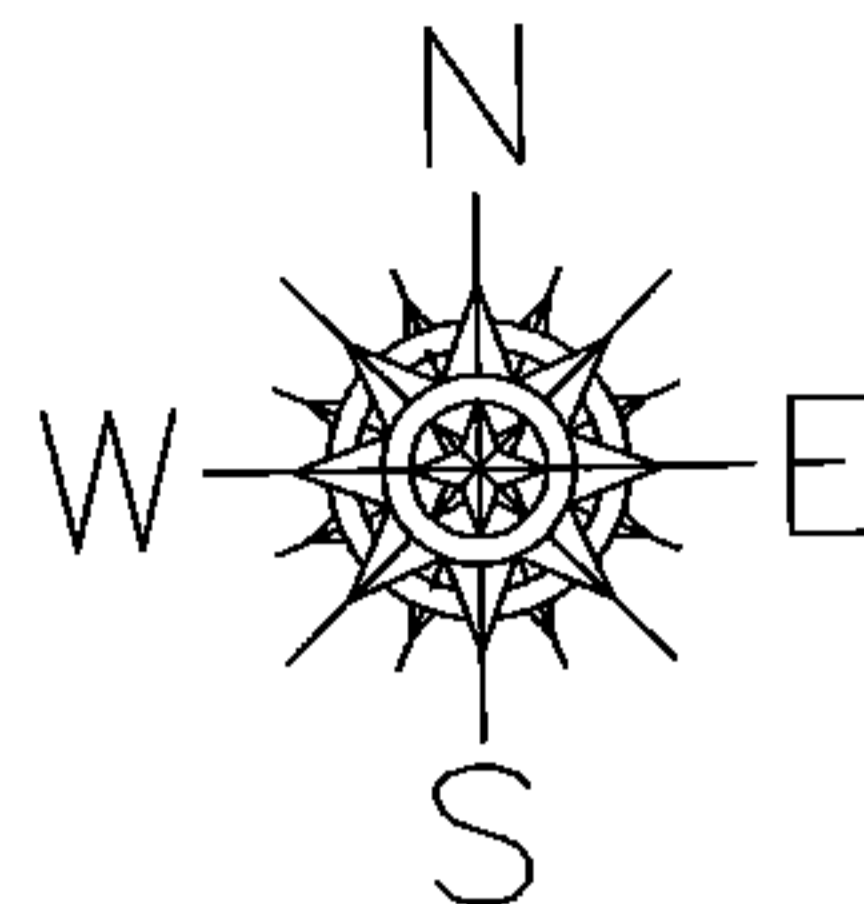

MOOREWOOD AVE.
262.18

COMBINATION

~~04-00-007-108-006~~ ~~04-00-007-108-008~~
~~10 X 113~~ ~~36.17 X 114~~

04-00-007-108-017
46.02 X 113.53

ELECTRIC BLVD.

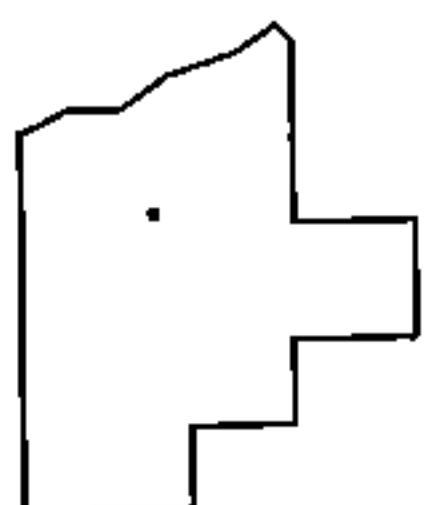

SPLITS/DEEDS PROCESSED

LORAIN COUNTY TAX MAP DEPARTMENT
226 MIDDLE AVE. ELYRIA, OHIO

SURVEYED BY: JAMES A. RESAR

CLOSURE: .00:10,000

MAP PAGE(S): 4-00-007-D

APPROVED BY: RRM DATE: 1-4-16

SCALE: 1"= 50' PRIOR INST.: 20070197683