

PARENT PARCEL: 09-00-097-000-020

CHILD PARCEL: _____

STARTING POINT: INTERSECTION OF C/L OF PARSONS RD. AND WEST LINE OF O.L.97

15-03350-X

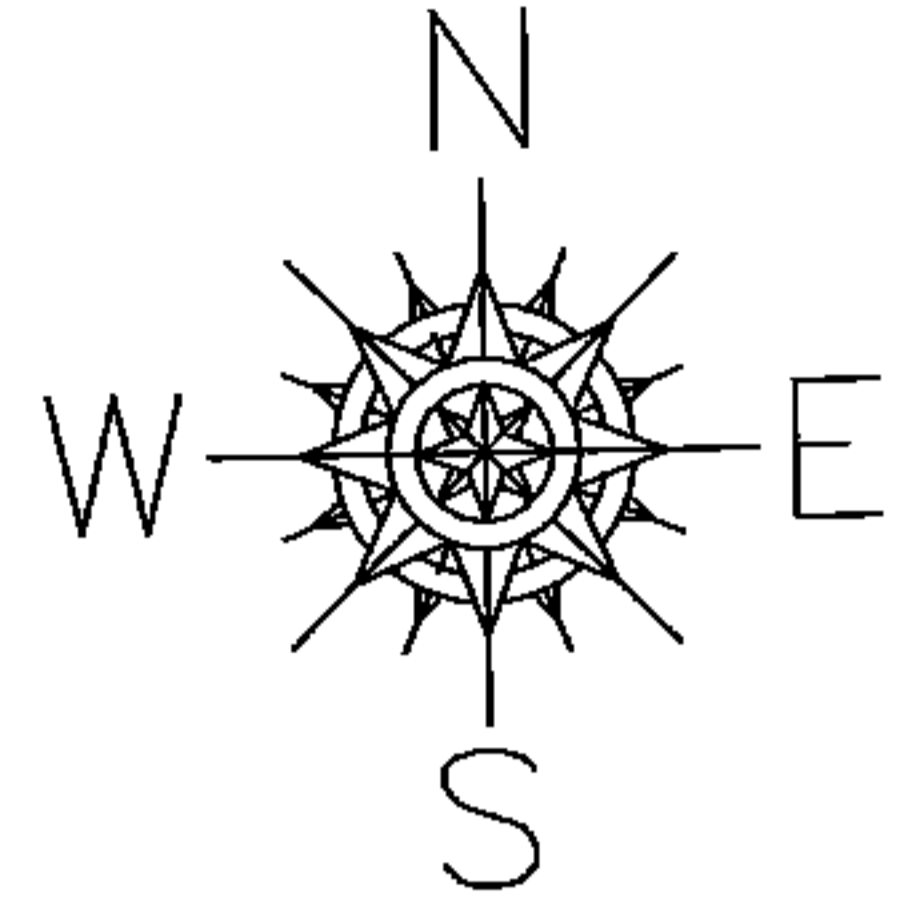

MAP CORRECTION ONLY

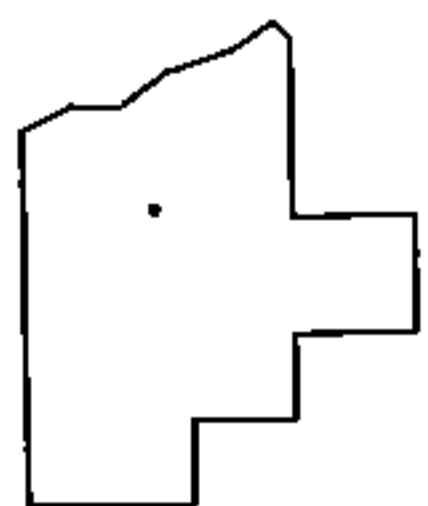
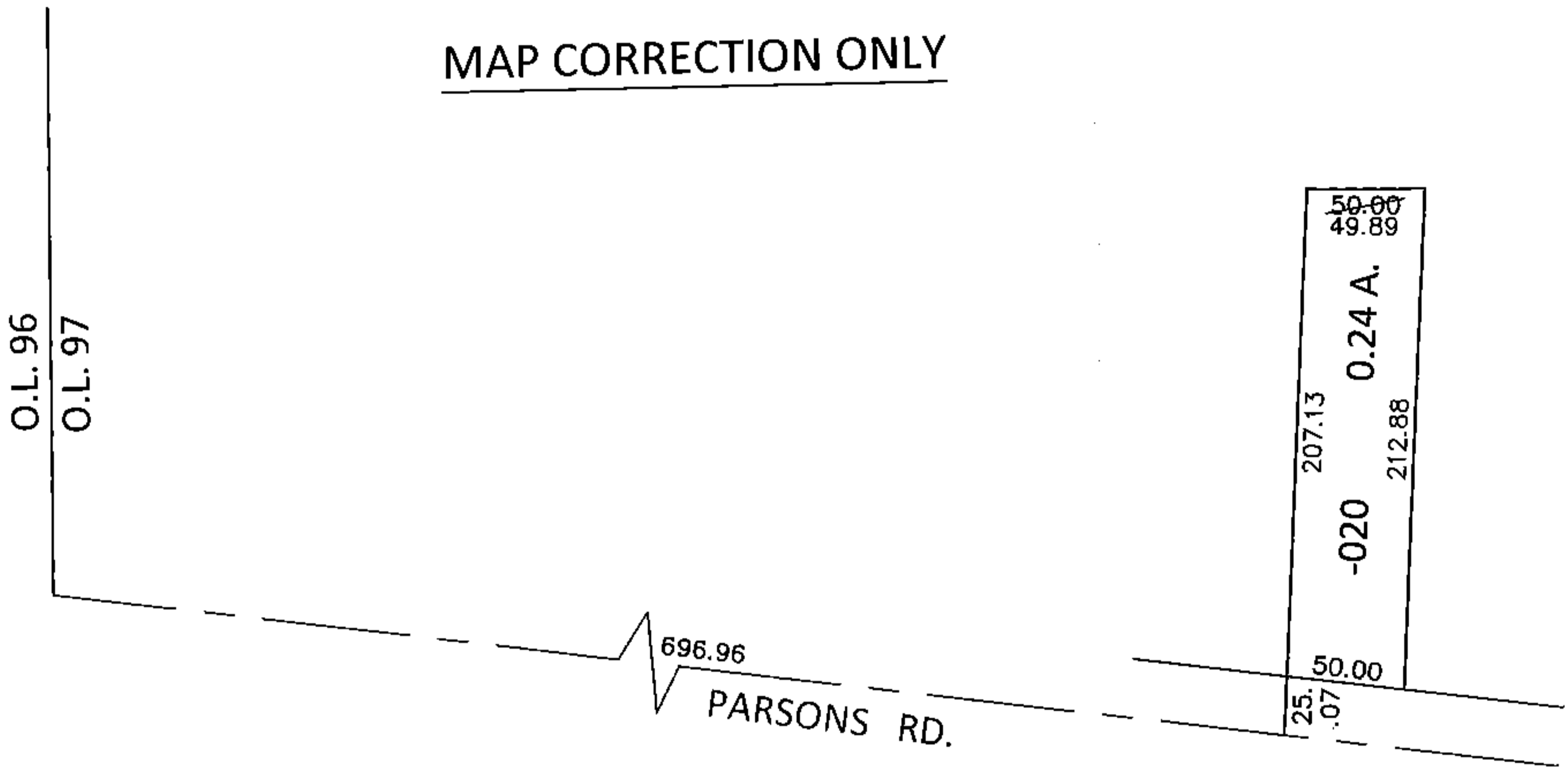

SPLITS/DEEDS PROCESSED

LORAIN COUNTY TAX MAP DEPARTMENT
226 MIDDLE AVE. ELYRIA, OHIO

SURVEYED BY: AMY M. KELLY

CLOSURE: .01:10,000

MAP PAGE(S): 9-00-097-A

APPROVED BY: RRM DATE: 12-28-15

SCALE: 1"= 100 PRIOR INST.: 20150557493