

PARENT PARCEL: 06-26-094-104-012

CHILD PARCEL: \_\_\_\_\_

STARTING POINT: \_\_\_\_\_

15-03321-C

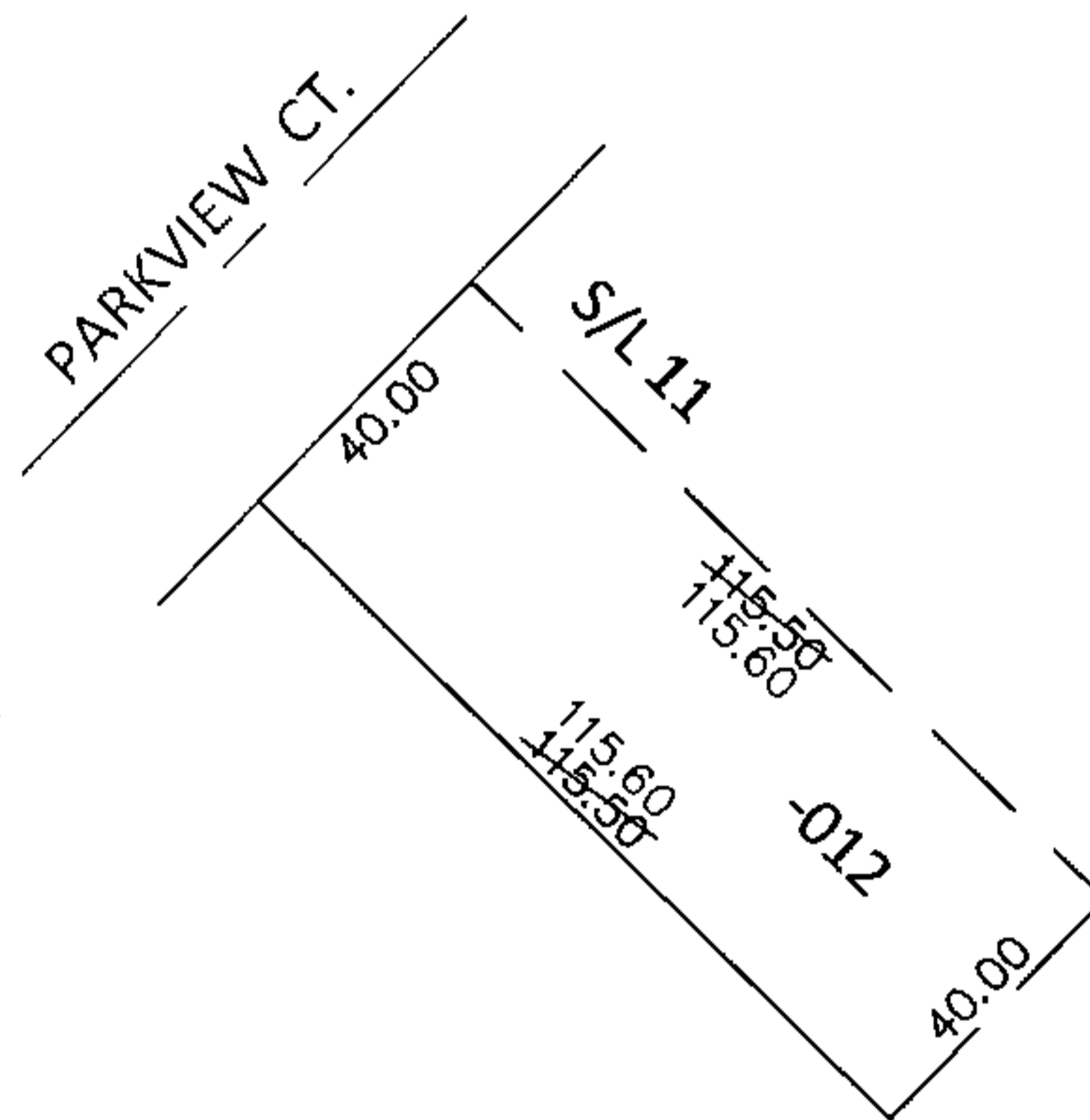
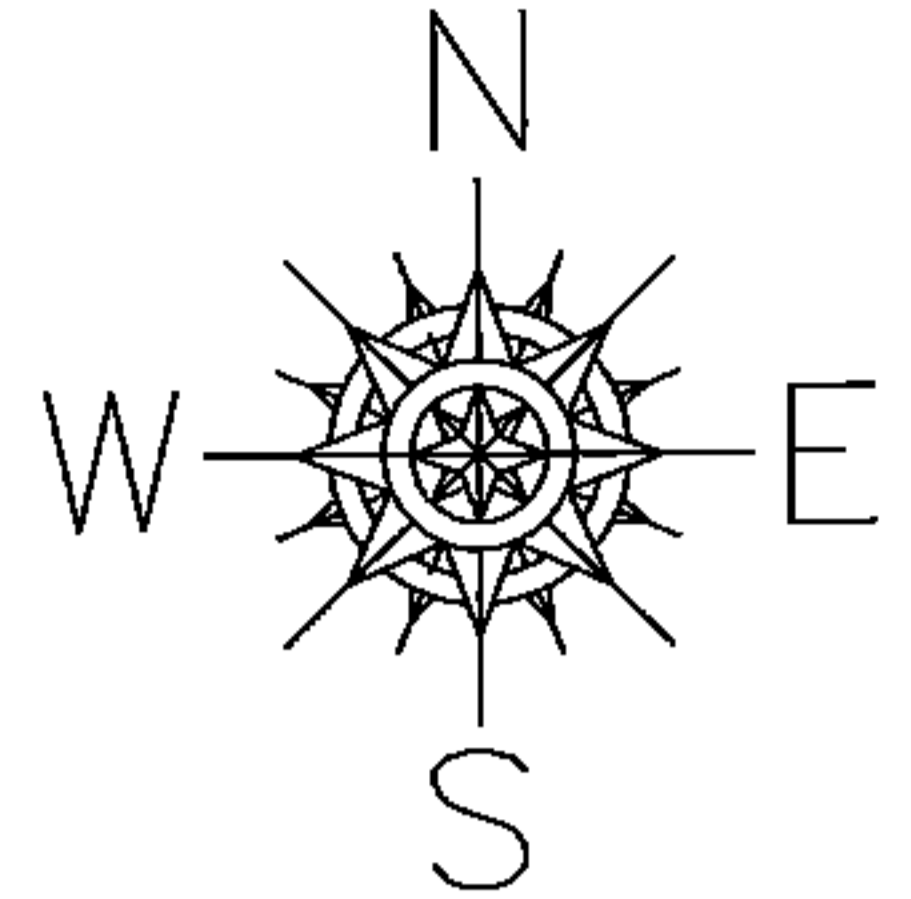

**DEPTH CORRECTION**

06-26-094-104-012  
 115.60  
 40 X ~~115.50~~  
 PER PRIOR DEEDS

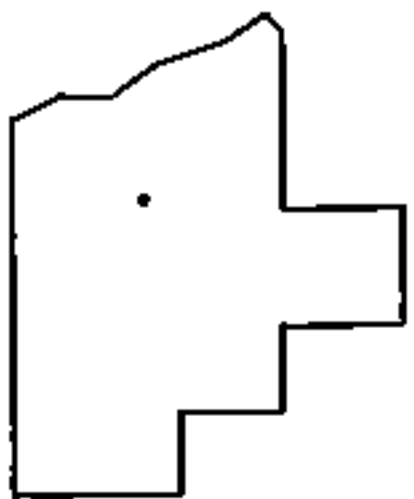

**SPLITS/DEEDS PROCESSED**

LORAIN COUNTY TAX MAP DEPARTMENT  
 226 MIDDLE AVE. ELYRIA, OHIO

SURVEYED BY: N/A

CLOSURE: N/A

MAP PAGE(S): 6-101

APPROVED BY: RRM DATE: 10-23-15

SCALE: 1" = 50' PRIOR INST.: 20100332150