

PARENT PARCEL: 06-25-003-103-042

CHILD PARCEL: \_\_\_\_\_

STARTING POINT: INTERSECTION OF C/L OF MICHIGAN AVE. AND C/L OF PARK AVE.

15-03271-D

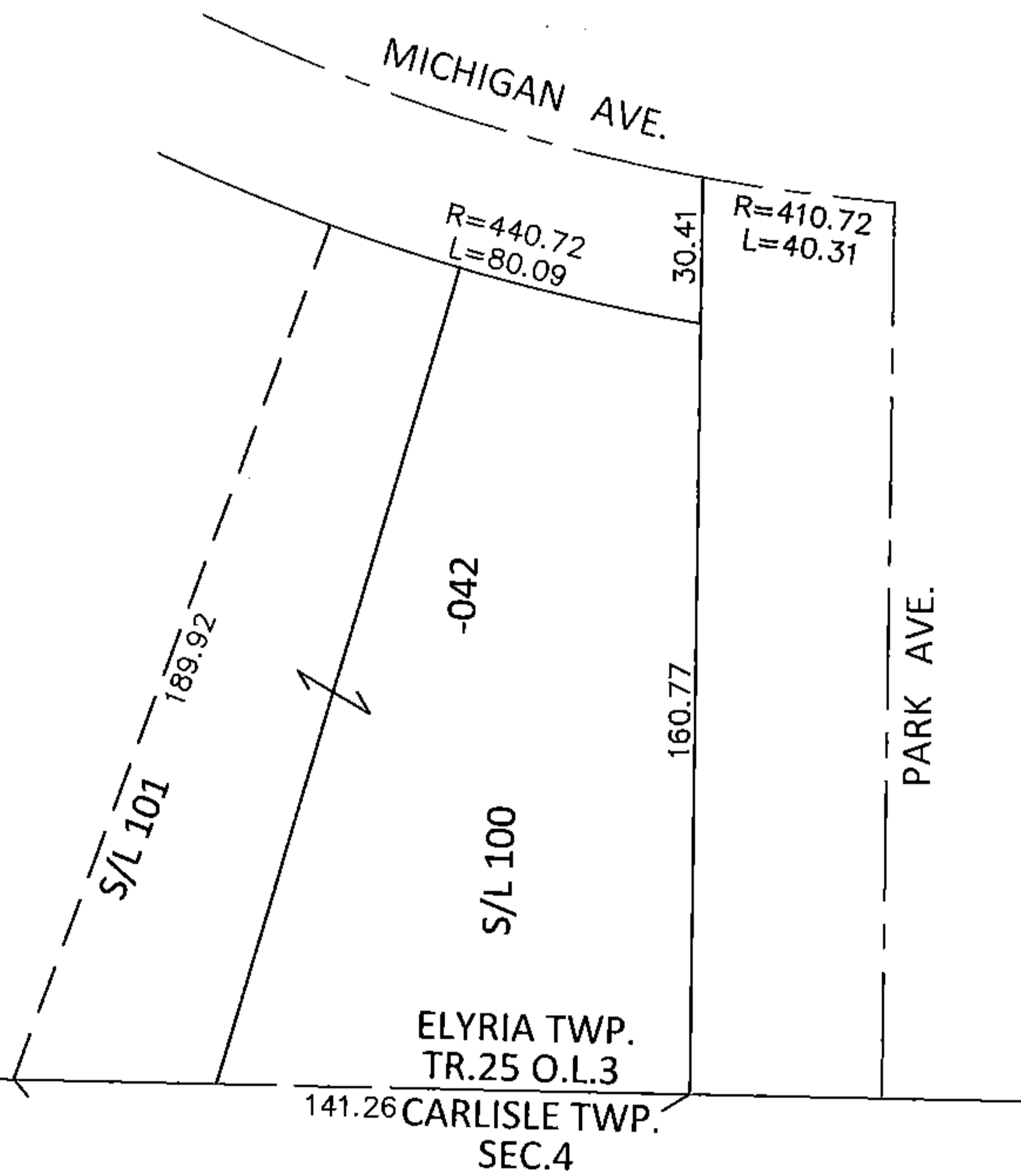
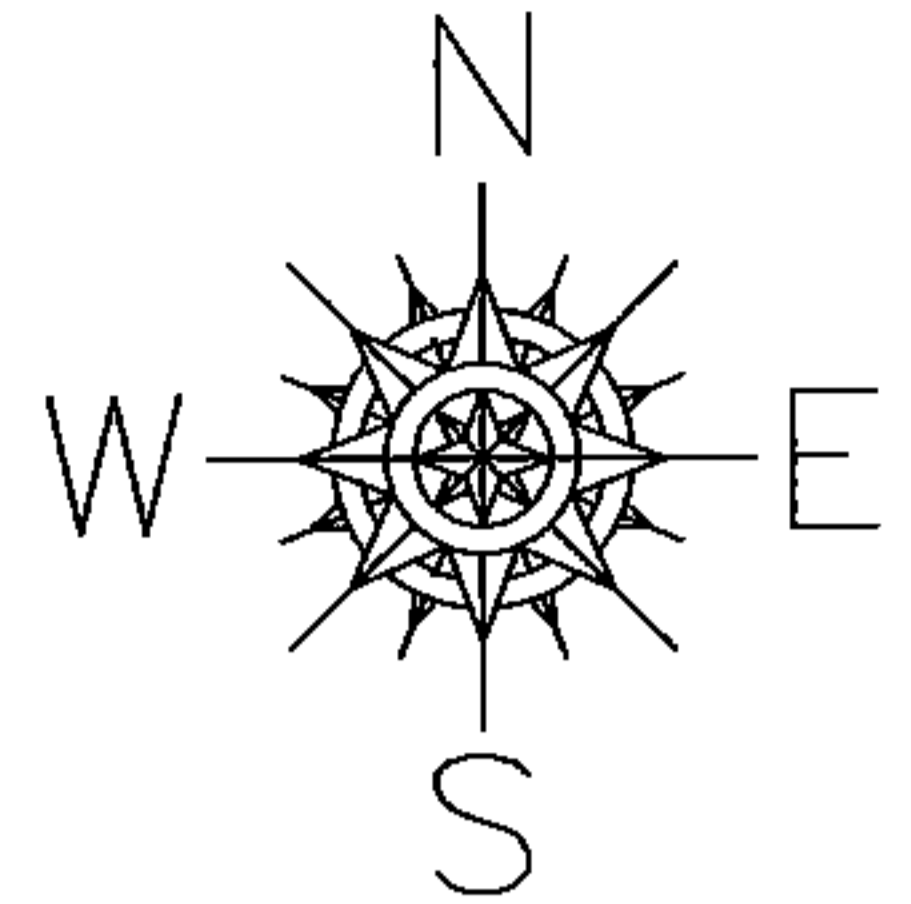

**FRONTAGE & DEPTH CORRECTION**

06-25-003-103-042  
 80.09 X 189.92  
~~79.72 X 202~~  
 PER SURVEY BY T.SIMON

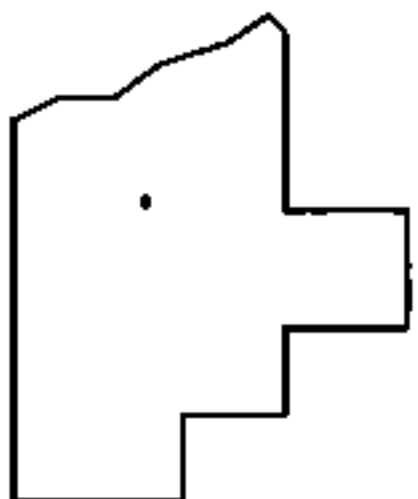

**SPLITS/DEEDS PROCESSED**

LORAIN COUNTY TAX MAP DEPARTMENT  
 226 MIDDLE AVE. ELYRIA, OHIO

SURVEYED BY: THOMAS A. SIMON  
 CLOSURE: .01:10,000  
 MAP PAGE(S): 6-139  
 APPROVED BY: RRM DATE: 8-6-15  
 SCALE: 1"= 50' PRIOR INST.: 20150552834