

PARENT PARCEL: 20-05-023-107-006
 CHILD PARCEL: 20-05-023-107-006, -007
 STARTING POINT: NORTHWEST CORNER OF S/L 18 IN GORE, BARNS & BANNING BLOCK (VOL.1 PG.8)

15-03222-C

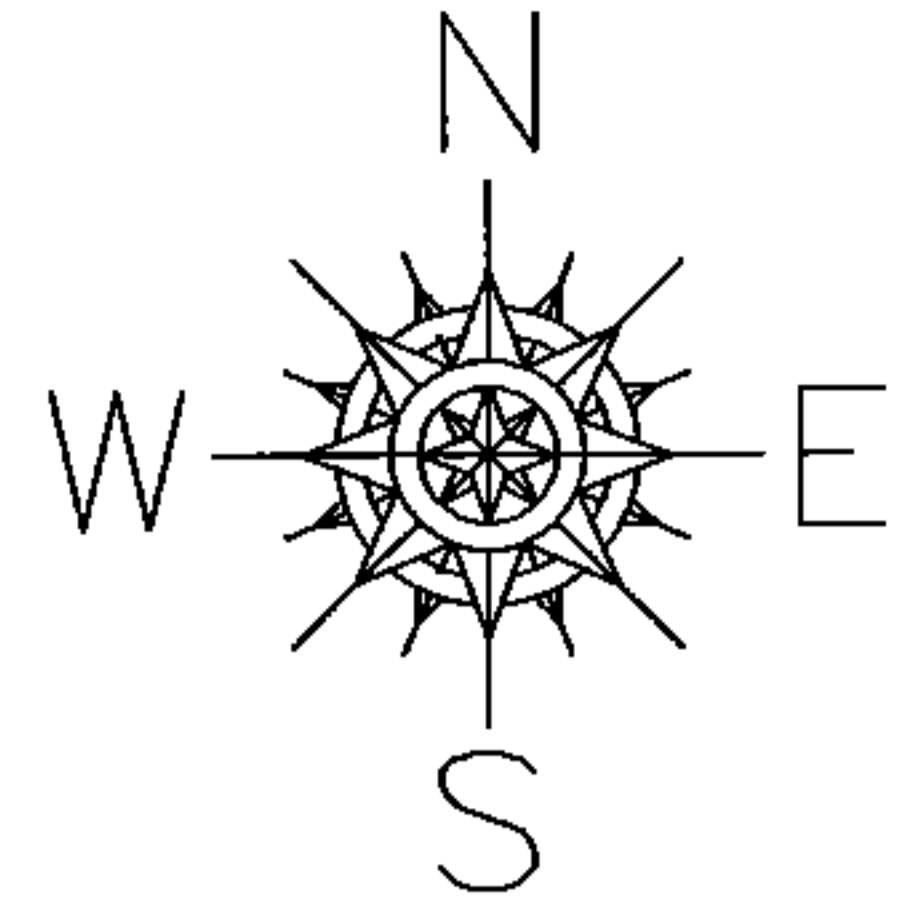

ADD TO DUPLICATE
 20-05-023-107-007
 83 X 145.50
 IN THE NAME OF
 JOHN H. & VIOLA HODGKIN
 PER DEED VOLUME 466/481

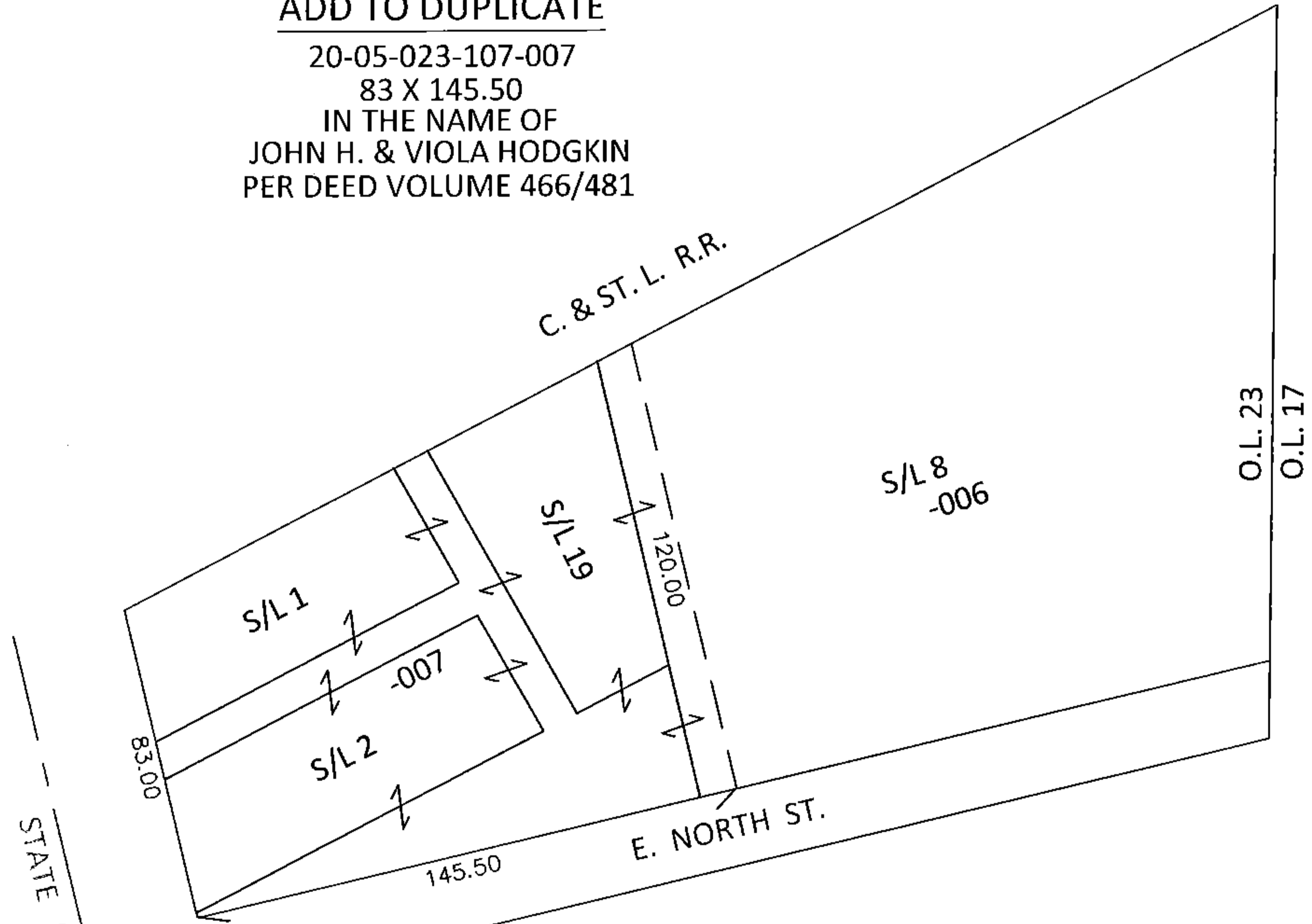

FRONTAGE AND DEPTH CORRECTION

20-05-023-107-006
 141.62 X 120
~~83 X 290~~
 PER PRIOR DEEDS
 19970482679
 20070217875

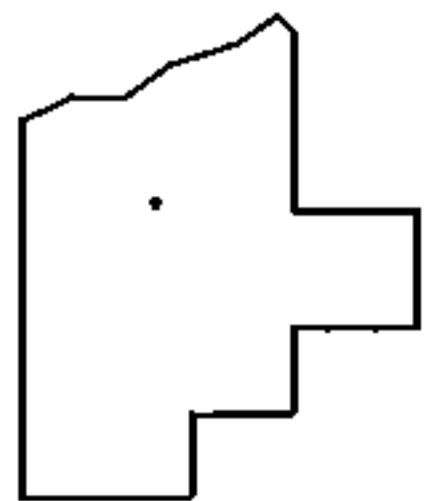

SPLITS/DEEDS PROCESSED
 LORAIN COUNTY TAX MAP DEPARTMENT
 226 MIDDLE AVE. ELYRIA, OHIO

SURVEYED BY: N/A
 CLOSURE: N/A
 MAP PAGE(S): 20-05-023-B
 APPROVED BY: RRM DATE: 5-21-15
 SCALE: 1"= 50' PRIOR INST.: SEE ABOVE