

PARENT PARCEL: 05-00-095-000-006

CHILD PARCEL: _____

STARTING POINT: INTERSECTION OF C/L OF RICE RD. AND C/L OF QUARRY RD.

15-03182-D

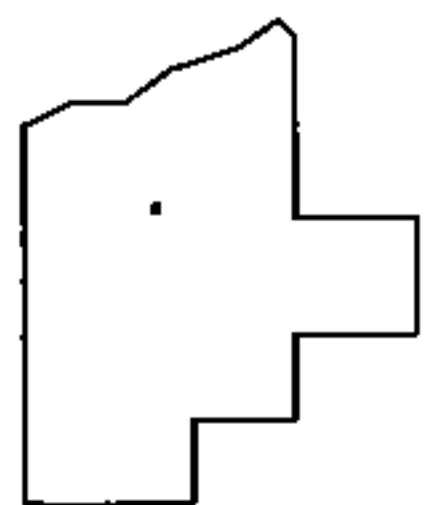
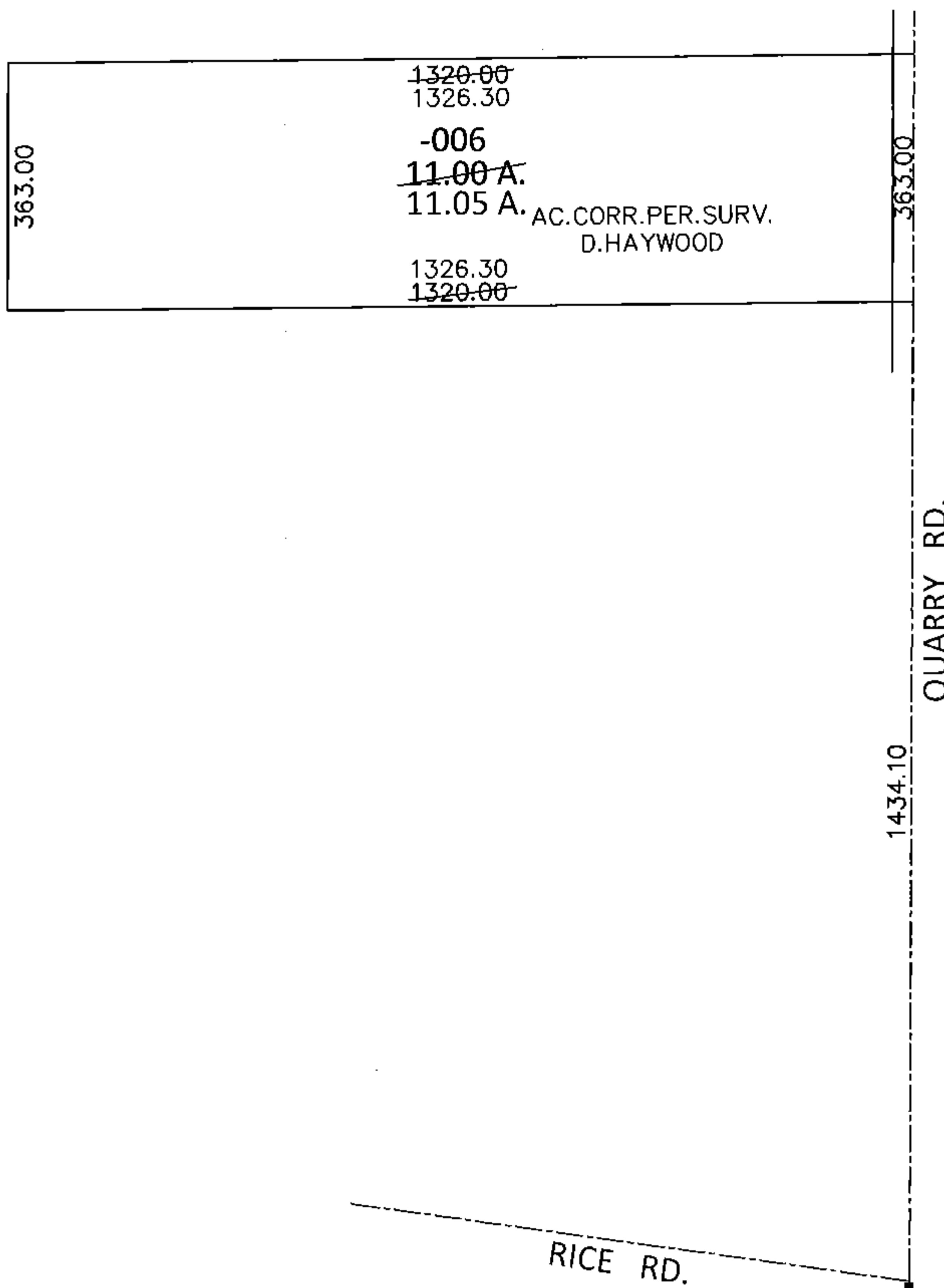
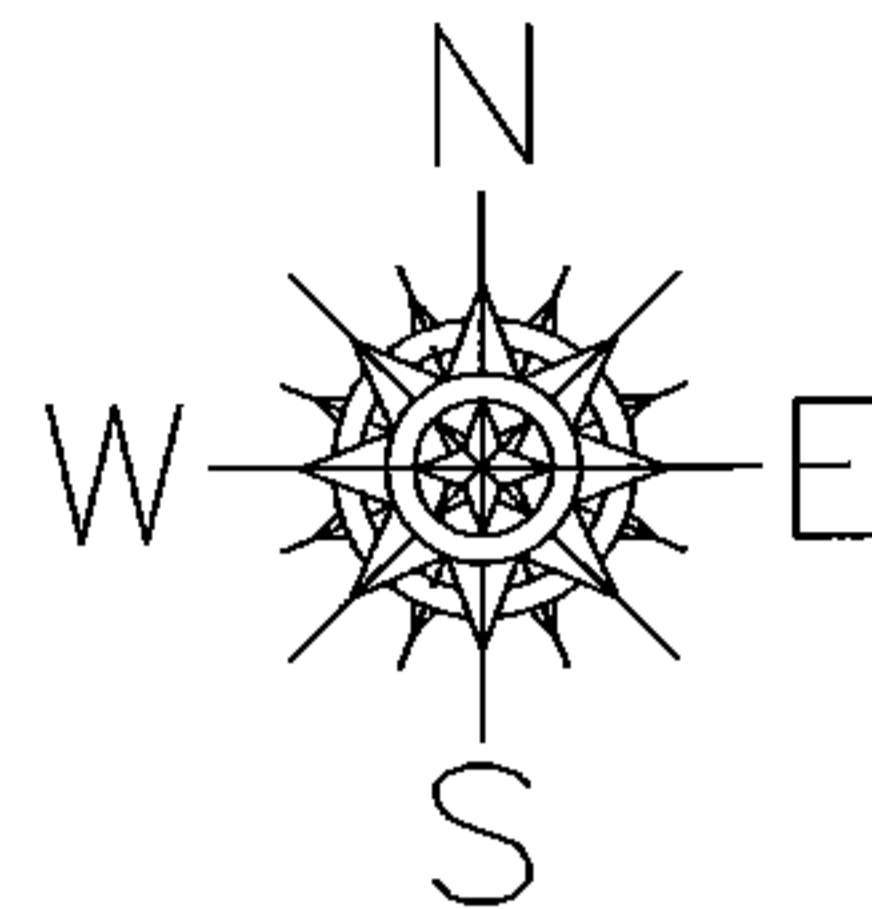

SPLITS/DEEDS PROCESSED

LORAIN COUNTY TAX MAP DEPARTMENT
226 MIDDLE AVE. ELYRIA, OHIO

SURVEYED BY: DALE R. HAYWOOD
 CLOSURE: .00:10,000
 MAP PAGE(S): 5-00-095-B
 APPROVED BY: RRM DATE: 5-7-15
 SCALE: 1" = 300 PRIOR INST.: 20090300138