

PARENT PARCEL: 10-00-023-102-024

CHILD PARCEL: 10-00-023-102-060, -061

STARTING POINT: CENTERLINE OF BANKS RD & O.L. 23

13-03172

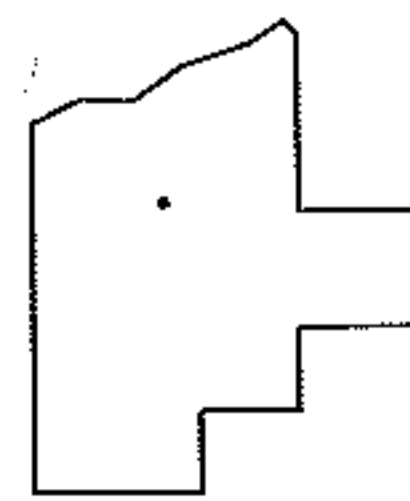
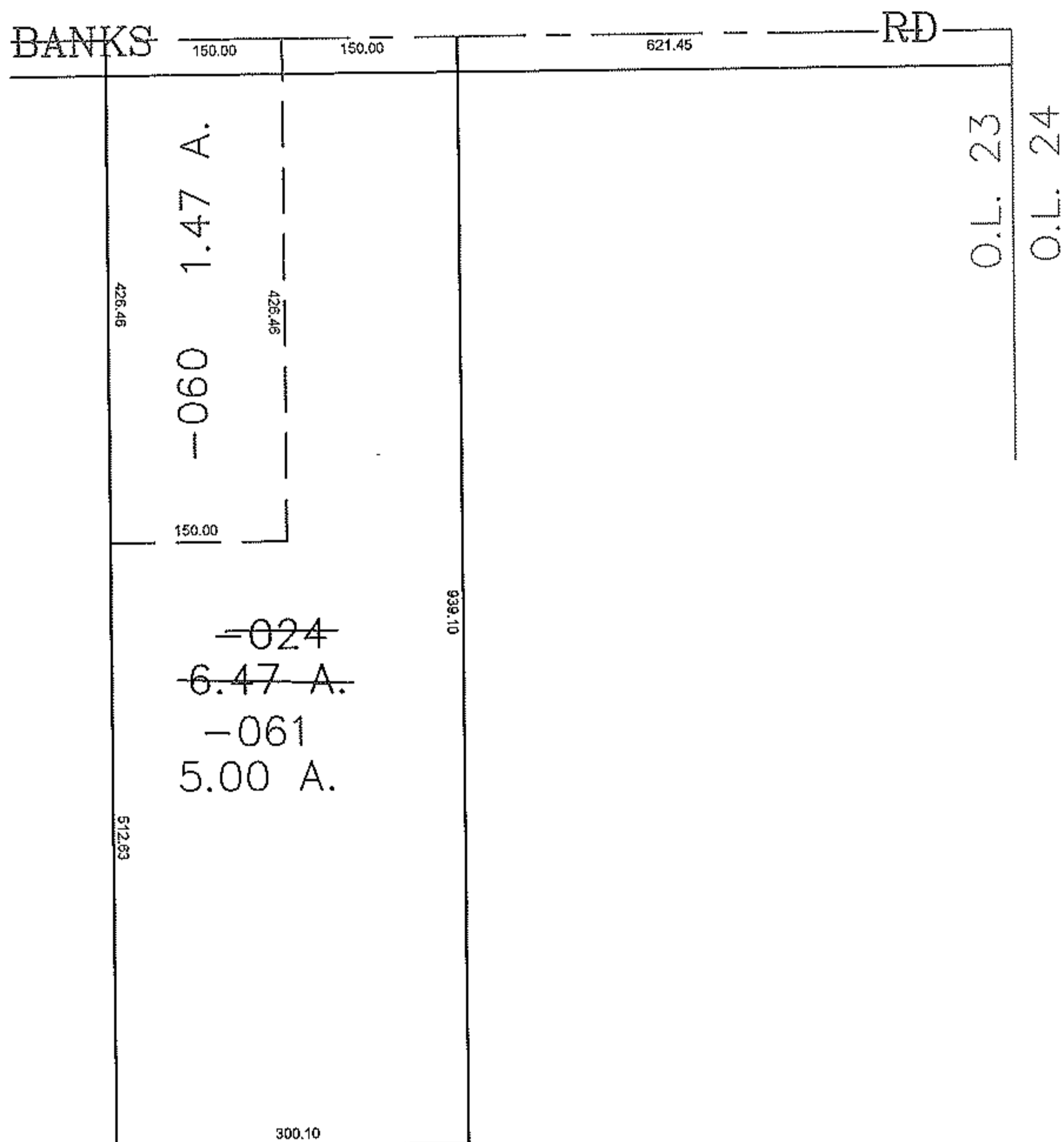
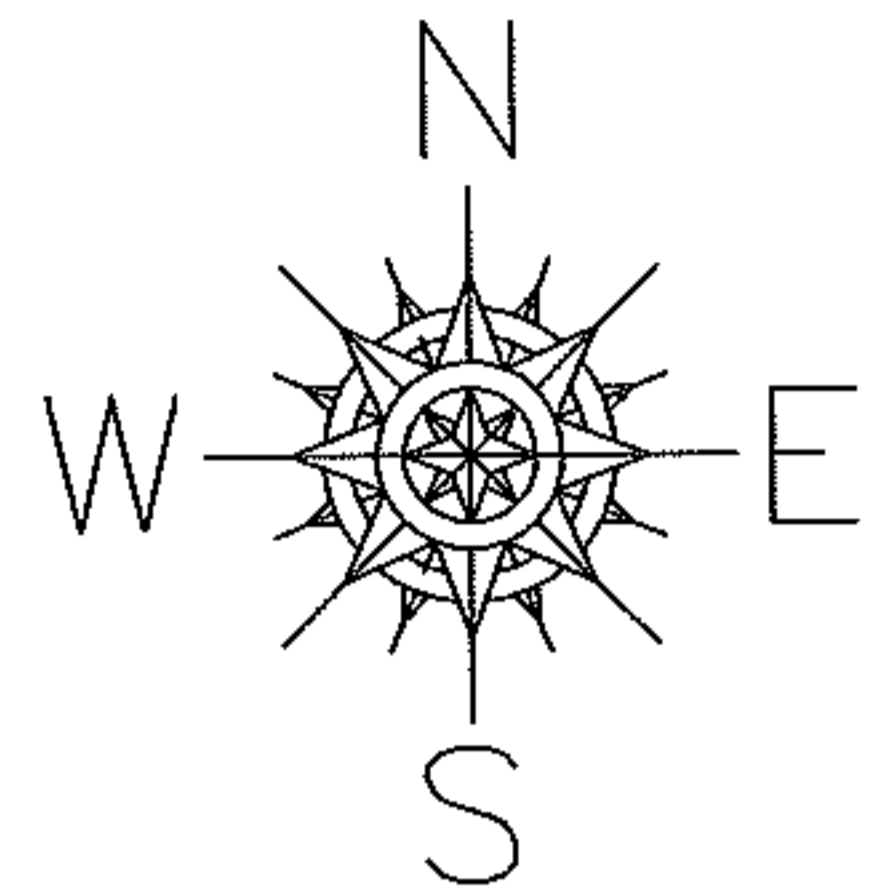

SPLITS/DEEDS PROCESSED
 LORAIN COUNTY TAX MAP DEPARTMENT
 226 MIDDLE AVE. ELYRIA, OHIO

SURVEYED BY: THOMAS SIMON
 CLOSURE: 0.00 : 10.000
 MAP PAGE(S): 10-G
 APPROVED BY: JAH DATE: 7/29/2013
 SCALE: 1" = 200 PRIOR INSTRUMENT: 20130455360