

PARENT PARCEL: 06-25-131-000-004

CHILD PARCEL: 06-25-131-000-005, -006

15-03137-X

STARTING POINT: INTERSECTION OF WEST LINE OF WASHINGTON AVE. AND NORTH LINE EXTENDED OF OHIO ST.

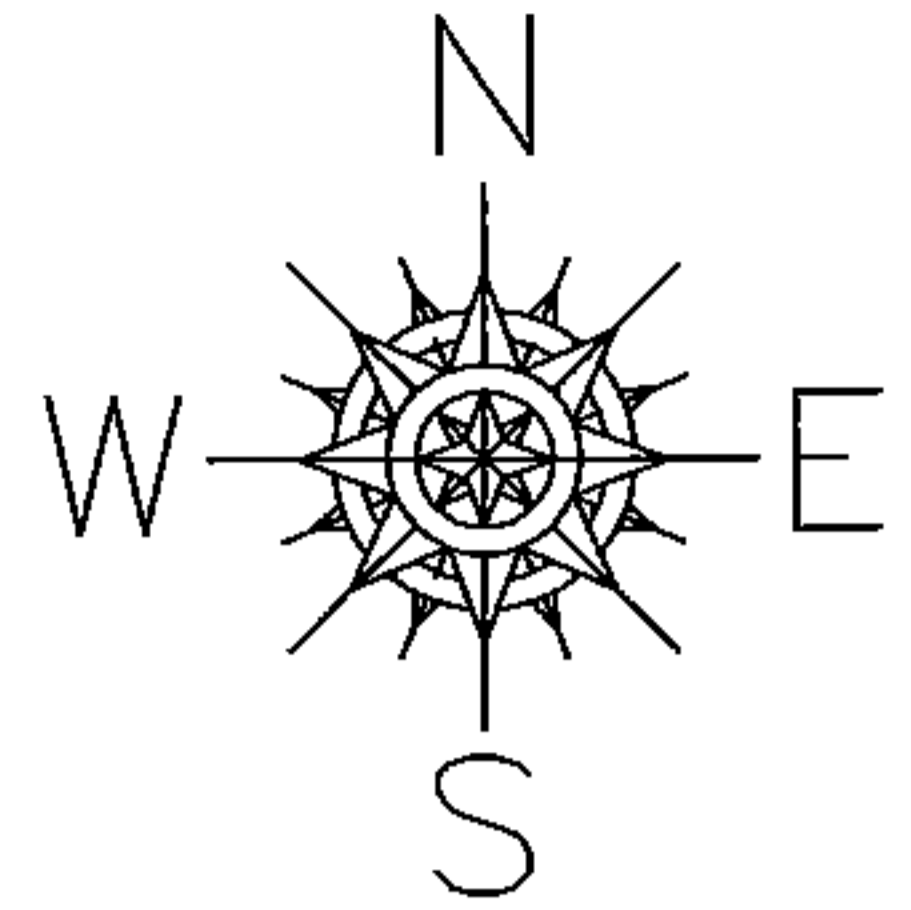

UNCOMBINATION

~~06-25-131-000-004~~  
~~92 X 365~~

06-25-131-000-005    06-25-131-000-006  
75 X ?                    17 X ?

PER PRIOR DEEDS

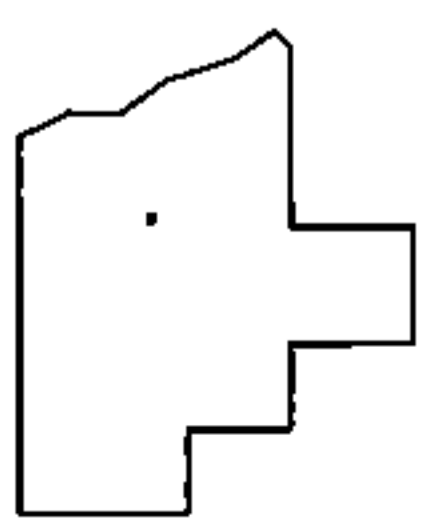
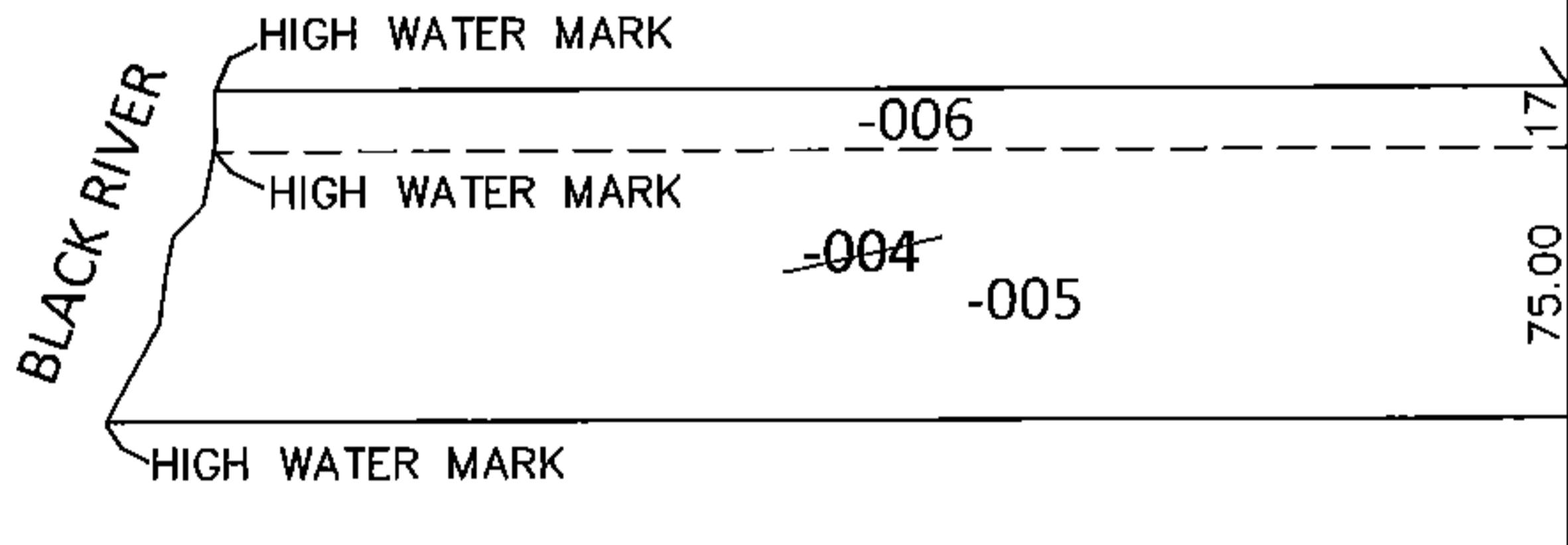
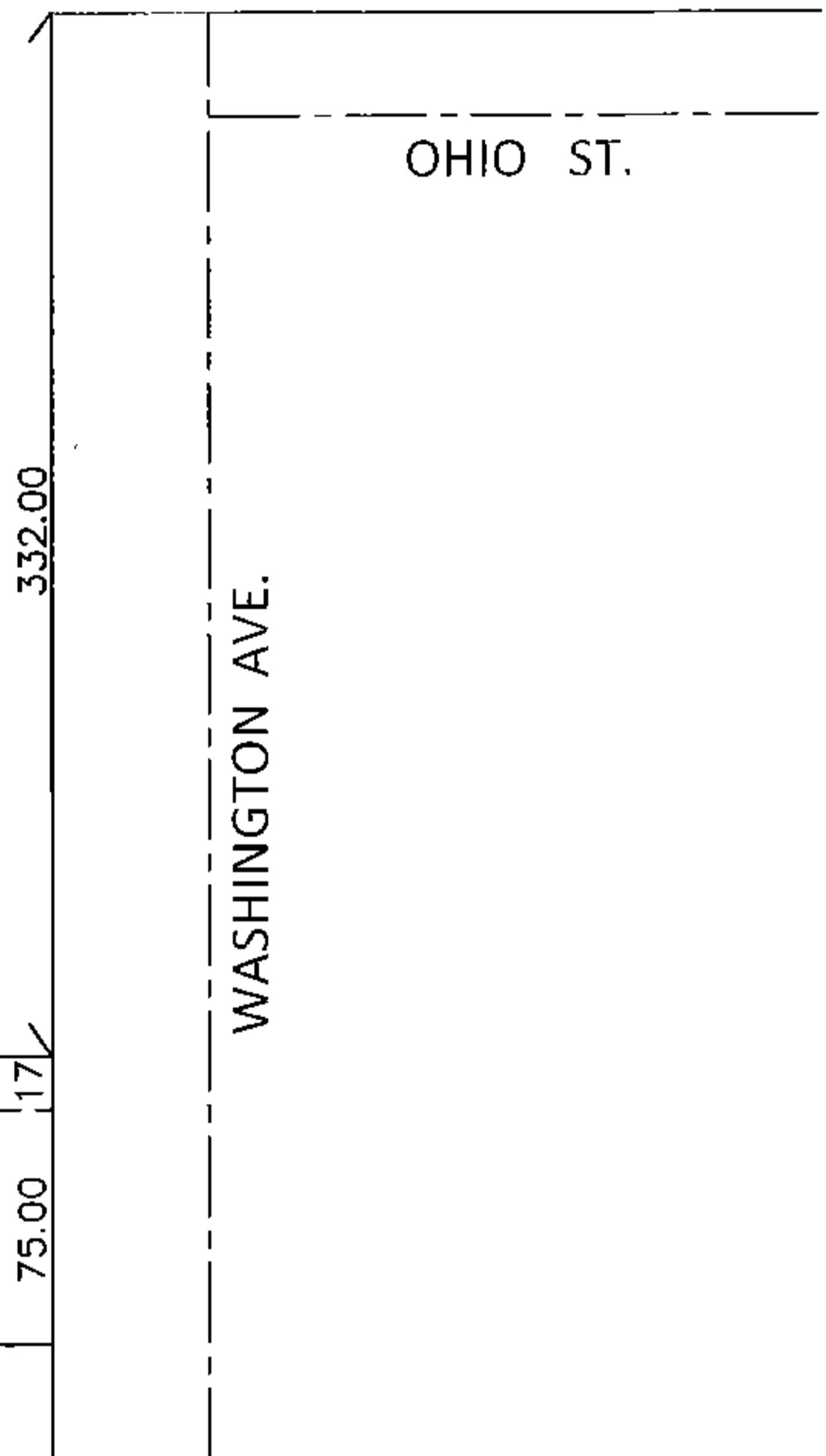

SPLITS/DEEDS PROCESSED

LORAIN COUNTY TAX MAP DEPARTMENT  
226 MIDDLE AVE. ELYRIA, OHIO

SURVEYED BY: N/A  
CLOSURE: N/A  
MAP PAGE(S): 6-31  
APPROVED BY: RRM    DATE: 4-2-15  
SCALE: 1"= 100    PRIOR INST.: 20080277144