

PARENT PARCEL: 02-02-026-114-019

CHILD PARCEL: _____

STARTING POINT: SOUTHEAST CORNER OF S/L 9 IN BROWNELL'S 2ND ADD.(VOL.2 PG.17)

15-03108-D

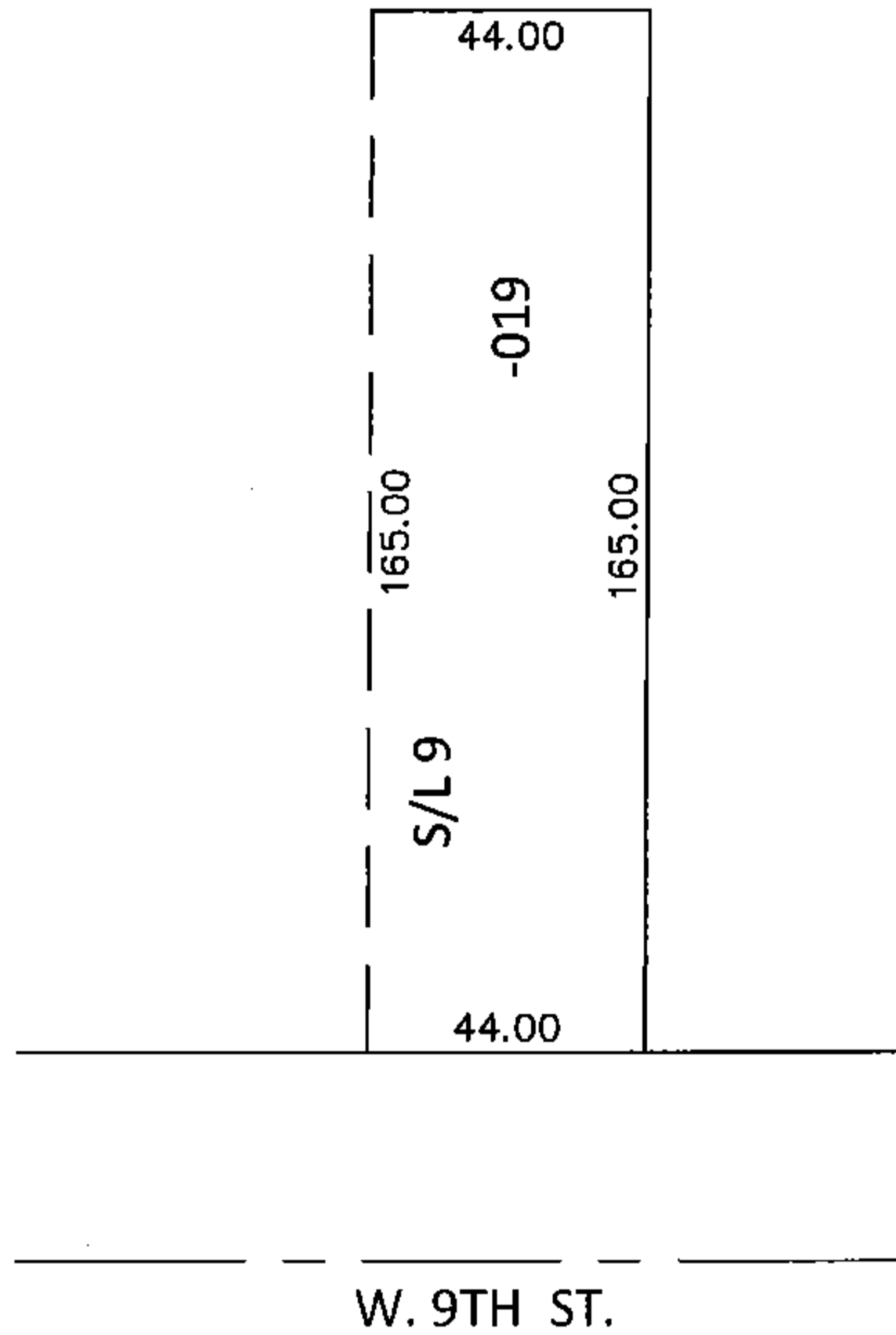
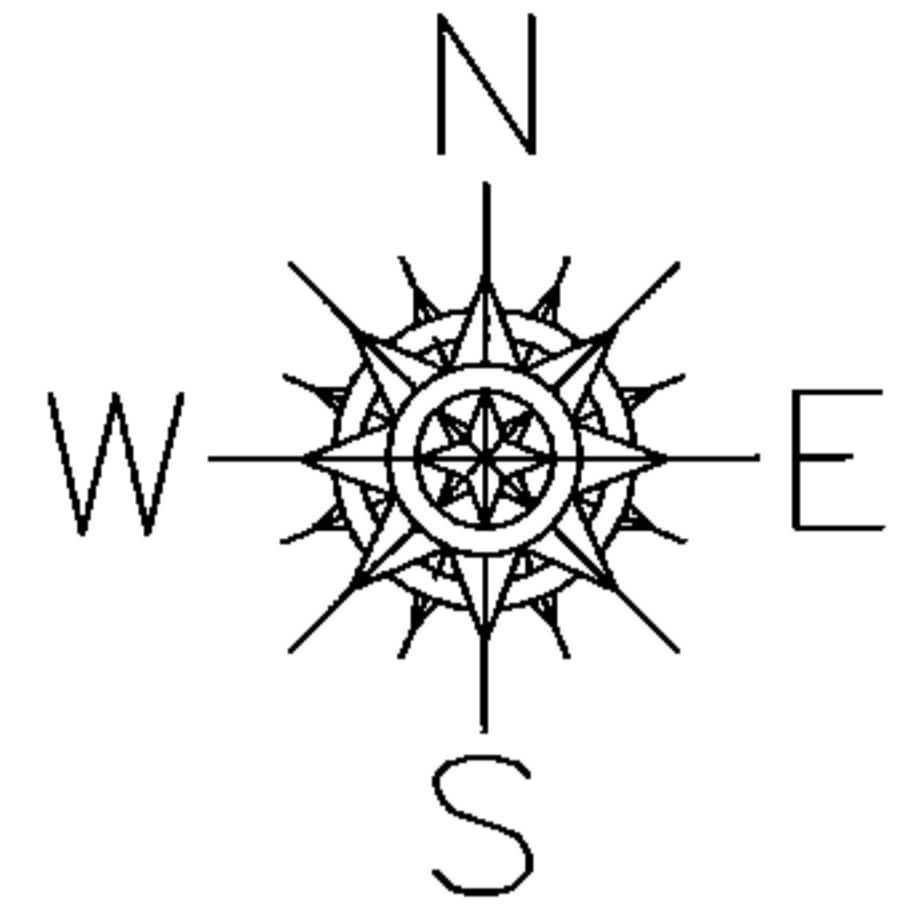

NO MAP CHANGES

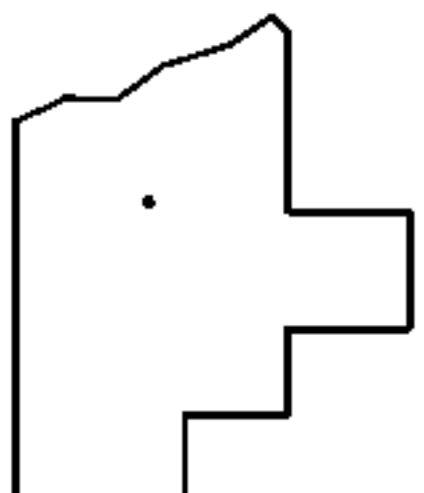

SPLITS/DEEDS PROCESSED

LORAIN COUNTY TAX MAP DEPARTMENT
226 MIDDLE AVE. ELYRIA, OHIO

SURVEYED BY: DALE R. HAYWOOD

CLOSURE: .00:10,000

MAP PAGE(S): 2-02-026-B

APPROVED BY: RRM DATE: 2-3-15

SCALE: 1"= 50' PRIOR INST.: 20140514049