

PARENT PARCEL: 02-01-006-138-008

CHILD PARCEL: \_\_\_\_\_

STARTING POINT: S/L 135 IN J.B. HOGE'S ADD. (VOL.5 PG.6)

15-03097-C

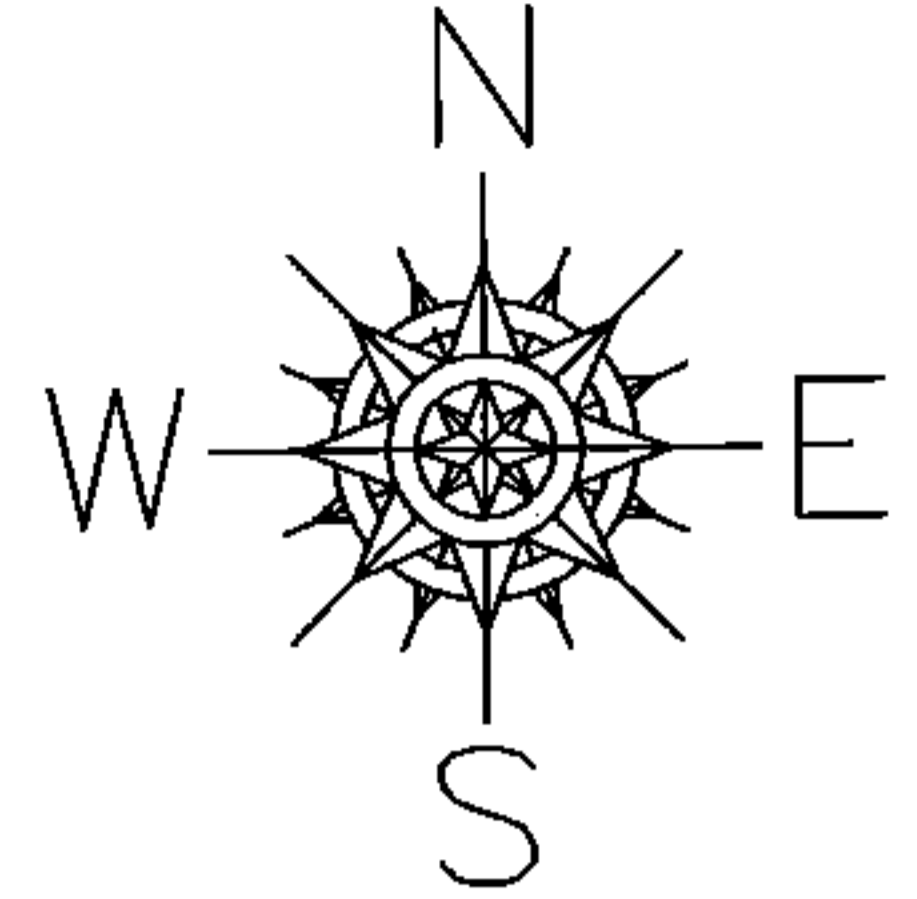

18TH ST.

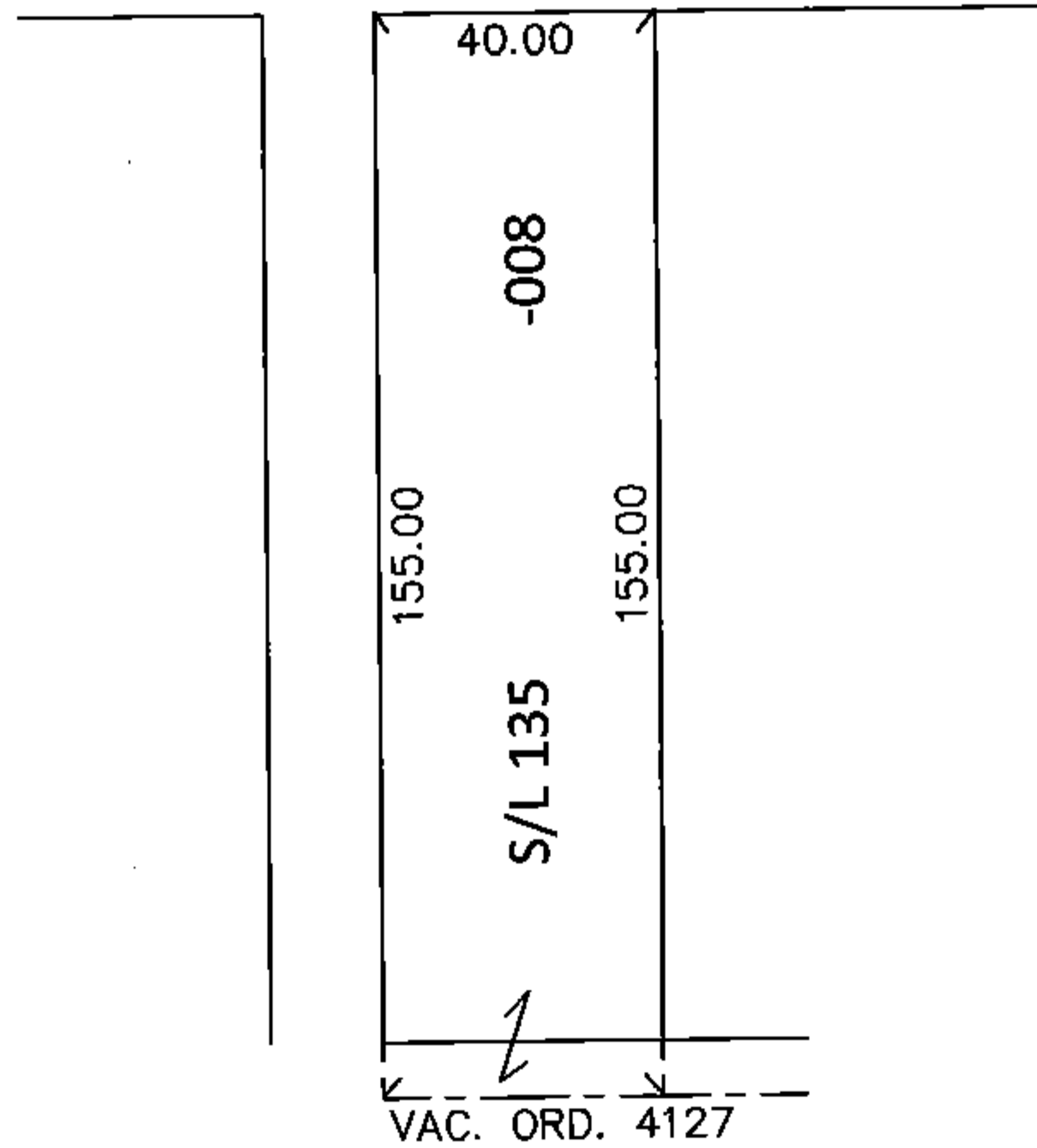

**DEPTH CORRECTION**

02-01-006-138-008

155

40 X ~~147~~

CORR. PER. DEED & ORD.4127

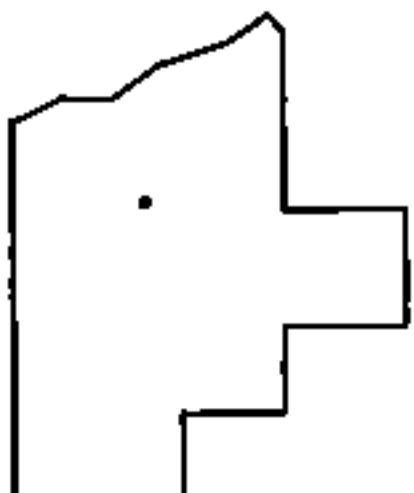

**SPLITS/DEEDS PROCESSED**

LORAIN COUNTY TAX MAP DEPARTMENT  
226 MIDDLE AVE. ELYRIA, OHIO

SURVEYED BY: N/A

CLOSURE: N/A

MAP PAGE(S): 2-01-006-C

APPROVED BY: RRM DATE: 1-22-15

SCALE: 1" = 50' PRIOR INST.: 20080274268