

PARENT PARCEL: 02-01-004-101-041

CHILD PARCEL:

STARTING POINT: SOUTHWEST CORNER OF LAND CONVEYED TO EDGAR G. YECKLEY (DV 171/355)

14-03065-X

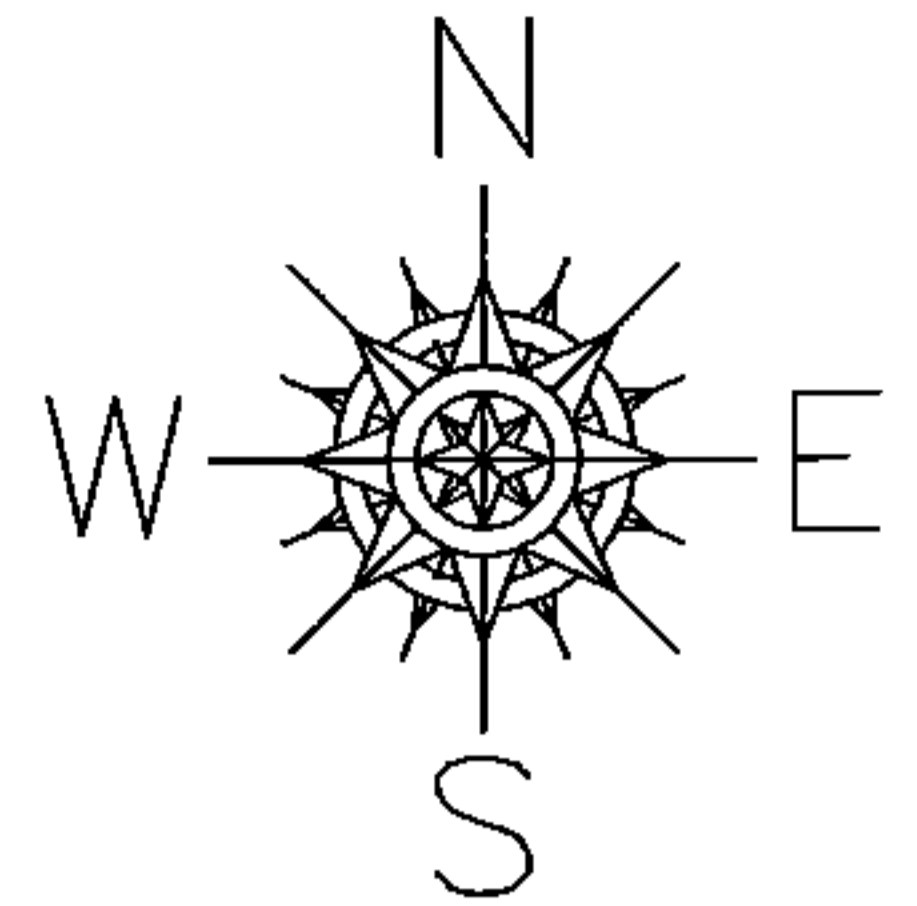

DEPTH CORRECTION

02-01-004-101-041

125.61

25 X ~~126~~

PER PRIOR DEEDS

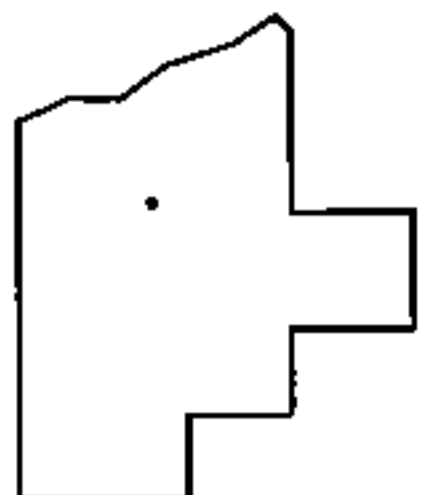
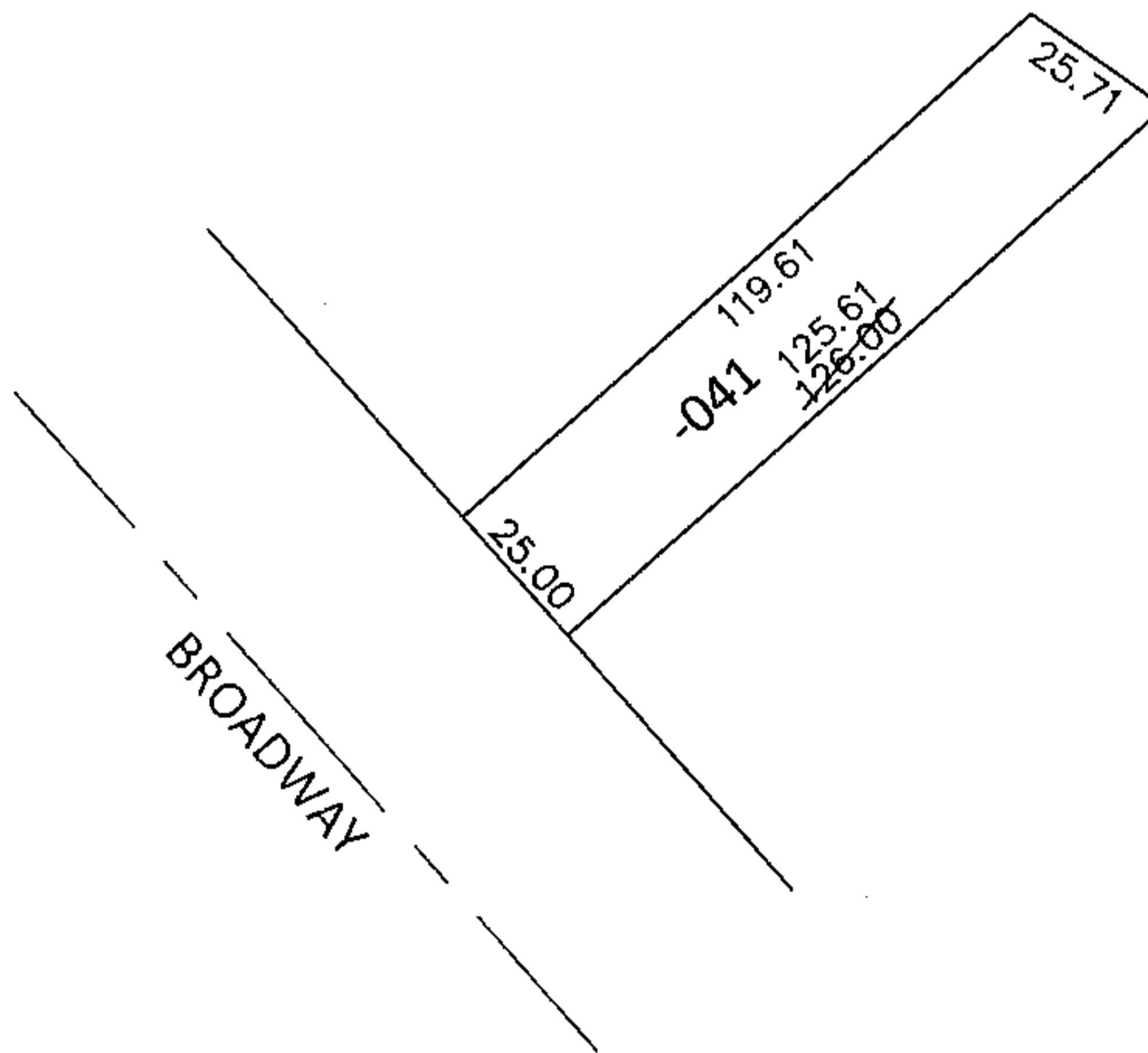

SPLITS/DEEDS PROCESSED

LORAIN COUNTY TAX MAP DEPARTMENT
226 MIDDLE AVE. ELYRIA, OHIO

SURVEYED BY: N/A

CLOSURE: N/A

MAP PAGE(S): 2-01-004-A

APPROVED BY: RRM DATE: 12-1-14

SCALE: 1"= 50' PRIOR INST.: 20070192580