

PARENT PARCEL: 18-00-028-109-011

CHILD PARCEL: _____

STARTING POINT: AT A MON BOX AT THE INTERSECTION OF C/L OF JOHNS ST. AND C/L OF WEST ST.

14-03061-D

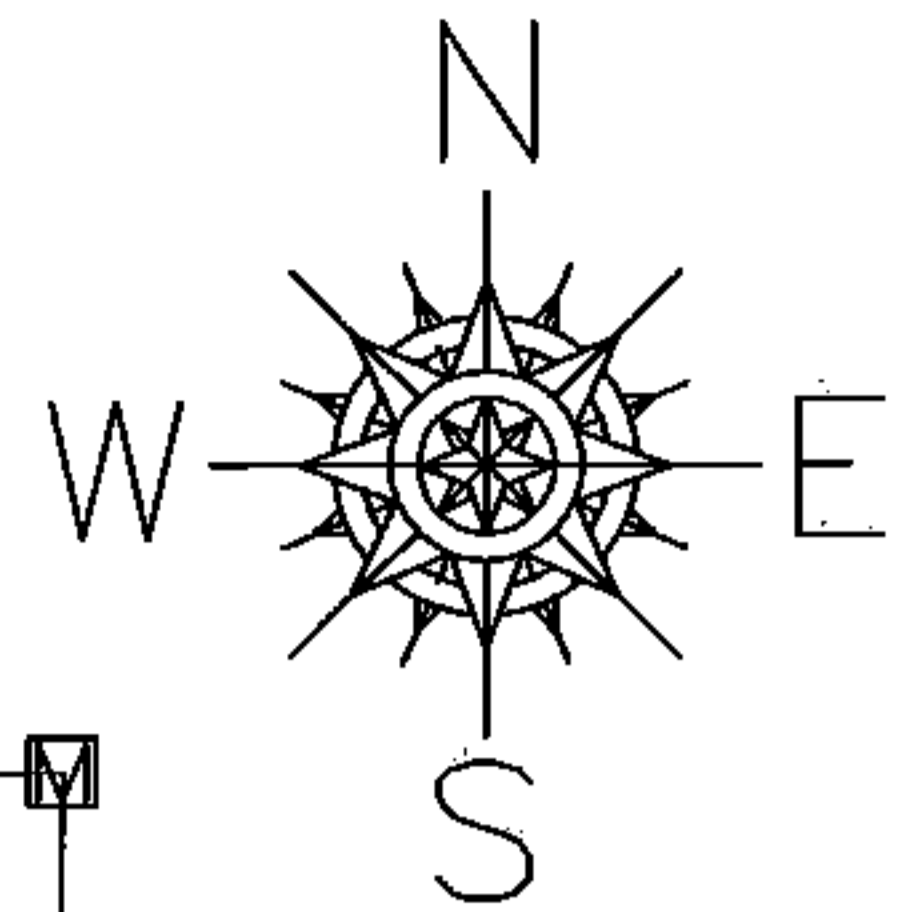

JOHNS ST.

FRONTAGE AND DEPTH TO ACREAGE CORRECTION

18-00-028-109-011

0.21 A.

~~140.26 X 63.50~~

PER SURVEY BY SCOTT J. CASEY

233.53

WEST ST.

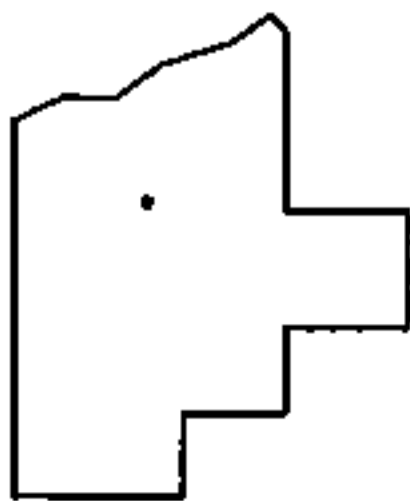
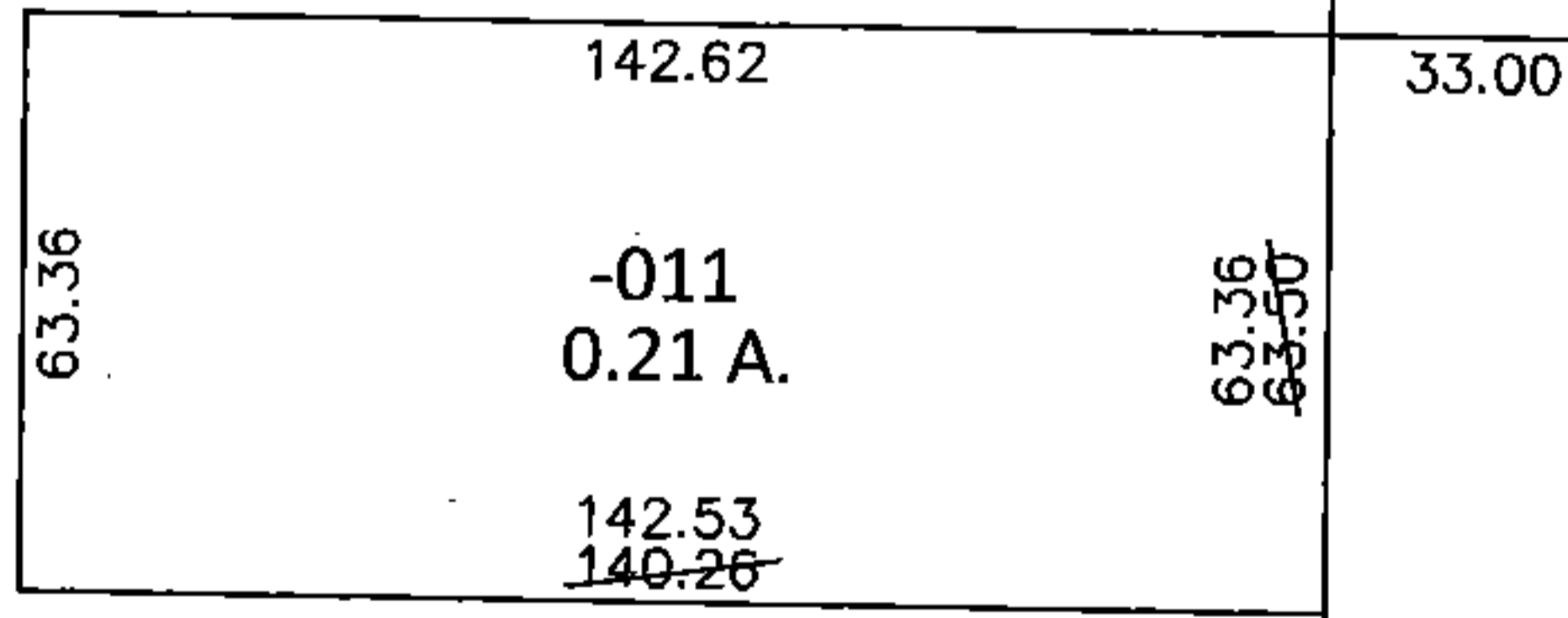

SPLITS/DEEDS PROCESSED

LORAIN COUNTY TAX MAP DEPARTMENT
226 MIDDLE AVE. ELYRIA, OHIO

SURVEYED BY: SCOTT J. CASEY

CLOSURE: .00:10,000

MAP PAGE(S): 18-00-028-C

APPROVED BY: RRM DATE: 11-18-14

SCALE: 1"= 50' PRIOR INST.: 20140502165