

PARENT PARCEL: 03-00-104-101-023 -024

CHILD PARCEL: 03-00-104-101-047

12-03036

STARTING POINT: CENTERLINE OF LINCOLN AVE/FRANKFORD ST & CORP LINE CITY OF LORAIN

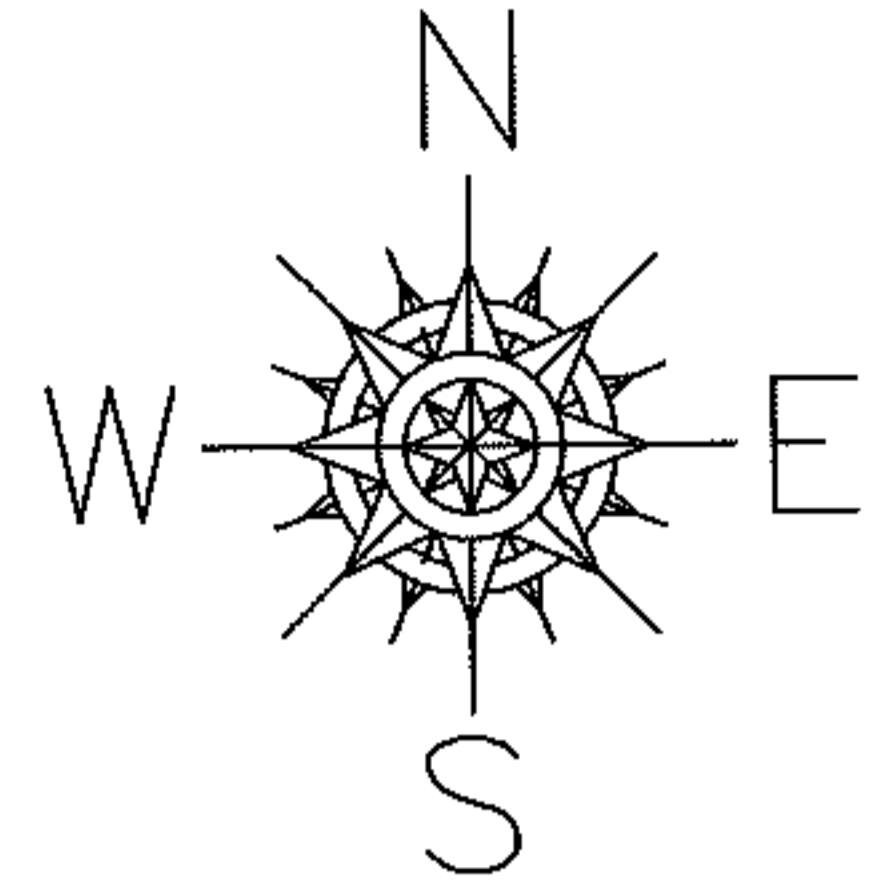

CLINTON AVE

ST RT 57

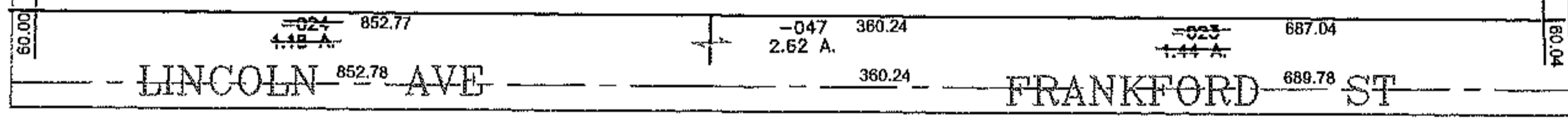

**SPLITS/DEEDS PROCESSED**  
 LORAIN COUNTY TAX MAP DEPARTMENT  
 226 MIDDLE AVE. ELYRIA, OHIO

SURVEYED BY: TIMOTHY J FELLER  
 CLOSURE: 0.00 : 10.000  
 MAP PAGE(S): 03-00-104-A, B  
 APPROVED BY: JAH DATE: 6-7-2012  
 SCALE: 1" = 300 PRIOR INSTRUMENT: 20000704256