

PARENT PARCEL: 03-00-056-108-025, -029

CHILD PARCEL: _____

STARTING POINT: INTERSECTION OF SOUTH LINE OF LARKMOOR ST. AND WEST LINE OF EUCLID AVE.

14-03012-A

LARKMOOR ST.

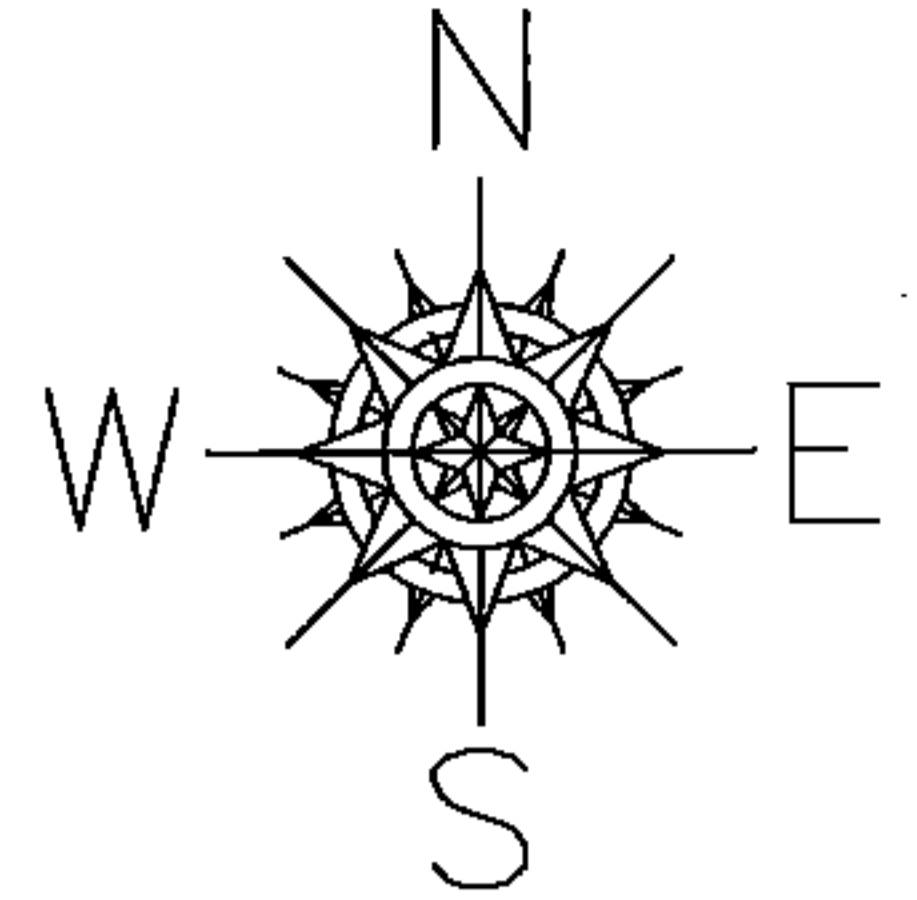

DEPTH CORRECTION

03-00-056-108-025	03-00-056-108-029
130.01	130.01
35 X 122	70 X 122

PER SURVEY BY D. HAYWOOD & ORD. 5461

280.00

EUCLID AVE.

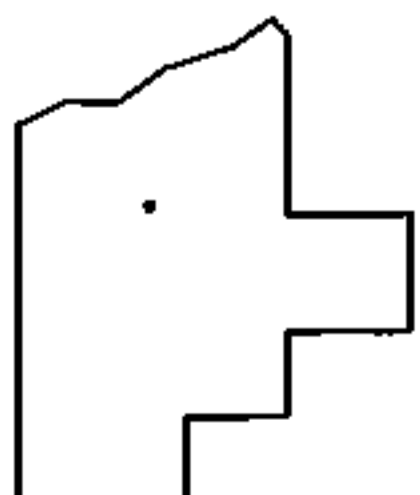
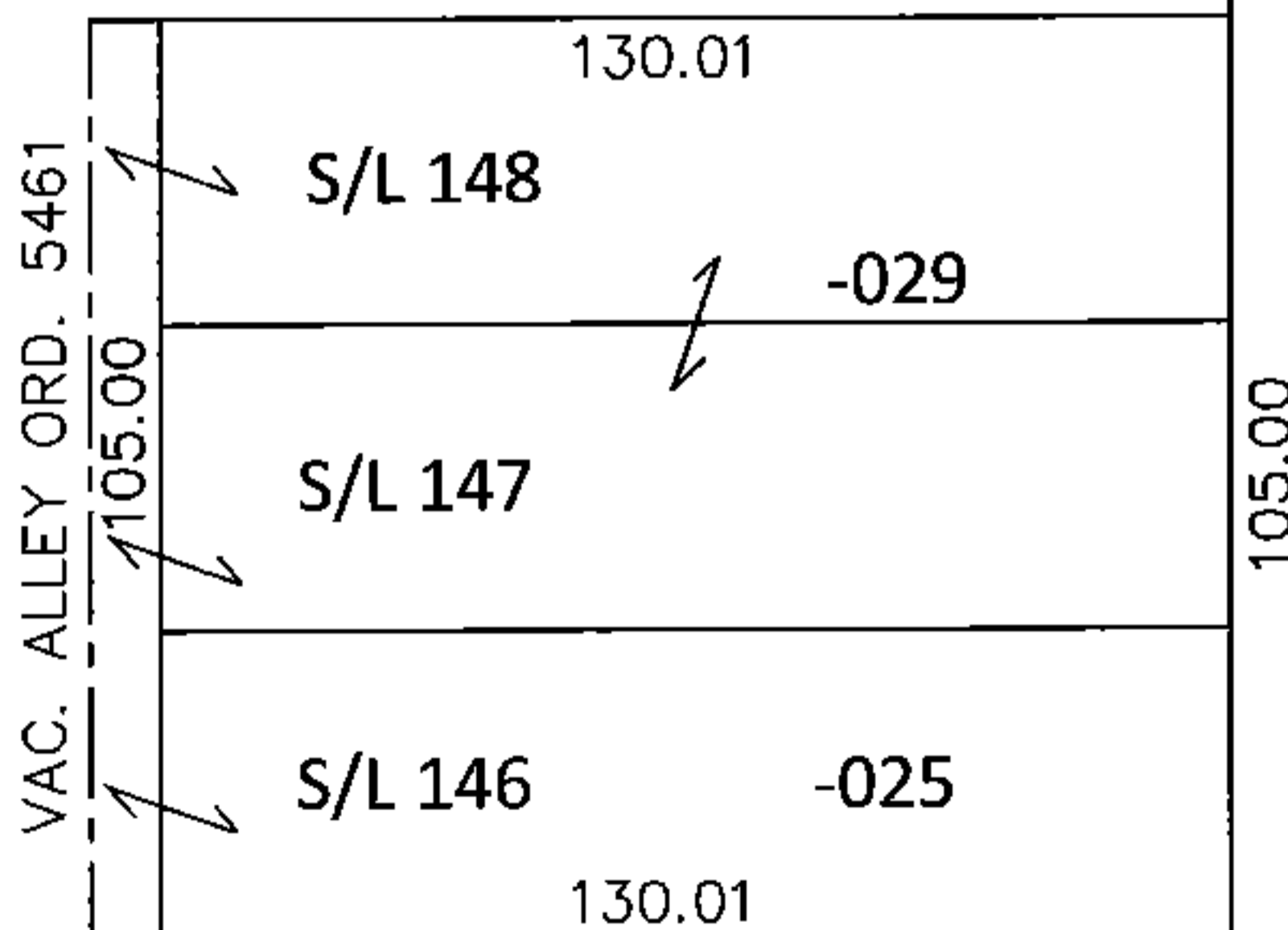

SPLITS/DEEDS PROCESSED

LORAIN COUNTY TAX MAP DEPARTMENT
226 MIDDLE AVE. ELYRIA, OHIO

SURVEYED BY: DALE R. HAYWOOD

CLOSURE: .00:10,000

MAP PAGE(S): 3-00-056

APPROVED BY: RRM DATE: 9-8-14

SCALE: 1"= 50' PRIOR INST.: DV XXXX/XXX