

PARENT PARCEL: 09-00-091-000-025,-026
CHILD PARCEL: 09-00-091-000-032 THRU -034
STARTING POINT: INTERSECTION OF C/L OF QUARRY RD. AND C/L OF HAMILTON RD.

NO. 01541

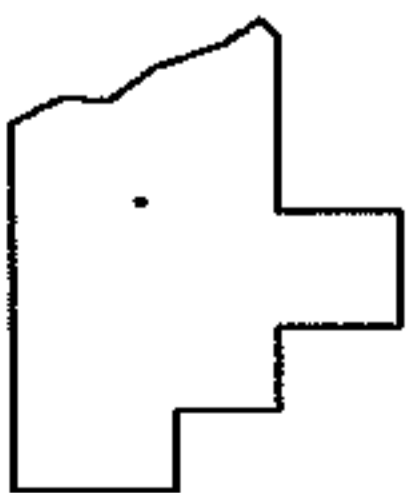
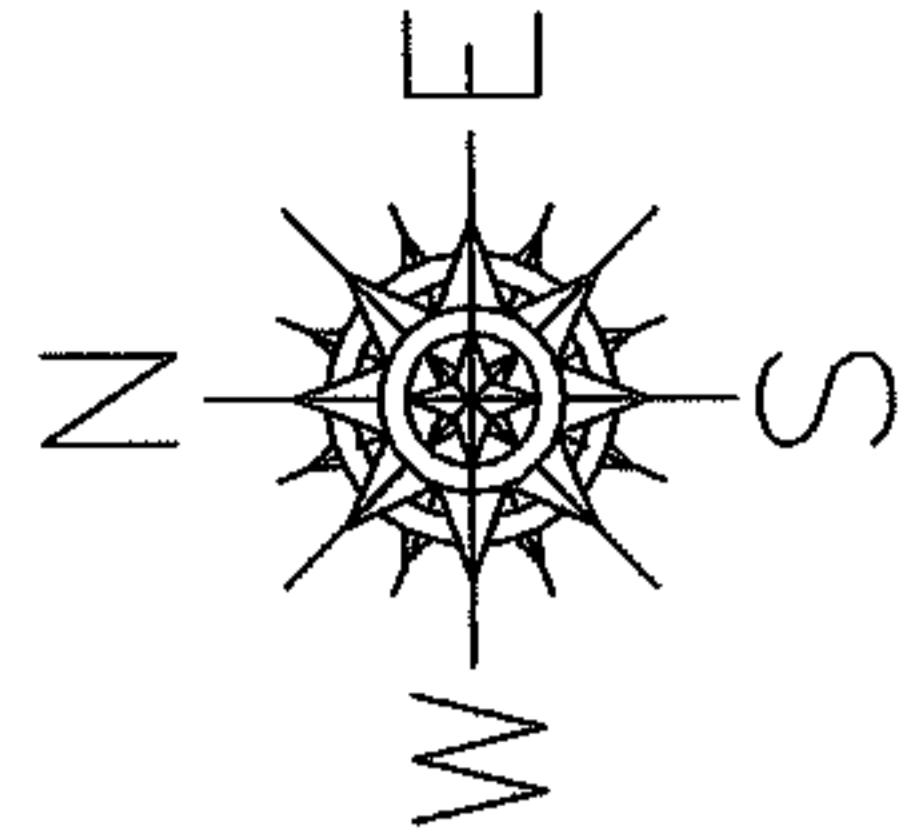
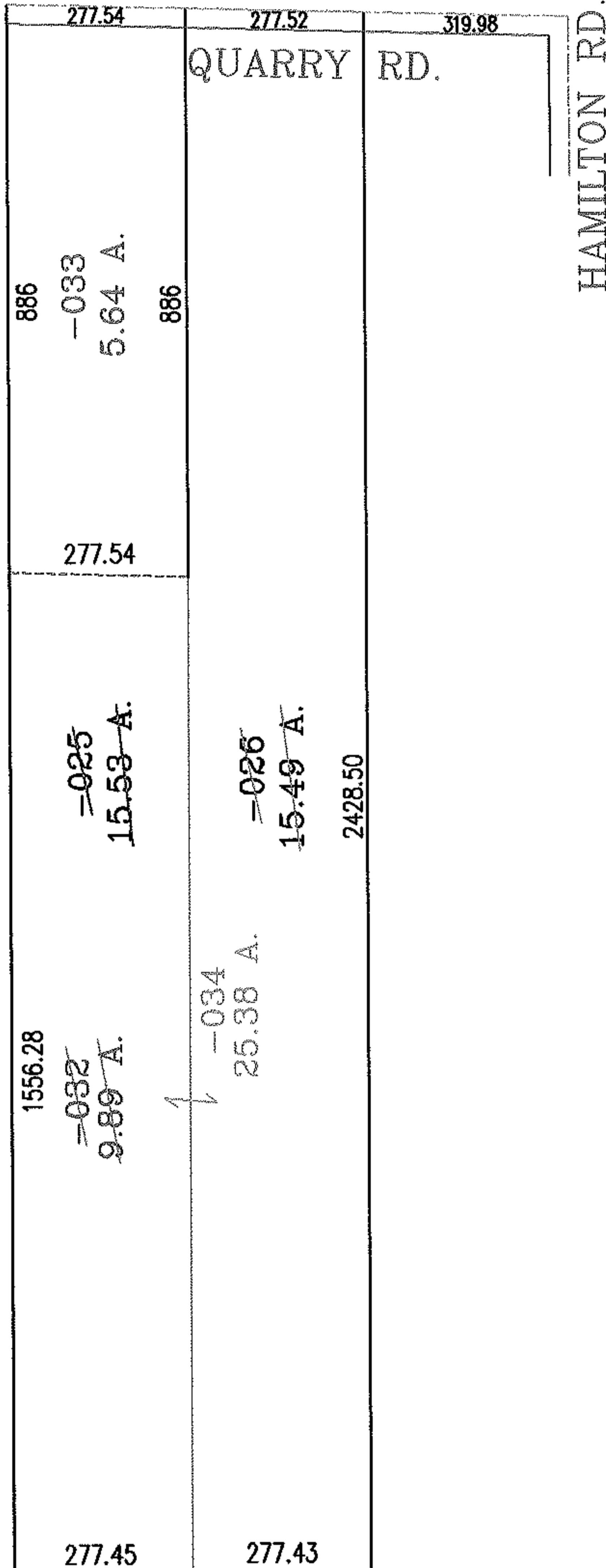

SPLITS/DEEDS PROCESSED
LORAIN COUNTY TAX MAP DEPARTMENT
226 MIDDLE AVE. ELYRIA, OHIO

SURVEYED BY: JOHN E. DAILEY
CLOSURE: .02:10.000
MAP PAGE(S): 9-E
APPROVED BY: RRM DATE: 12-8-03
SCALE: 1" = 300 PRIOR INSTRUMENT: 980531465