

RASTER

PARENT PARCEL: 16-00-057-000-016, -019

CHILD PARCEL: XX-XX-XXX-XXX-XXX

STARTING POINT: CL MENELL ROAD AND SW CORNER O.L.57

NO. 01519

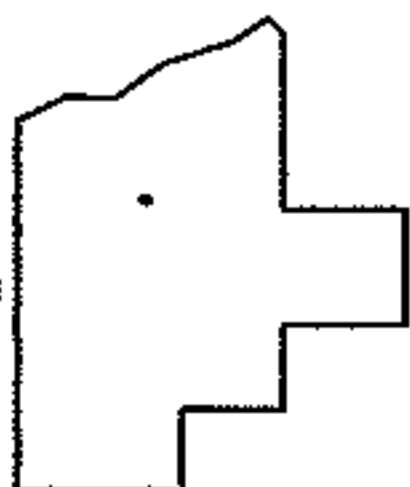
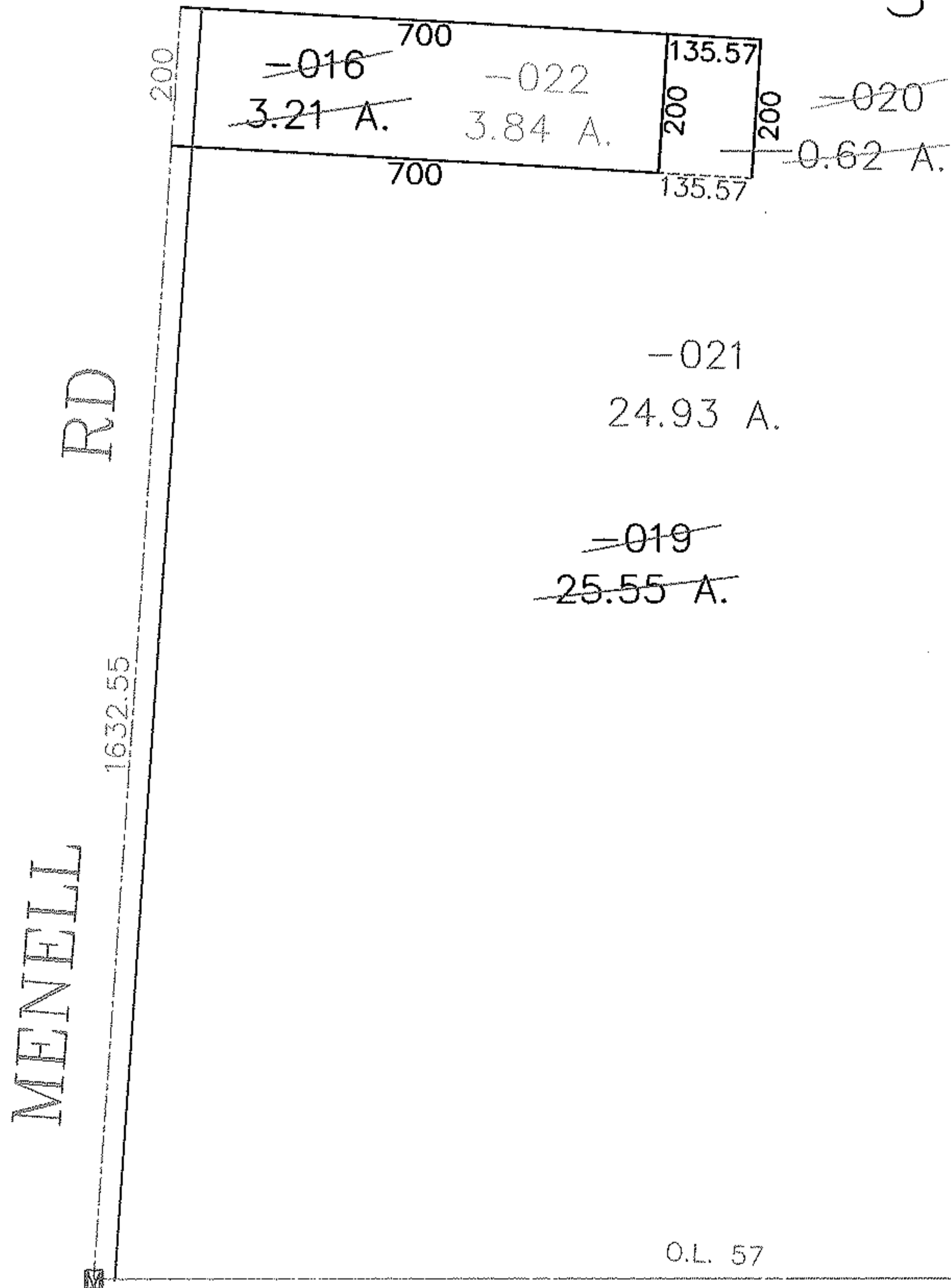
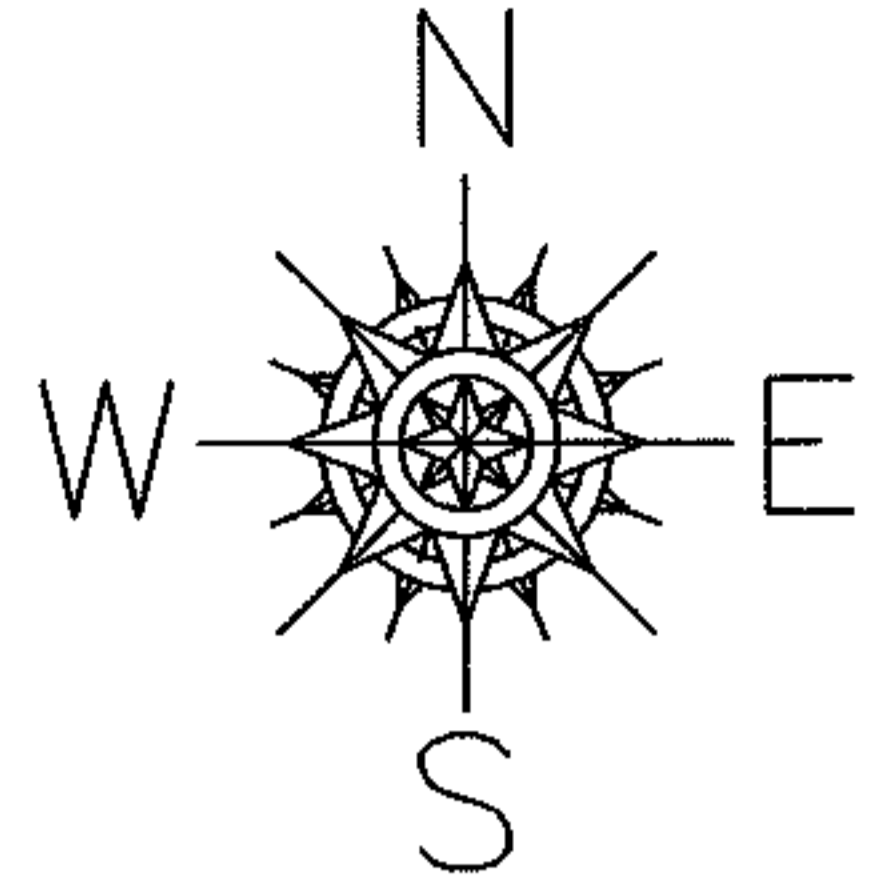

SPLITS/DEEDS PROCESSED
 LORAIN COUNTY TAX MAP DEPARTMENT
 226 MIDDLE AVE. ELYRIA, OHIO

SURVEYED BY: CARL ANDERSON
 CLOSURE: 1:10,000
 MAP PAGE(S): 16-00-057-A
 APPROVED BY: DRH DATE: 11/12/2003
 SCALE: 1" = 300 PRIOR INSTRUMENT: