

PASTER

PARENT PARCEL: 11-00-019-000-055

CHILD PARCEL: 11-00-019-000-056, -057, -058

STARTING POINT: INT NE CORNER OF O.L. 19 AND CL OF COWLEY RD

NO. 01396



COWLEY RD.

~~-055~~
~~36.01 A.~~

-058
33.83 A.

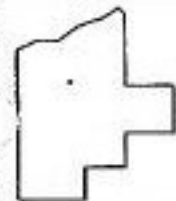
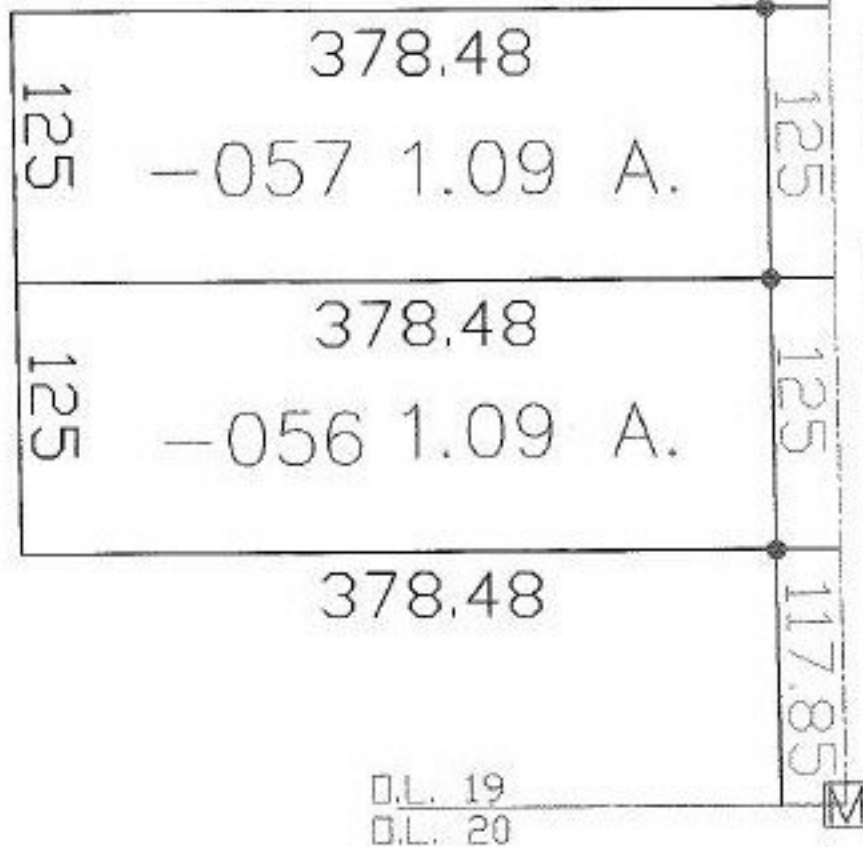

SPLITS/DEEDS PROCESSED

LORAIN COUNTY TAX MAP DEPARTMENT
226 MIDDLE AVE. ELYRIA, OHIO

SURVEYED BY: RICHARD D. CARLSON

CLOSURE: 0:00

MAP PAGE(S): 11-00-019-B

APPROVED BY: DRH DATE: 7/21/2003

SCALE: 1" = 100' PRIOR INSTRUMENT: DV 44/296