

MASTER

PARENT PARCEL: 08-12-010-000-005

CHILD PARCEL: 08-12-010-000-014, -015

STARTING POINT: MON. BOX INT C.L. BECKER RD AND C.L. GORE ORPHANAGE RD.

NO. 01351

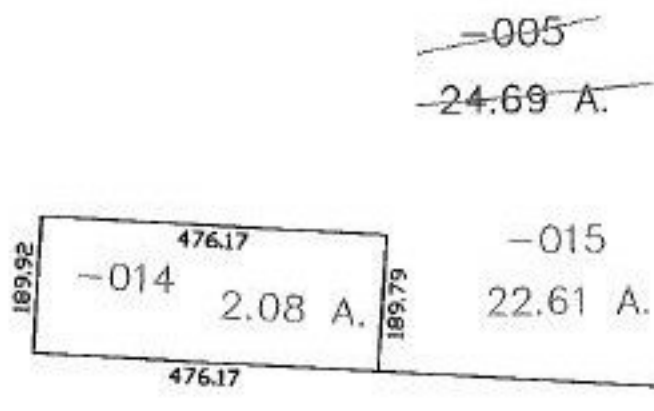

D.L. 10  
D.L. 9

GORE ORPHANAGE RD

BECKER ROAD

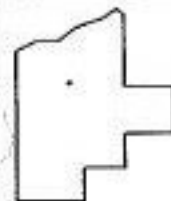

**SPLITS/DEEDS PROCESSED**

LORAIN COUNTY TAX MAP DEPARTMENT  
226 MIDDLE AVE. ELYRIA, OHIO

SURVEYED BY: TIMOTHY O. RILEY

CLOSURE: 1:13,000

MAP PAGE(S): 8-E

APPROVED BY: DRH DATE: 4/21/2003

SCALE: 1" = 300 PRIOR INSTRUMENT: 20000709858