

RASIER

PARENT PARCEL: 11-00-006-000-015, -035

CHILD PARCEL: 11-00-006-000-077

STARTING POINT: INT C.L. ELYRIA TWINSBURG RD AND C.L. HAWKE RD

NO. 01301

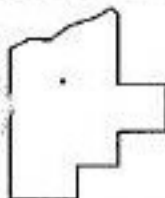
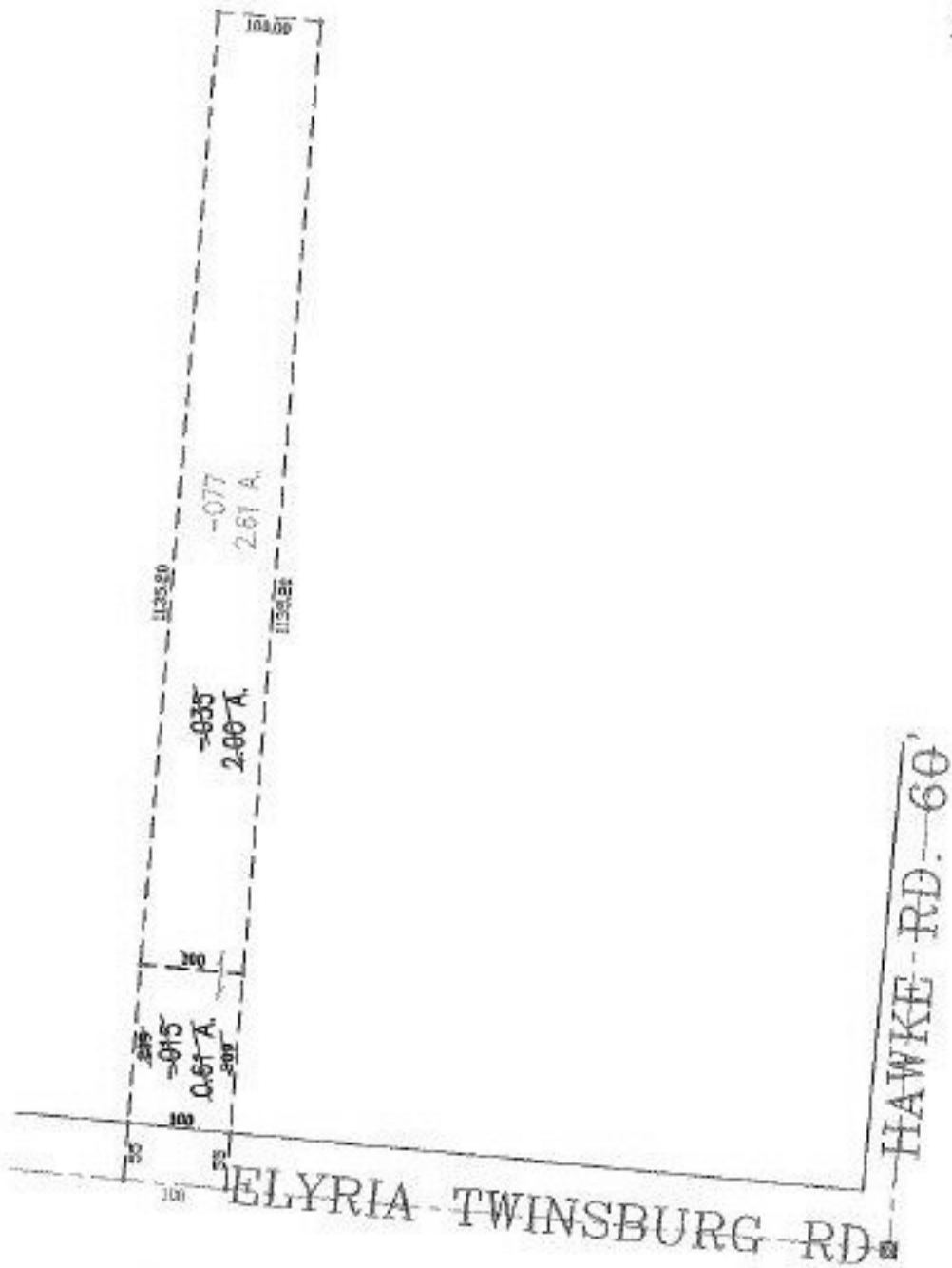

SPLITS/DEEDS PROCESSED
 LORAIN COUNTY TAX MAP DEPARTMENT
 226 MIDDLE AVE. ELYRIA, OHIO

SURVEYED BY: VINCENT C. MCGERVEY
 CLOSURE: N/A
 MAP PAGE(S): 11-00-006-A
 APPROVED BY: DRH DATE: 2/3/03
 SCALE: 1" = 200' PRIOR INSTRUMENT: 2000719841