

03 - RASTER

PARENT PARCEL: 04-00-030-133-032

CHILD PARCEL: 04-00-030-133-047, -048

STARTING POINT: SIDELINE OF GROVE AVE & TOMAHAWK DR.

NO. 01286

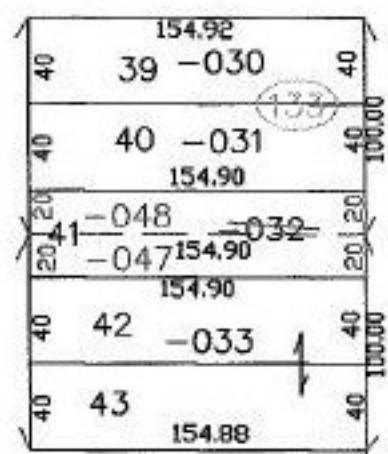

TOMAHAWK DR.

GROVE ST.

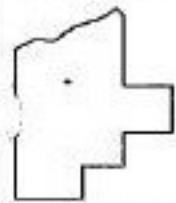

SPLITS/DEEDS PROCESSED

LORAIN COUNTY TAX MAP DEPARTMENT
226 MIDDLE AVE. ELYRIA, OHIO

SURVEYED BY: ALEX KELSER
 CLOSURE: 0.00 : 10.000
 MAP PAGE(S): 4-00-030-B
 APPROVED BY: JAH DATE: 1-6-03
 SCALE: 1" = 100' PRIOR INSTRUMENT: 20000688962