

PARENT PARCEL: 03-00-039-121-029

CHILD PARCEL: 03-00-039-121-073, -074

STARTING POINT: SIDELINE OF FERNDALE AVE. & KENILWORTH AVE.

NO. 00012

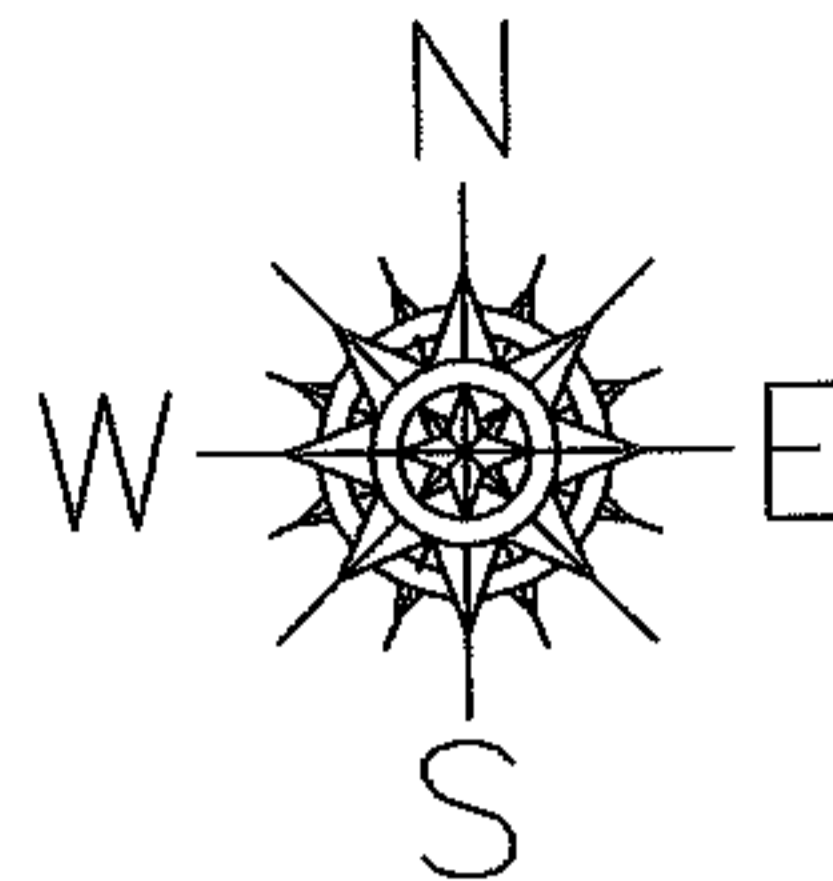

~~FERNDALE AVE.~~

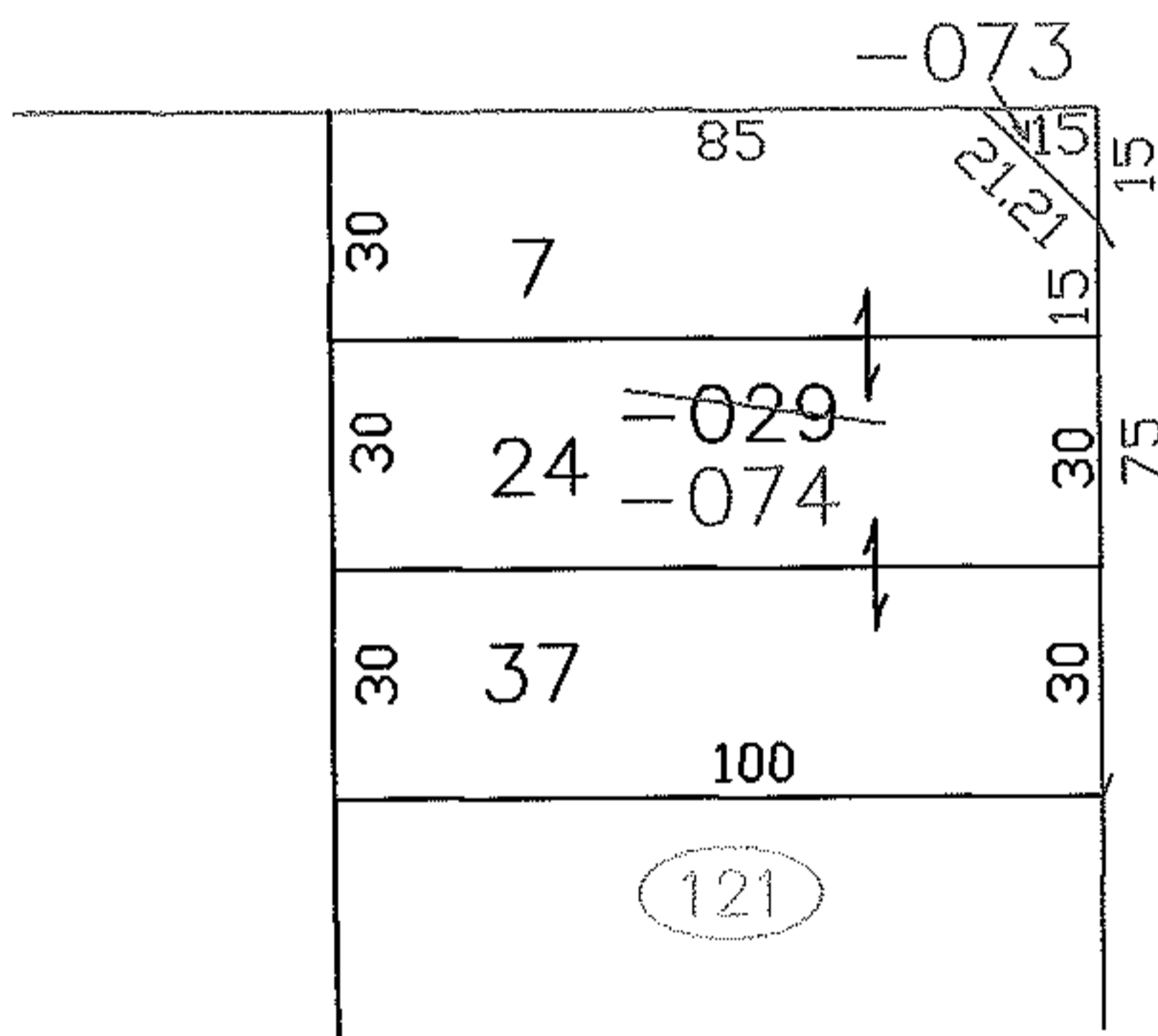

~~KENILWORTH AVE.~~

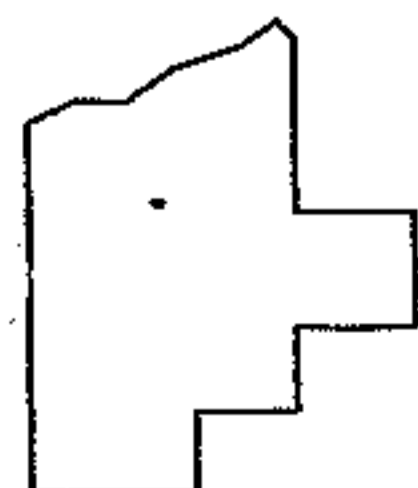

SPLITS/DEEDS PROCESSED
LORAIN COUNTY TAX MAP DEPARTMENT
226 MIDDLE AVE. ELYRIA, OHIO

SURVEYED BY: ROBERT J MCAULEY
CLOSURE: 0.00 : 10.000
MAP PAGE(S): 03-00-039-B
APPROVED BY: JAH DATE: 1-27-03
SCALE: 1" = 50' PRIOR INSTRUMENT: DE 10133 / 159