

Revised

PARENT PARCEL: 11-00-028-000-034, -036

CHILD PARCEL: 11-00-028-000-075

11-02939

STARTING POINT: CENTERLINE OF COOLEY RD & REED RD

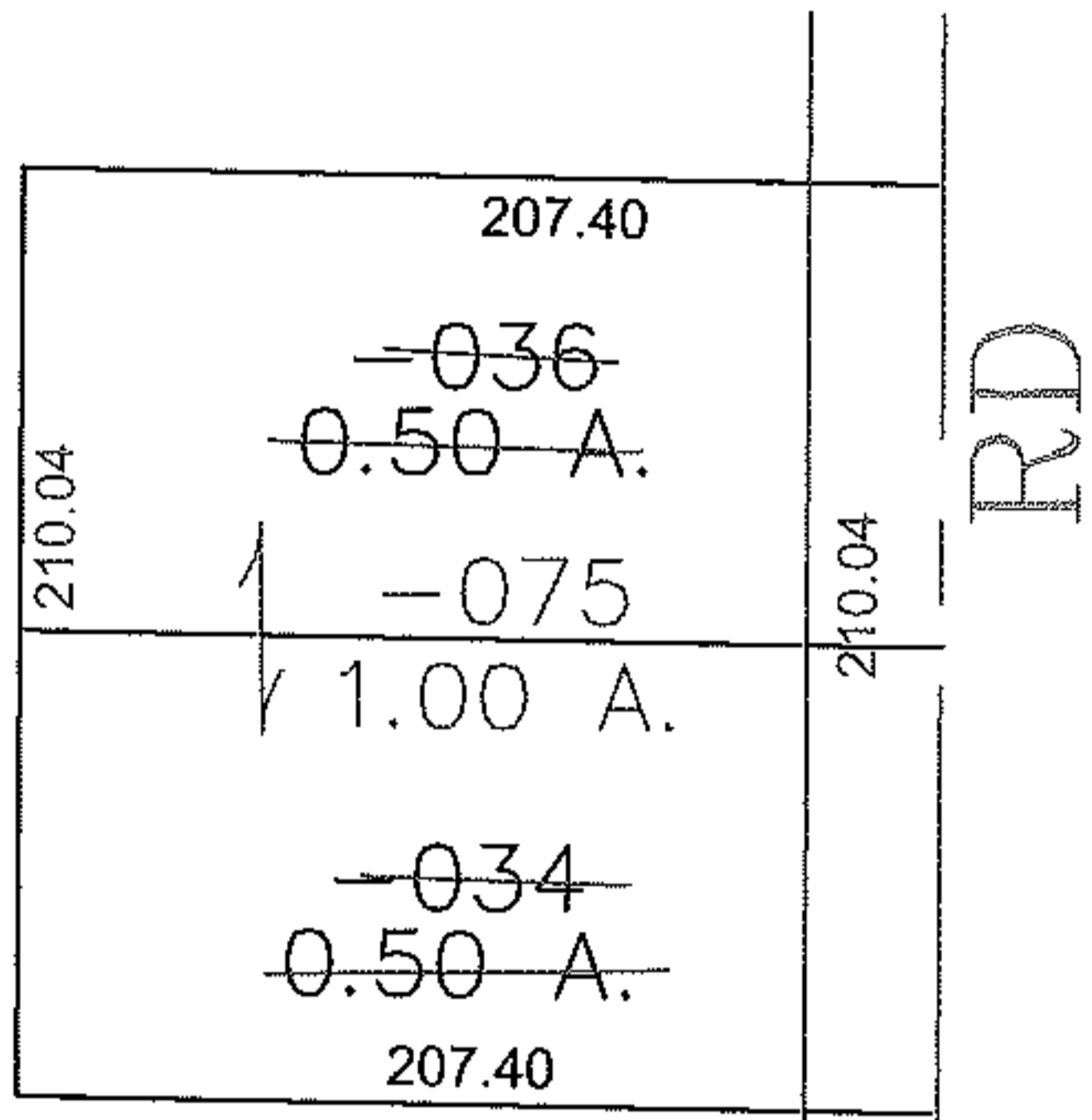
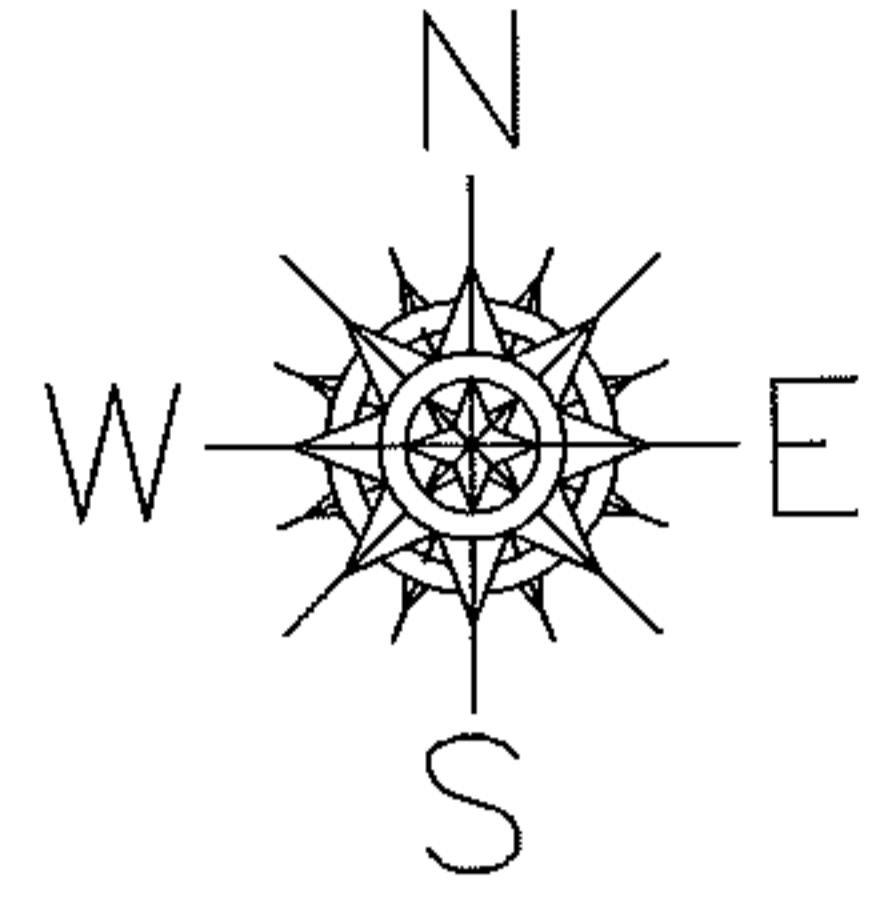

COOLEY RD

REED RD

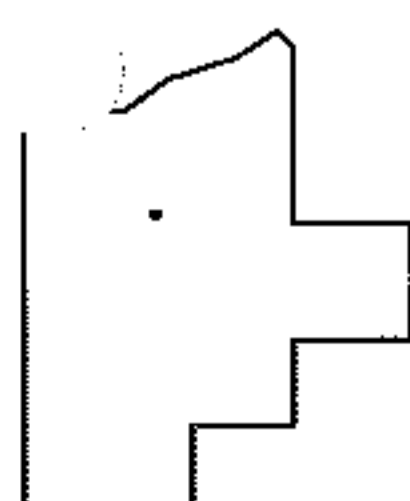

SPLITS/DEEDS PROCESSED

LORAIN COUNTY TAX MAP DEPARTMENT
226 MIDDLE AVE. ELYRIA, OHIO

SURVEYED BY: DALE HAYWOOD
 CLOSURE: 0.00 : 10.000
 MAP PAGE(S): 11-00-028-B
 APPROVED BY: JAH DATE: 8-15-2011
 SCALE: 1" = 100' PRIOR INSTRUMENT: OR 992/446