

PARENT PARCEL: 15-00-049-000-012, -038

CHILD PARCEL:

14-02911-C

STARTING POINT: AT A MON BOX AT THE INTERSECTION OF C/L OF S.R.303 AND C/L OF INDIAN HOLLOW RD.

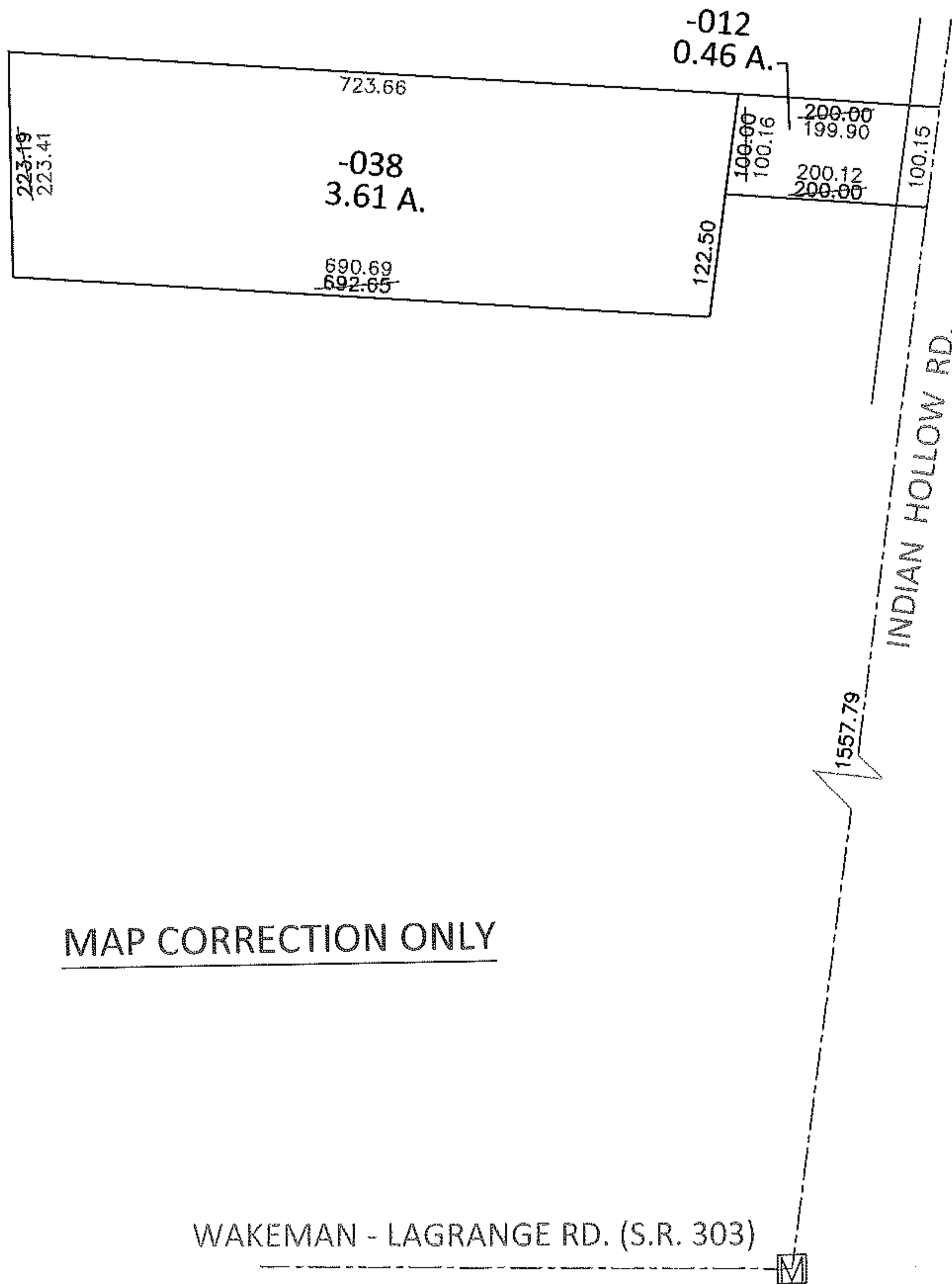
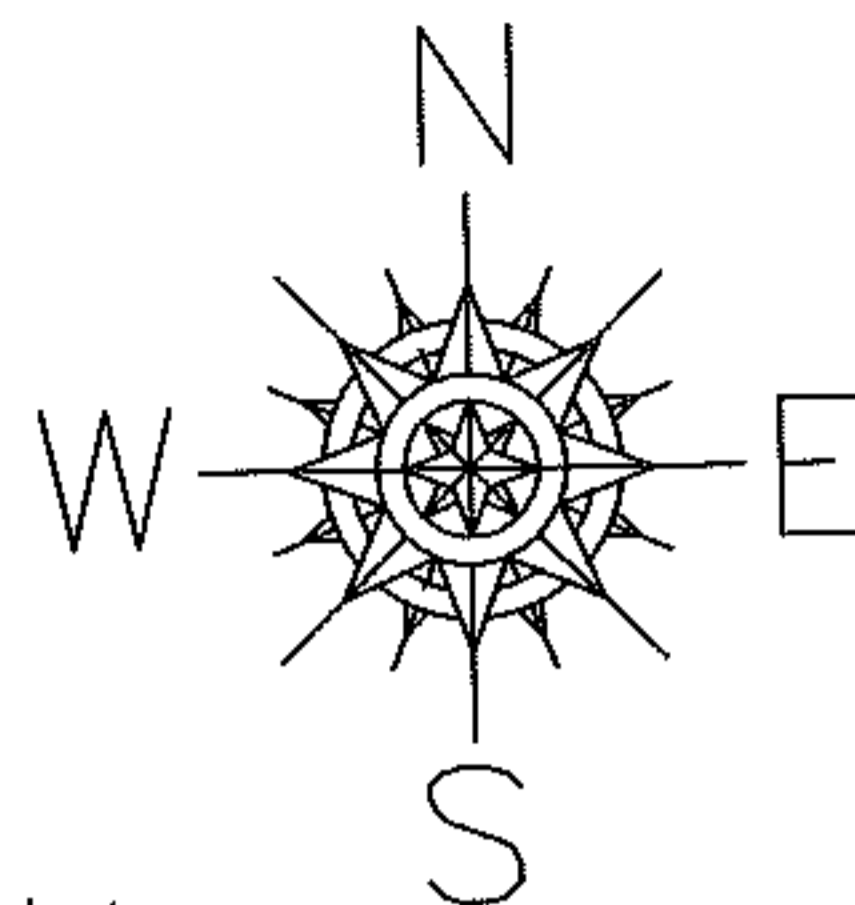

MAP CORRECTION ONLY

WAKEMAN - LAGRANGE RD. (S.R. 303)

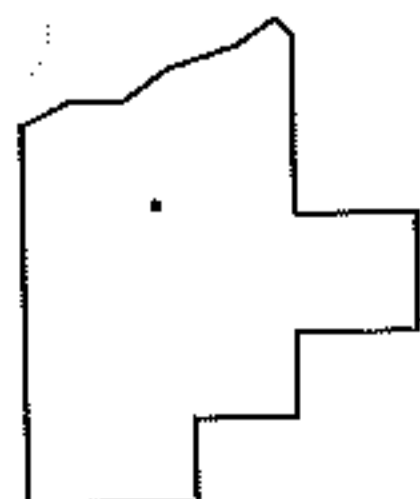

SPLITS/DEEDS PROCESSED

LORAIN COUNTY TAX MAP DEPARTMENT
226 MIDDLE AVE. ELYRIA, OHIO

SURVEYED BY: AMY M. KELLY

CLOSURE: .01:10,000

MAP PAGE(S): 15-00-049-B

APPROVED BY: RRM DATE: 4-7-14

SCALE: 1"= 200 PRIOR INST.: 20140492427