

PARENT PARCEL: 21-17-015-000-012
CHILD PARCEL: 21-17-015-000-016, -017
STARTING POINT: INTERSECTION OF C/L OF S.R.162 AND C/L OF HAWLEY RD.

10-02872

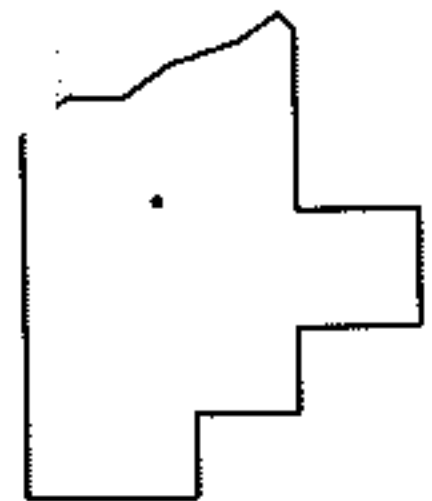
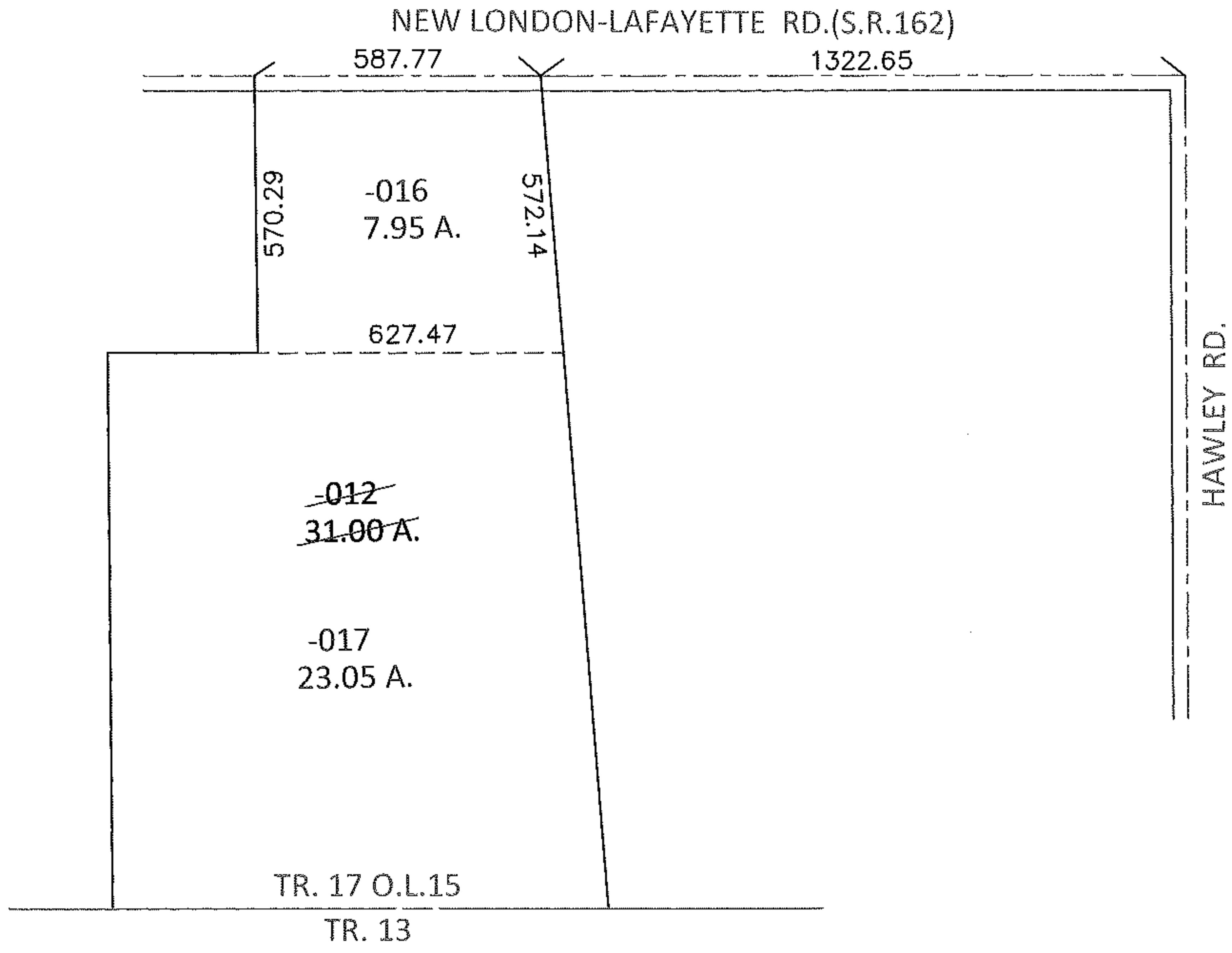
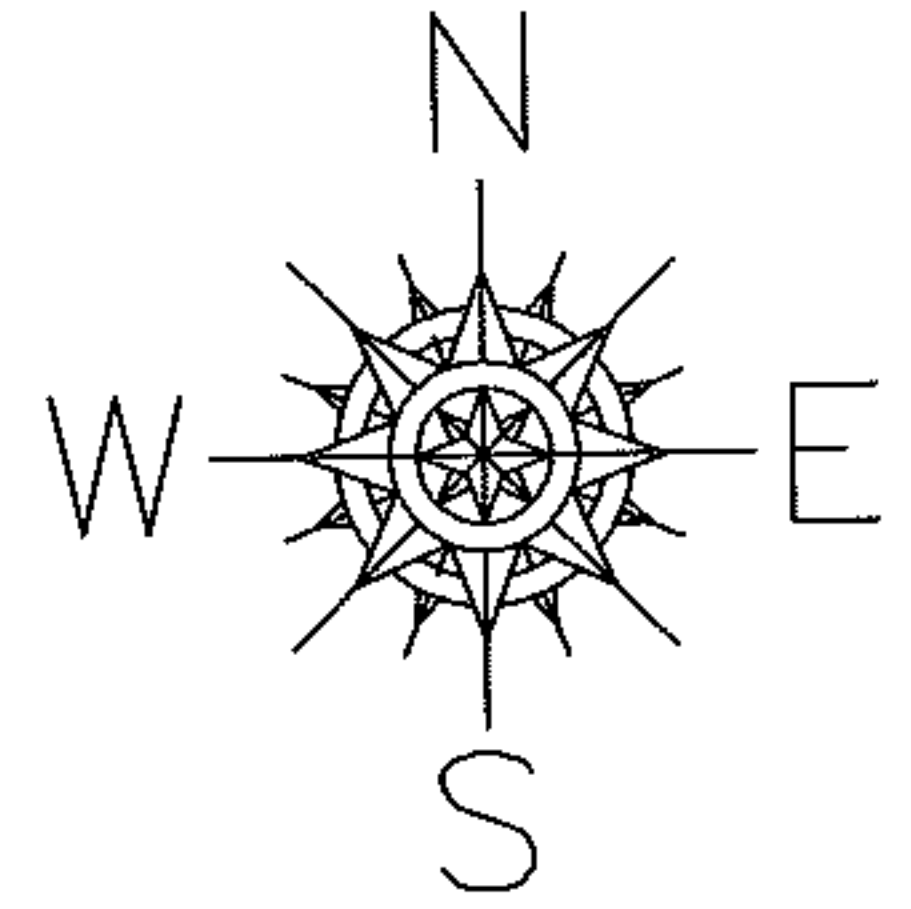

SPLITS/DEEDS PROCESSED
LORAIN COUNTY TAX MAP DEPARTMENT
226 MIDDLE AVE. ELYRIA, OHIO

SURVEYED BY: PHILLIP A. ROSEBECK
CLOSURE: .01:10,000
MAP PAGE(S): 21-G
APPROVED BY: RRM DATE: 11-9-10
SCALE: 1"= 400 PRIOR INST.: 20100342228