

PARENT PARCEL: 02-01-003-230-016

CHILD PARCEL: 02-01-003-230-017, -018

13-02865-X

STARTING POINT: NORTHEAST CORNER OF S/L 396 IN LORAIN STONE CO.'S 2ND SUB. (VOL.6 PG. 37)

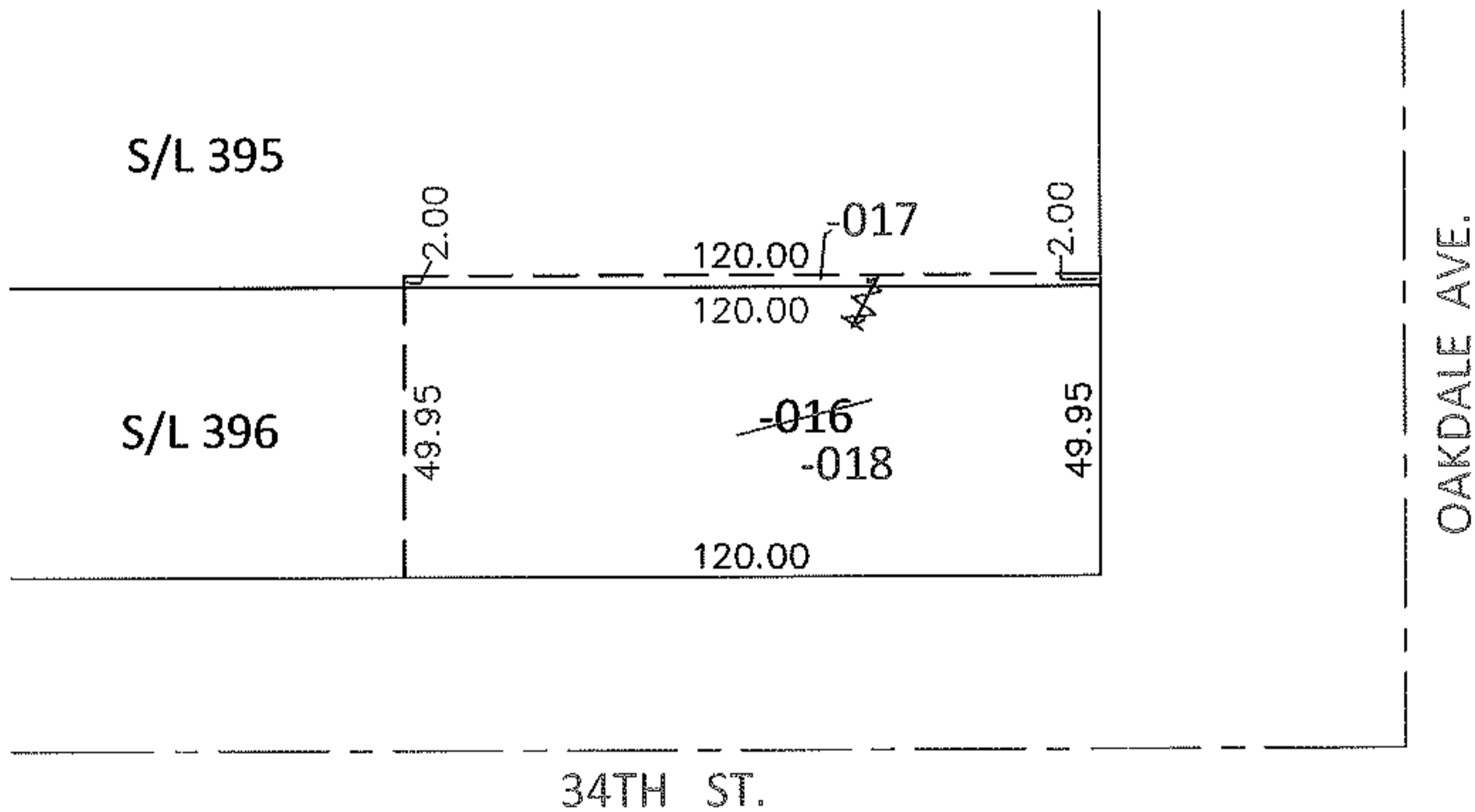
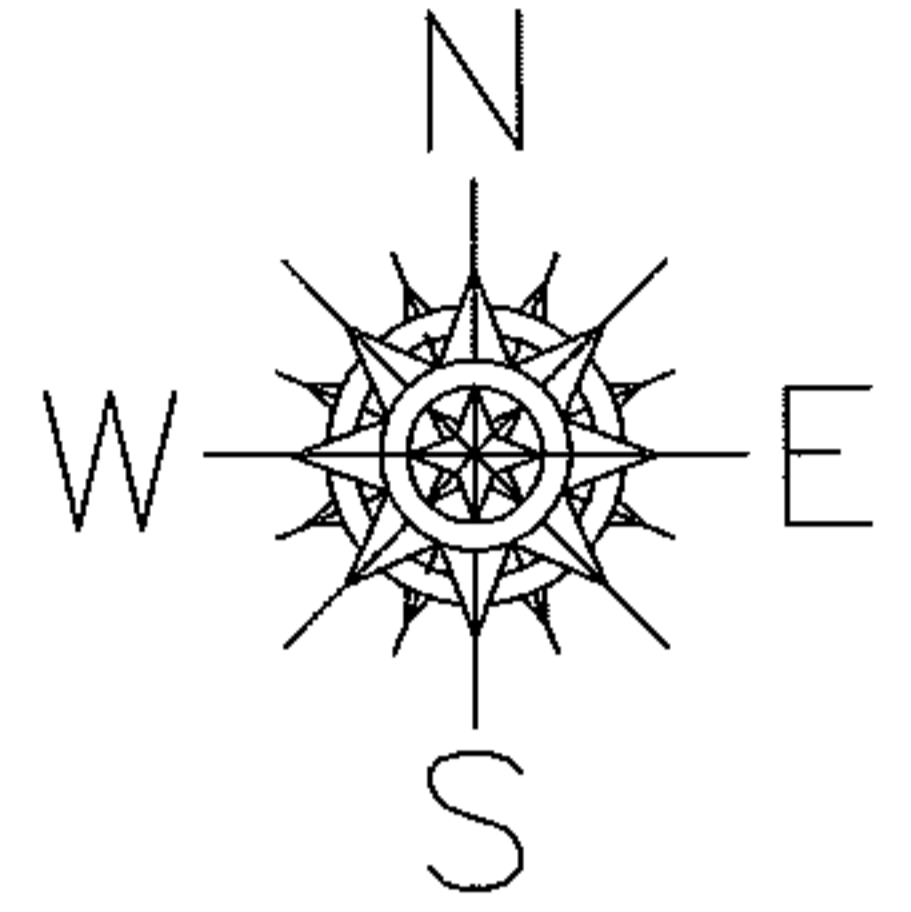

UNCOMBINATION

~~02-01-003-230-016~~

~~51.95 X 120~~

02-01-003-230-017 02-01-003-230-018
2 X 120 49.95 X 120

PER PRIOR DEEDS

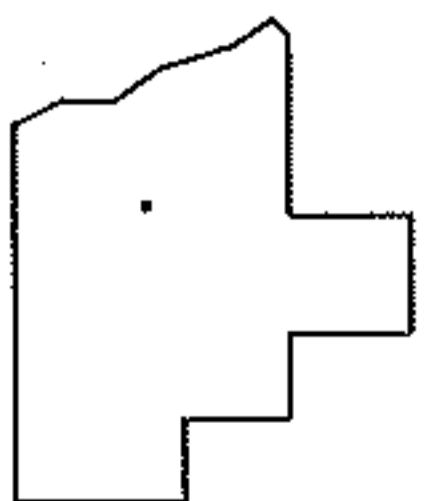

SPLITS/DEEDS PROCESSED

LORAIN COUNTY TAX MAP DEPARTMENT
226 MIDDLE AVE. ELYRIA, OHIO

SURVEYED BY: N/A

CLOSURE: N/A

MAP PAGE(S): 2-01-003-1

APPROVED BY: RRM DATE: 12-19-13

SCALE: 1" = 50' PRIOR INST.: 20050647827