

PARENT PARCEL: 06-25-027-107-031

CHILD PARCEL:

13-02827-D

STARTING POINT: SOUTHWEST CORNER OF S/L 29 IN SHERWOOD MANOR SUB. NO.3(VOL.22 PG.79)

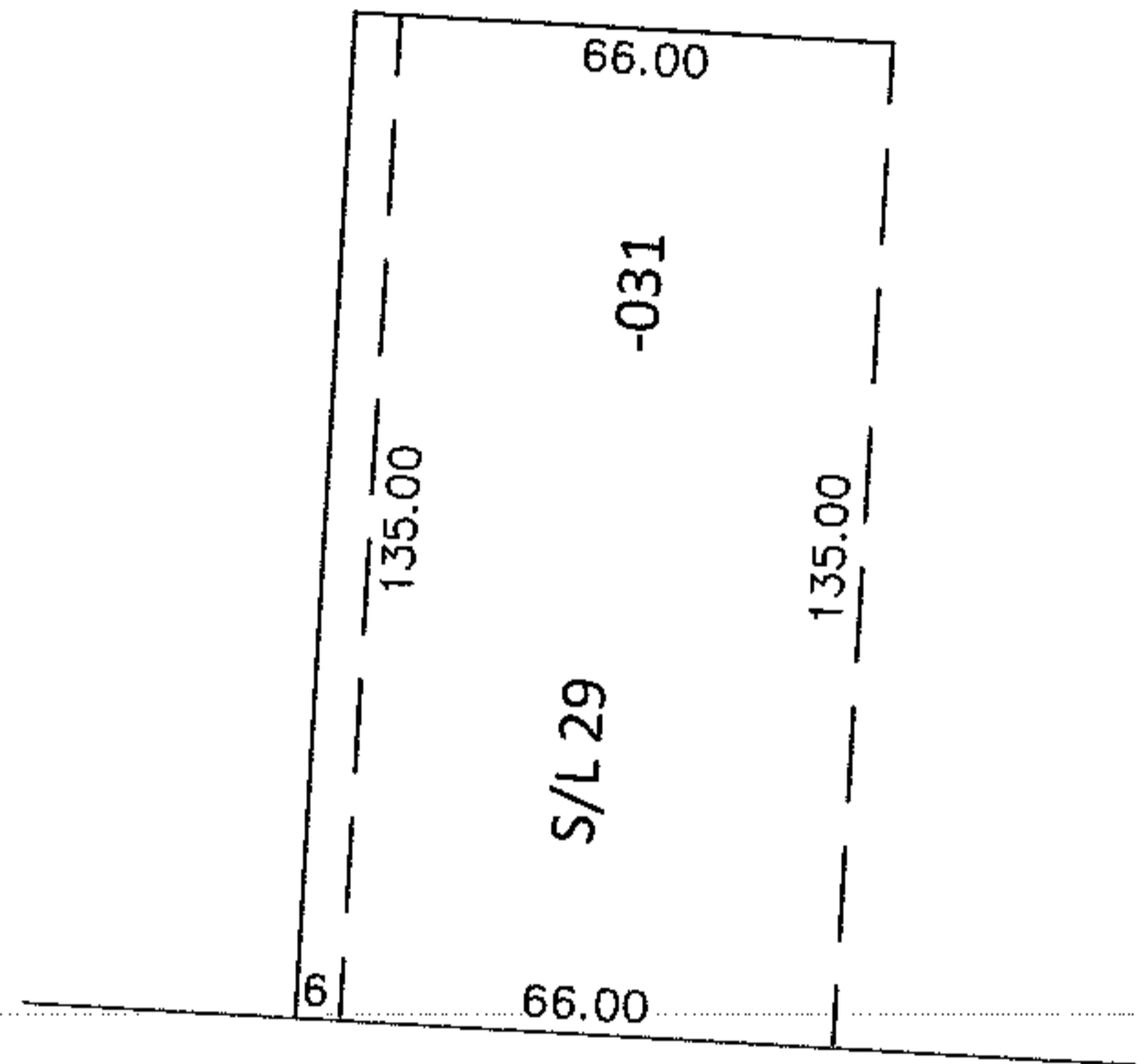
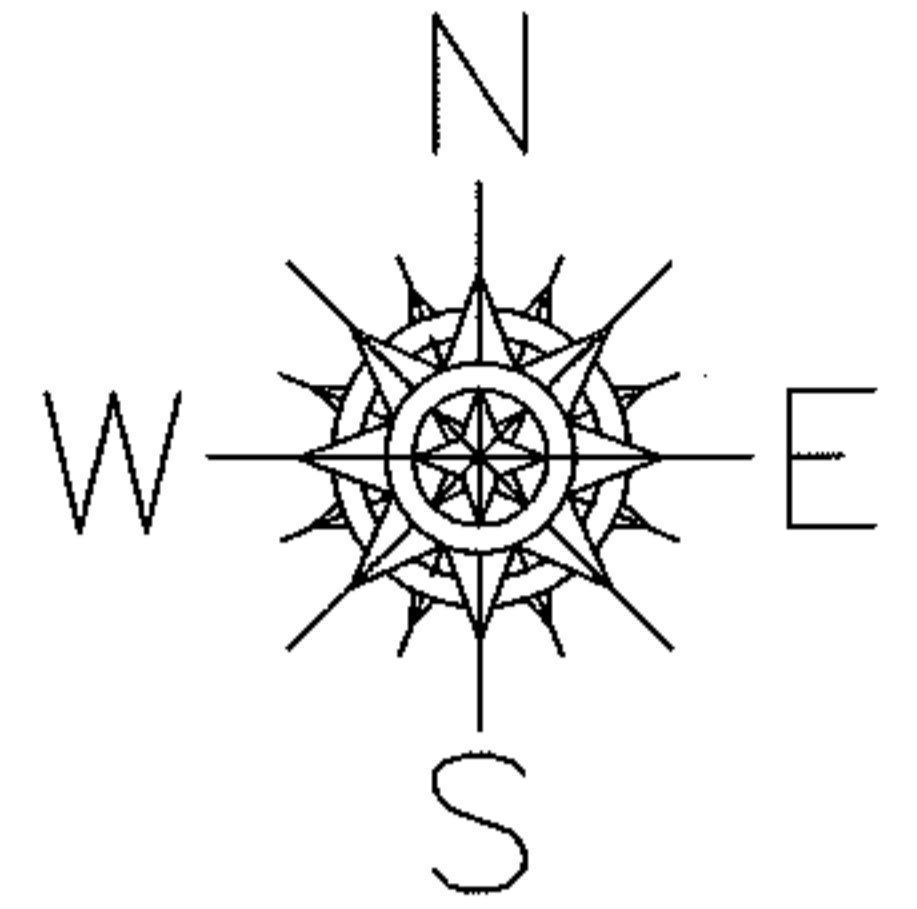

NO MAP CHANGES

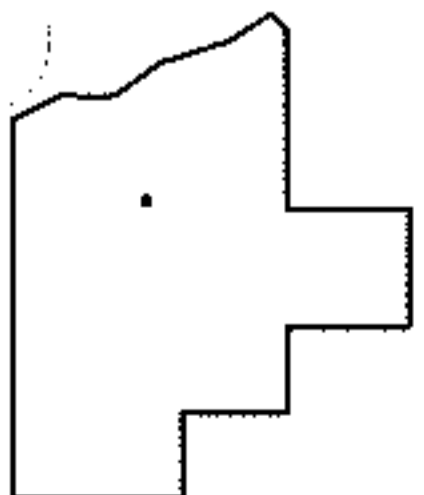

SPLITS/DEEDS PROCESSED

LORAIN COUNTY TAX MAP DEPARTMENT
226 MIDDLE AVE. ELYRIA, OHIO

SURVEYED BY: JAMES P. YURKSCHATT

CLOSURE: .00:10,000

MAP PAGE(S): 6-53

APPROVED BY: RRM DATE: 10-22-13

SCALE: 1"= 50' PRIOR INST.: 20060183191