

PARENT PARCEL: 14-00-108-000-002

CHILD PARCEL: 14-00-108-000-003, -004

STARTING POINT: CENTERLINE OF WHITNEY RD & PITTS RD

10-02803

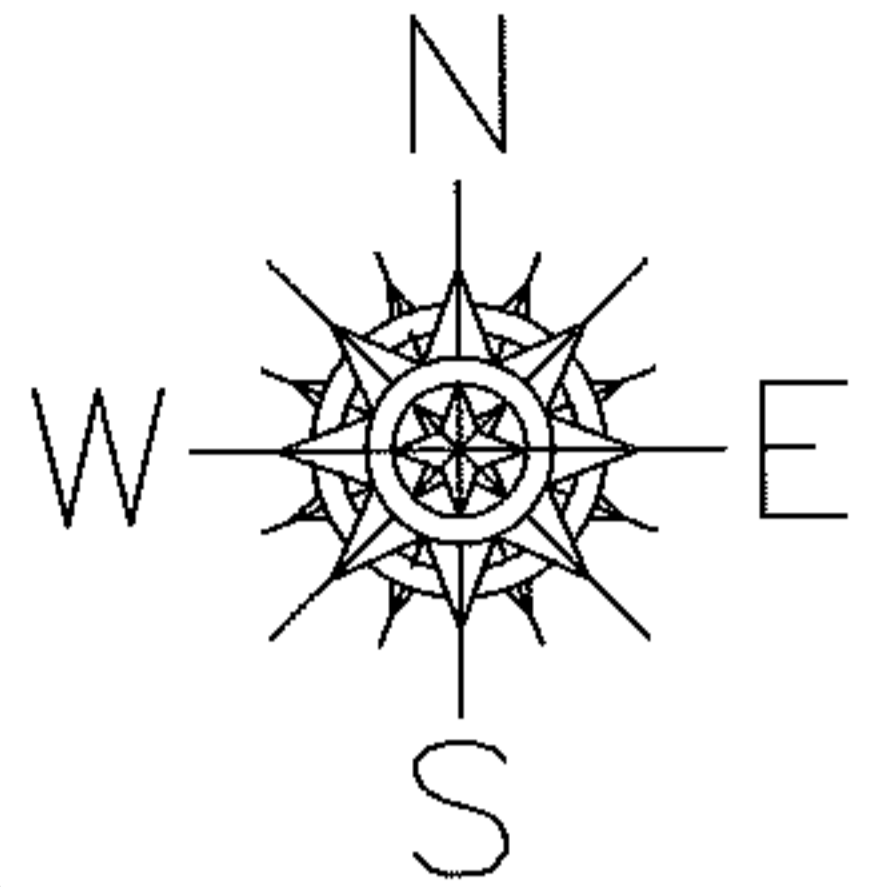

~~002~~
~~83.00 A.~~
~~83.75 A. CORR PER DEED~~
~~004~~
81.33 A.

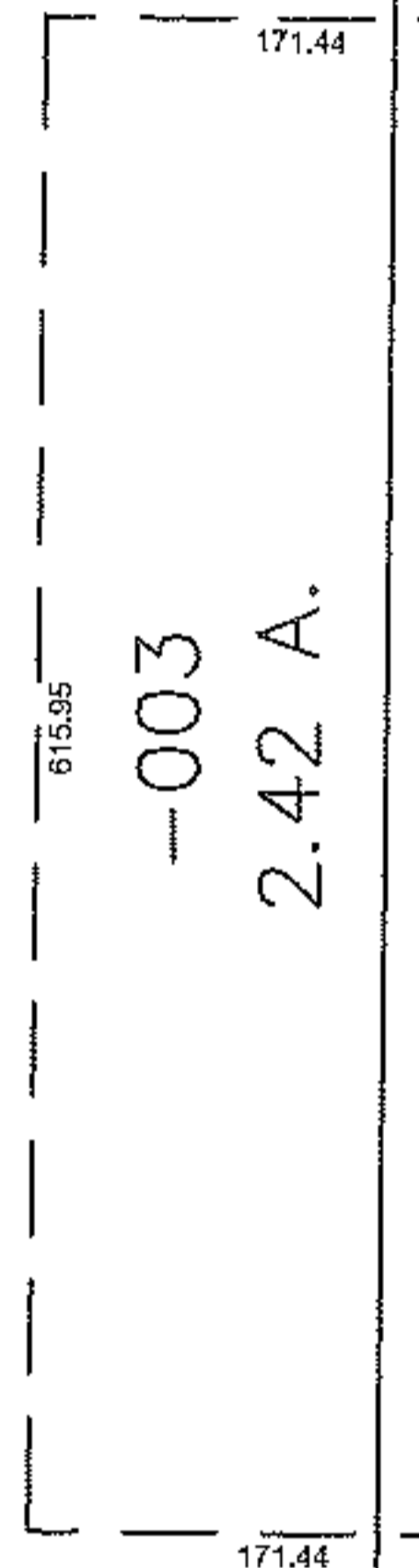

RD

PITTS

WHITNEY RD

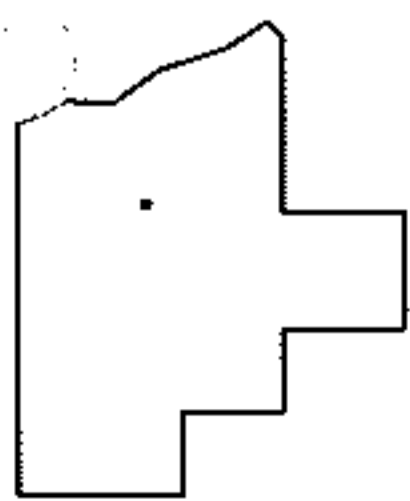

SPLITS/DEEDS PROCESSED
LORAIN COUNTY TAX MAP DEPARTMENT
226 MIDDLE AVE. ELYRIA, OHIO

SURVEYED BY: RICHARD CARLSON
CLOSURE: 0.00 : 10,000
MAP PAGE(S): 14-00-108-A, B
APPROVED BY: JAH DATE: 2-18-10
SCALE: 1" = 200 PRIOR INSTRUMENT: DV 1278/801