

PARENT PARCEL: 06-22-009-103-033

CHILD PARCEL: _____

13-02802-D

STARTING POINT: SOUTHWEST CORNER OF S/L 22 IN GREENFIELD ESTATES (VOL.28 PG.17)

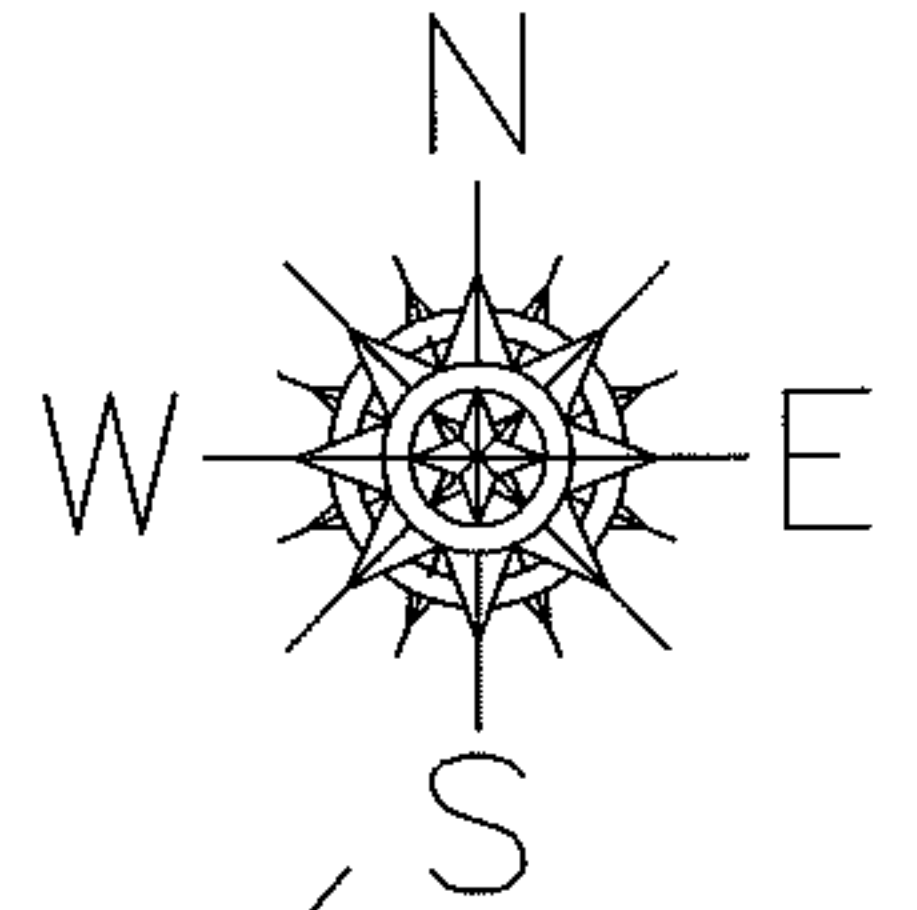

NO MAP CHANGES

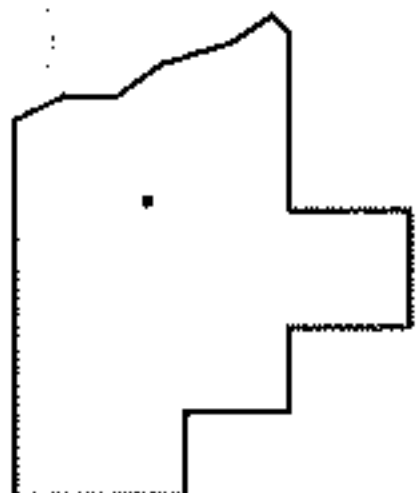
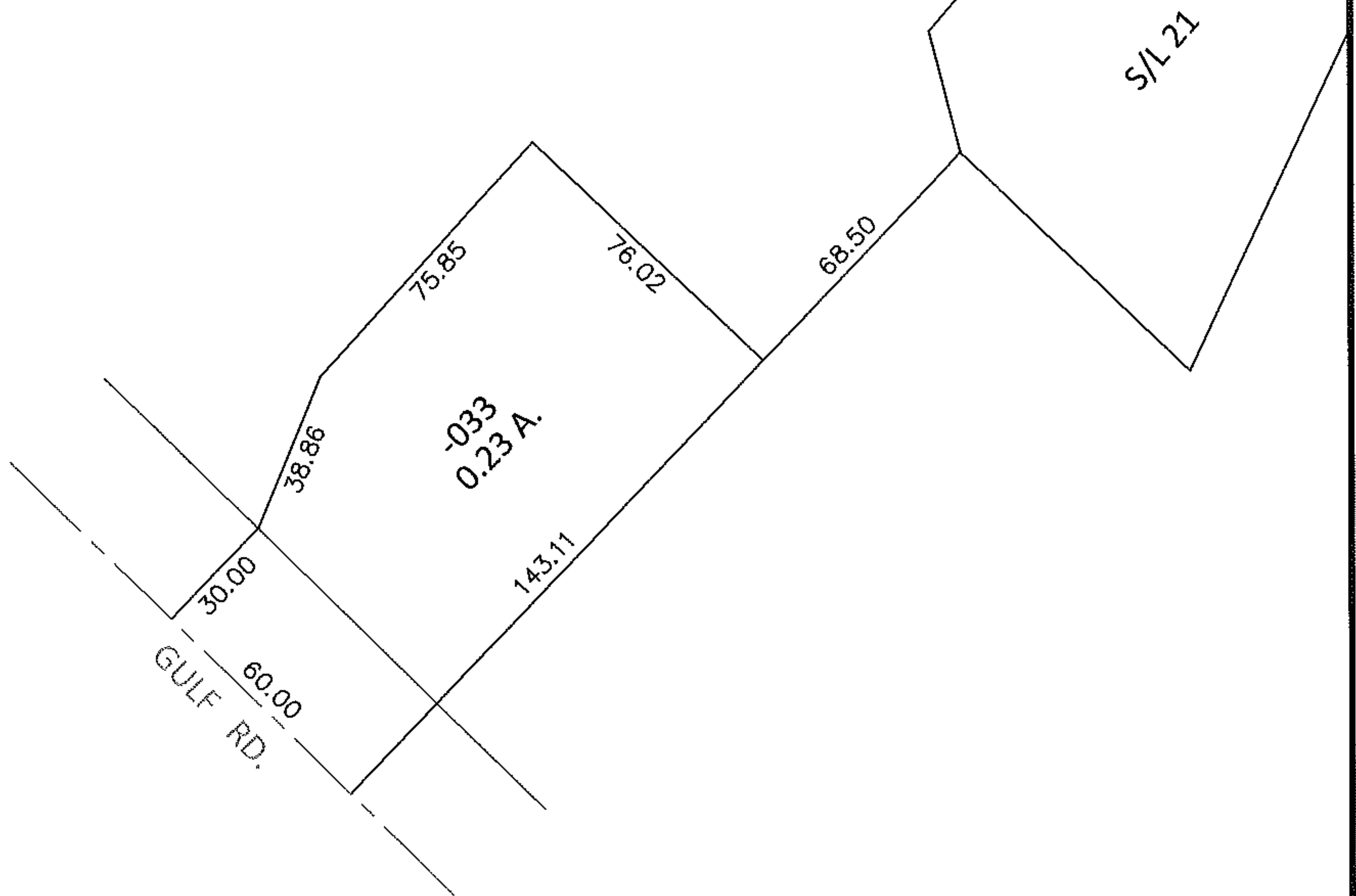

SPLITS/DEEDS PROCESSED

LORAIN COUNTY TAX MAP DEPARTMENT
226 MIDDLE AVE. ELYRIA, OHIO

SURVEYED BY: DALE R. HAYWOOD

CLOSURE: .01:10,000

MAP PAGE(S): 6-14

APPROVED BY: RRM DATE: 9-17-13

SCALE: 1" = 50' PRIOR INST.: 20130455193