

PARENT PARCEL: 06-24-123-000-011

CHILD PARCEL: 06-24-123-000-023, -024

STARTING POINT: S/L 8 IN TATTERSAL'S SUB. NO.1 (VOL.7 PG.26)

13-02801-U

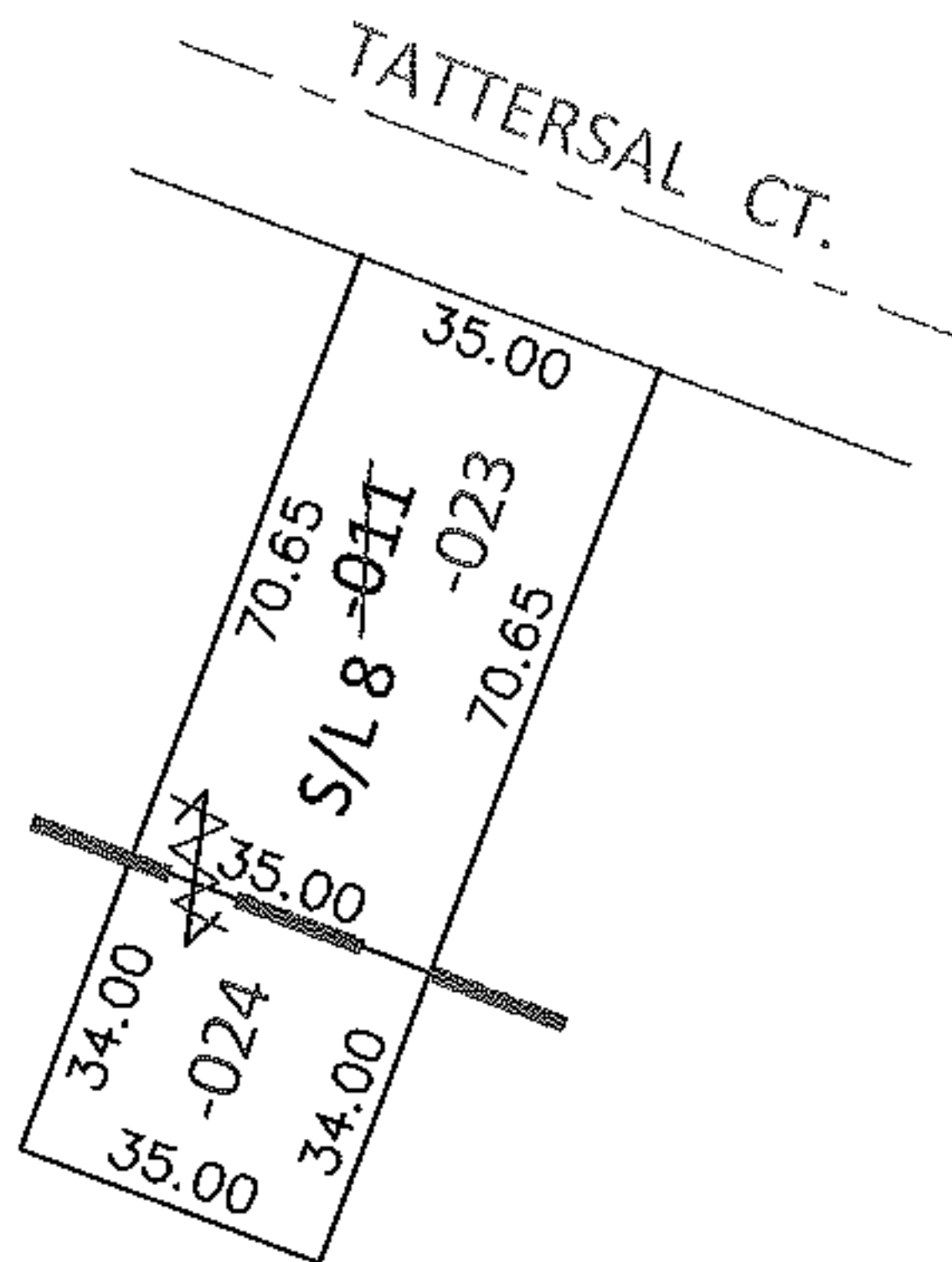
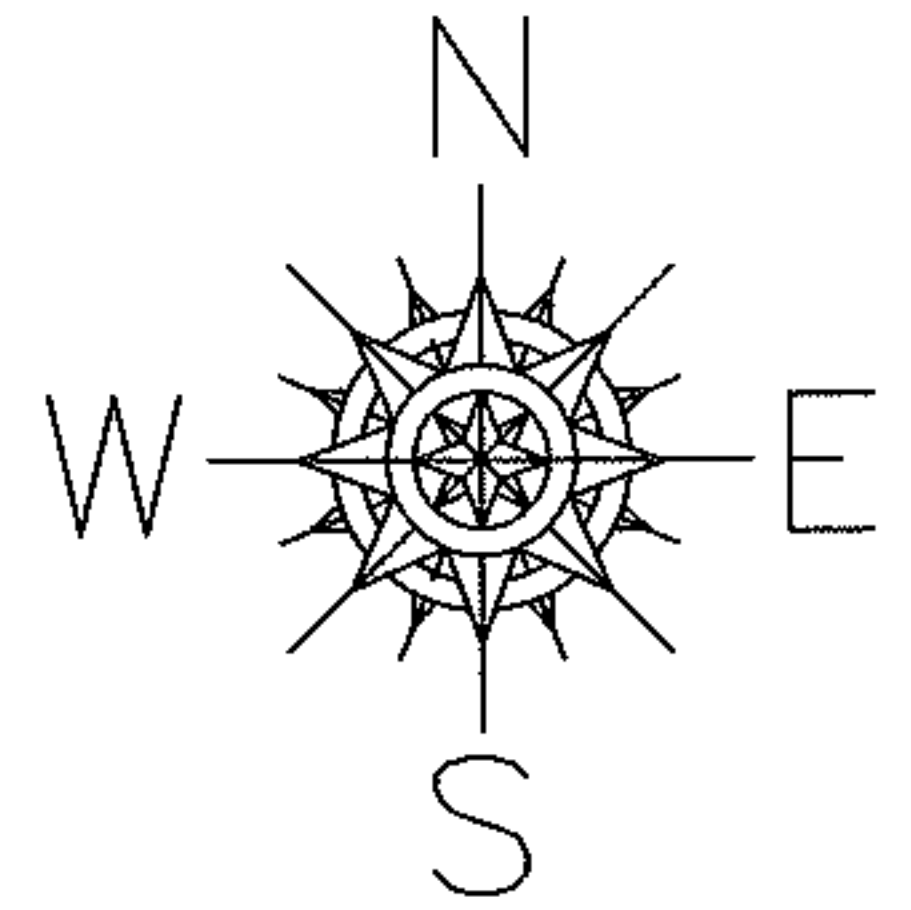

UNCOMBINATION

~~06-24-123-000-011~~  
~~35 X 71~~

06-24-123-000-023  
35 X 70.65

06-24-123-000-024  
35 X 34

PER PRIOR DEEDS  
TO REMOVE UPDATE LEGAL  
FOR 2 LEGALS, 1 PARCEL NO.

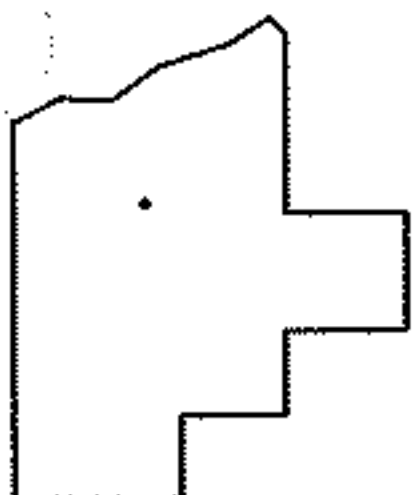

SPLITS/DEEDS PROCESSED

LORAIN COUNTY TAX MAP DEPARTMENT  
226 MIDDLE AVE. ELYRIA, OHIO

SURVEYED BY: N/A

CLOSURE: N/A

MAP PAGE(S): 6-100

APPROVED BY: RRM DATE: 9-17-13

SCALE: 1"= 50' PRIOR INST.: 20120427744