

PARENT PARCEL: 06-22-009-103-033

CHILD PARCEL: \_\_\_\_\_

13-02784-D

STARTING POINT: SOUTHWEST CORNER OF S/L 21 IN GREENFIELD ESTATES (VOL. 28 PG.17)

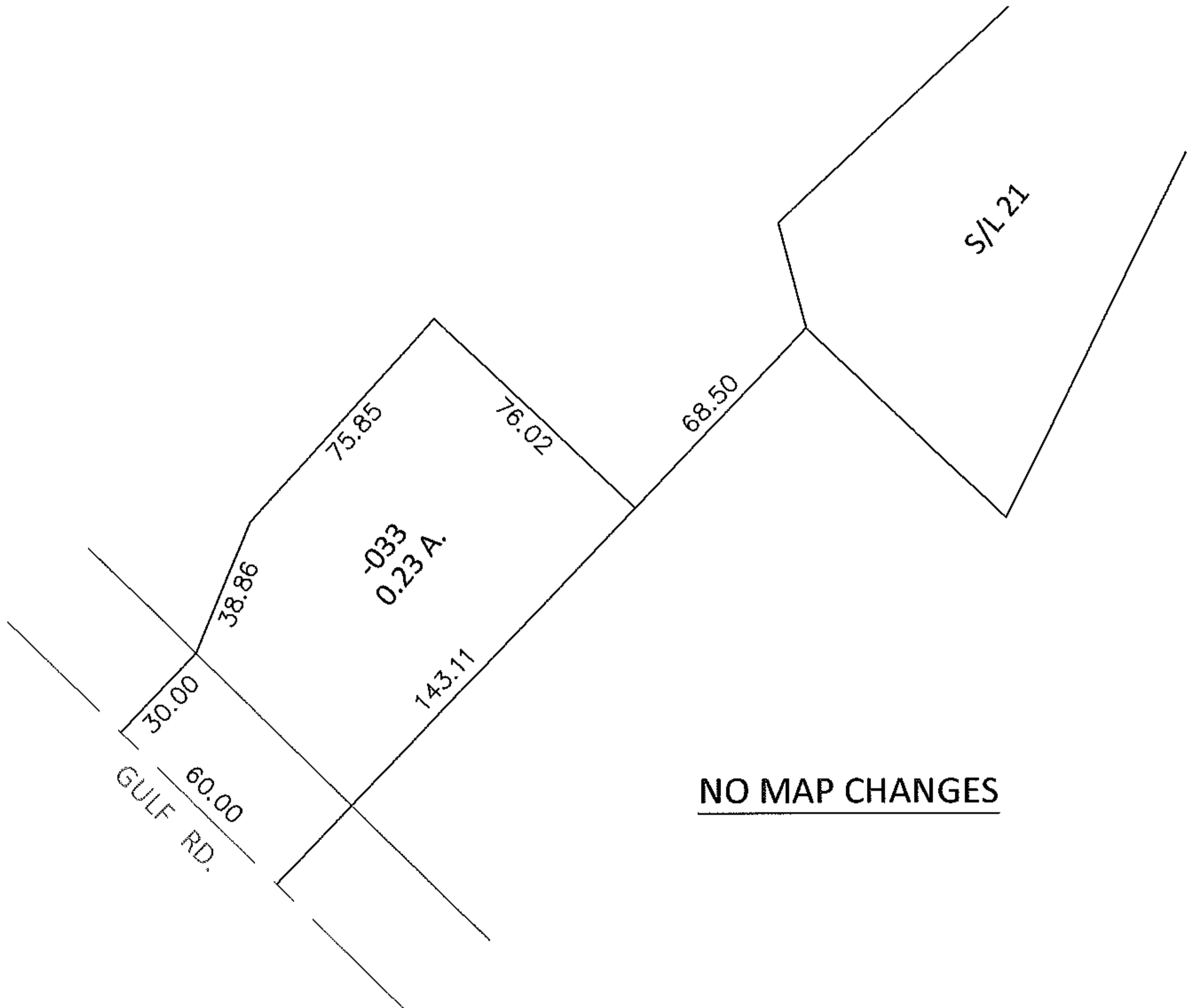
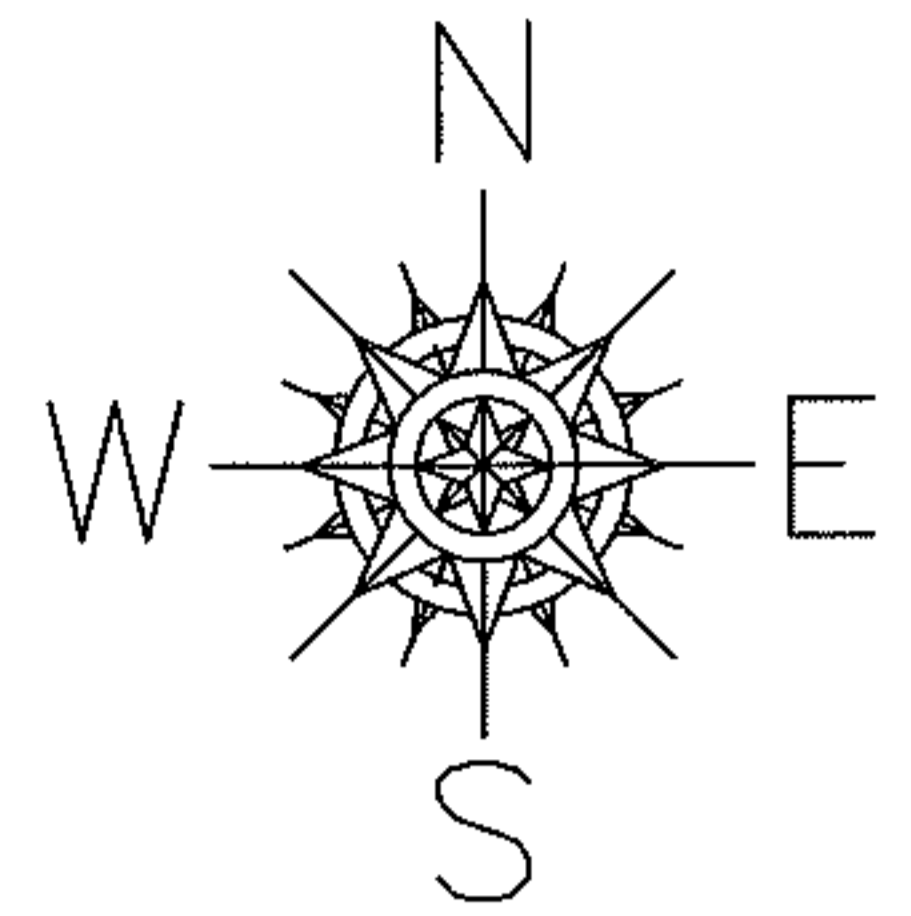

NO MAP CHANGES

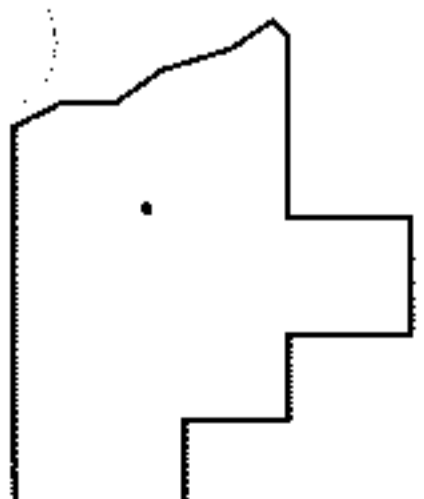

SPLITS/DEEDS PROCESSED

LORAIN COUNTY TAX MAP DEPARTMENT  
226 MIDDLE AVE. ELYRIA, OHIO

SURVEYED BY: DALE R. HAYWOOD

CLOSURE: .01:10,000

MAP PAGE(S): 6-14

APPROVED BY: RRM DATE: 8-21-13

SCALE: 1"= 50' PRIOR INST.: 20130455193