

PARENT PARCEL: 06-24-067-103-004, -005

CHILD PARCEL: 06-24-067-103-011, -012, -004

13-02711-U

STARTING POINT: S/L'S 1 AND 2 IN BLOCK 7 OF ELY AND BOYNTON'S 1ST ADD.(VOL.4 PG.44)

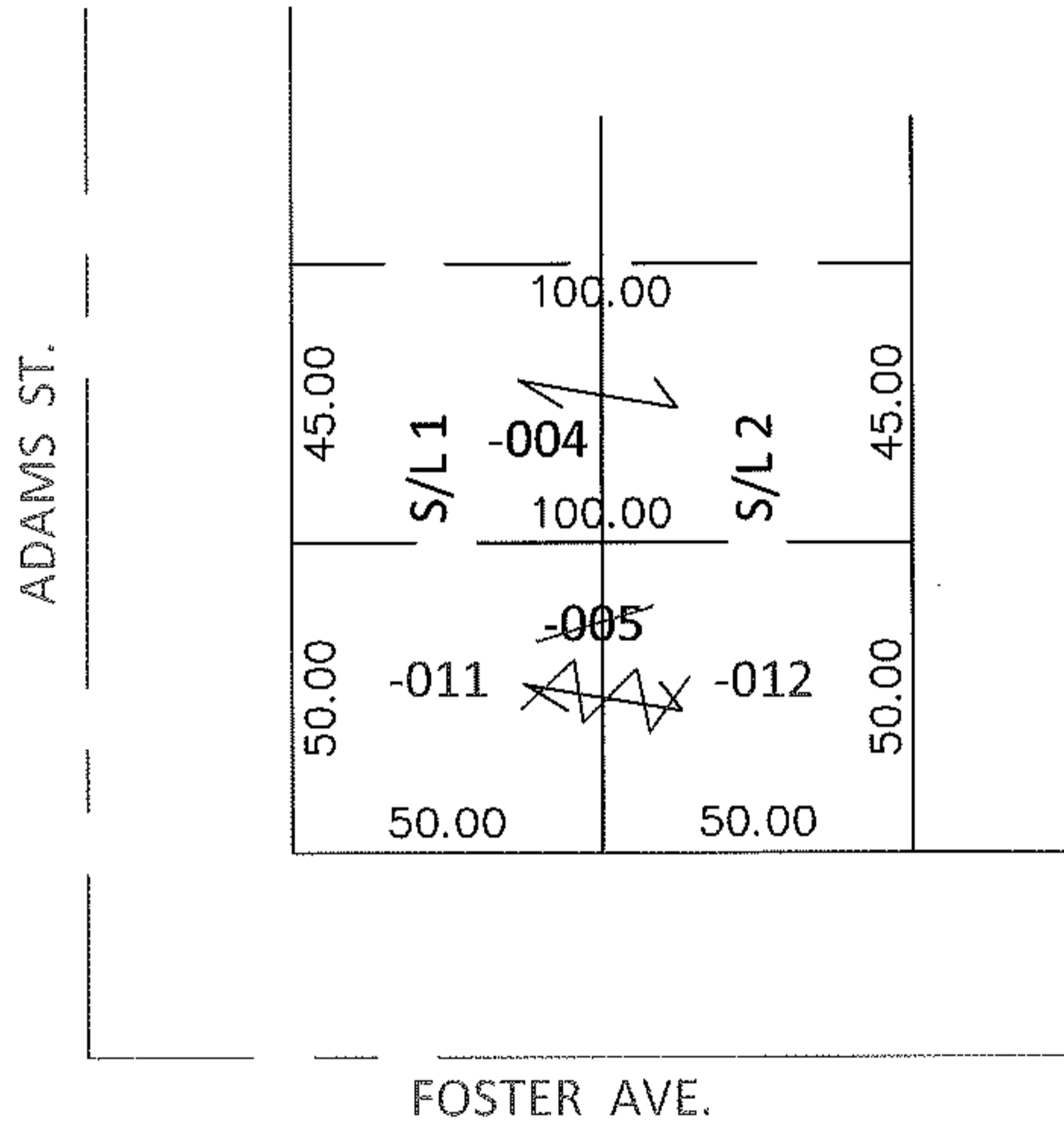
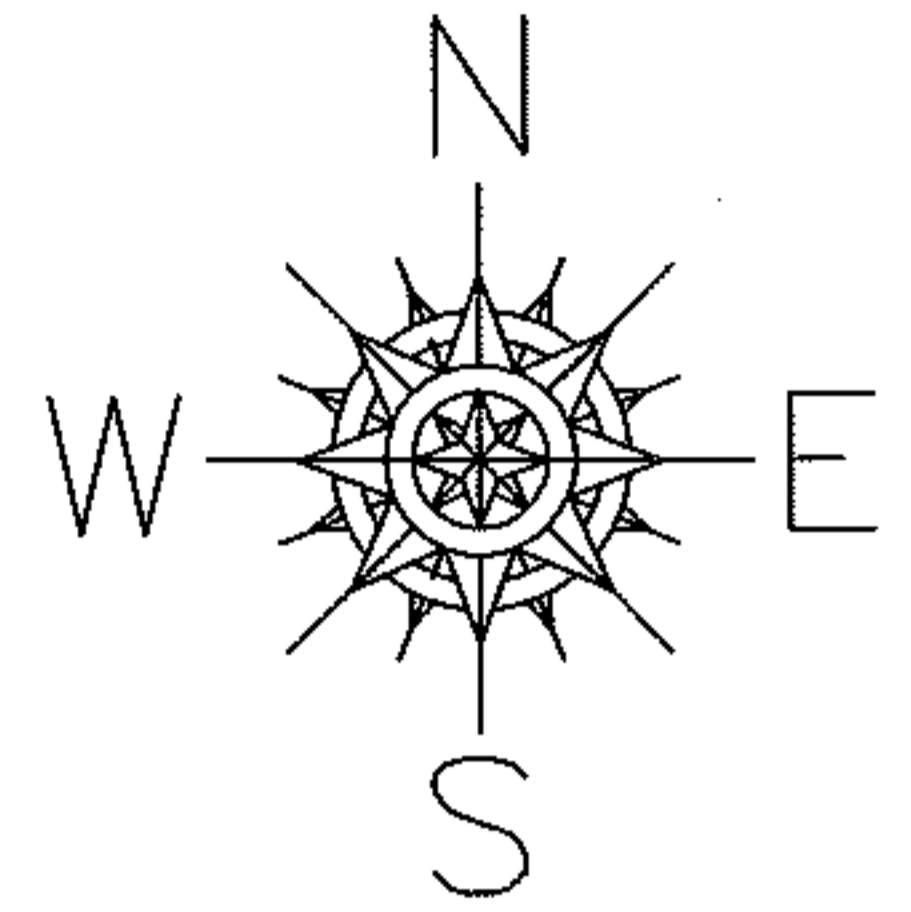

UNCOMBINATION

~~06-24-067-103-005~~

~~50 X 100~~

06-24-067-103-011 06-24-067-103-012
50 X 50 50 X 50

PER PRIOR DEEDS
TO CORRECT 2 LEGALS, 1 PARCEL NO.

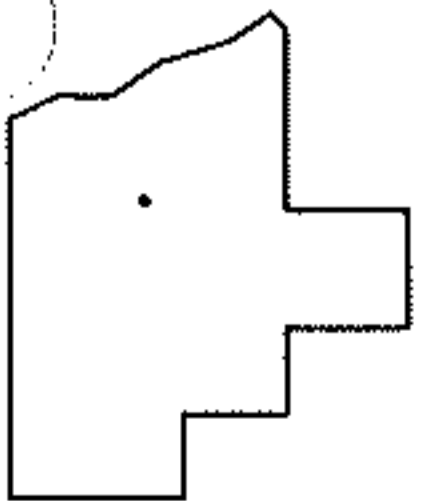

SPLITS/DEEDS PROCESSED

LORAIN COUNTY TAX MAP DEPARTMENT
226 MIDDLE AVE. ELYRIA, OHIO

SURVEYED BY:	N/A
CLOSURE:	N/A
MAP PAGE(S):	6-81
APPROVED BY:	RRM DATE: 4-23-13
SCALE:	1" = 50' PRIOR INST.: 19980585690