

PARENT PARCEL: 04-00-009-000-089, -097

CHILD PARCEL: 04-00-009-000-166

13-02660-C

STARTING POINT: INTERSECTION OF C/L OF CHESTER RD. AND NORTHEAST CORNER OF LAND CONYED TO HERBERT L. BRANDT(DV 741/580)

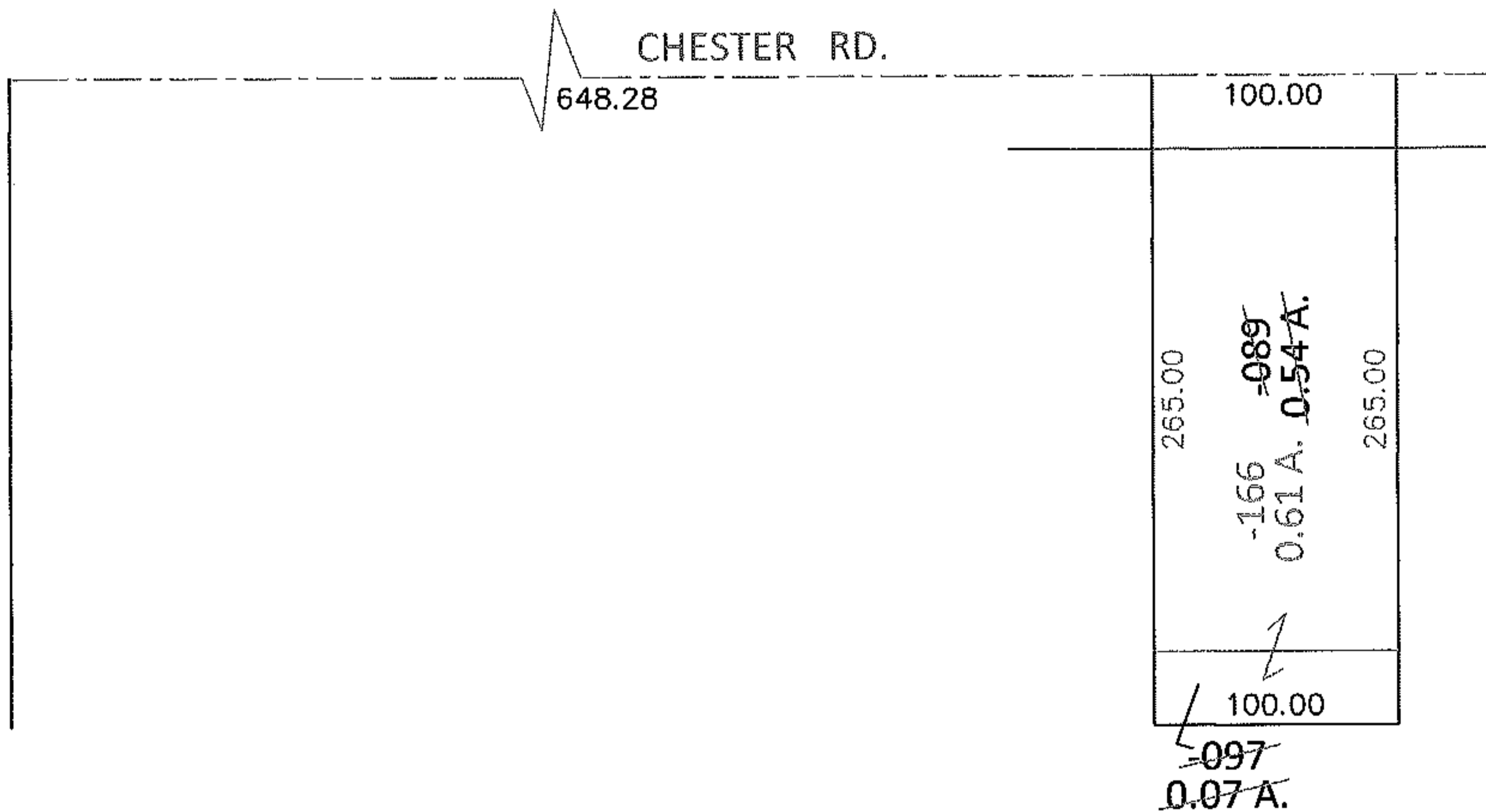
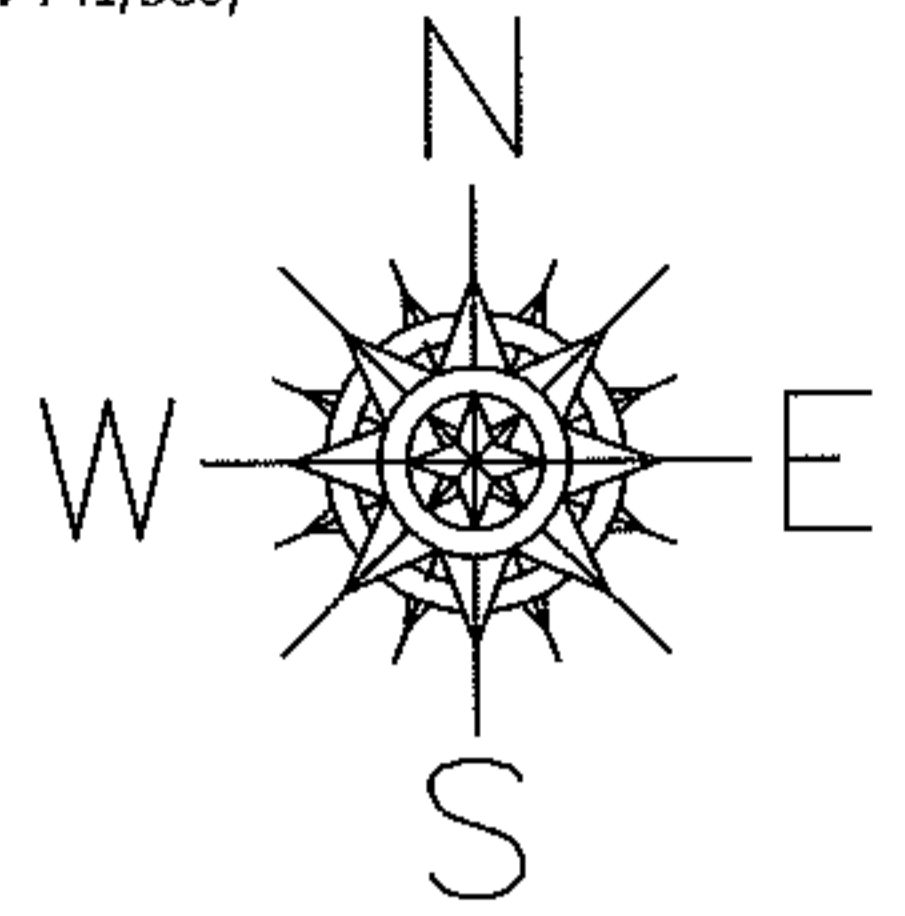

COMBINATION
 PER PRIOR DEEDS
 TO REMOVE UPDATE LEGAL FOR 1 LEGAL, 2 PARCEL NOS.

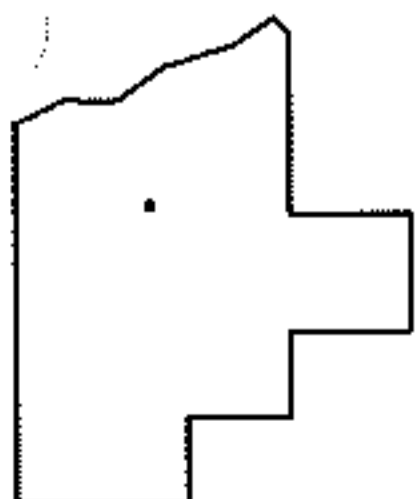

SPLITS/DEEDS PROCESSED
 LORAIN COUNTY TAX MAP DEPARTMENT
 226 MIDDLE AVE. ELYRIA, OHIO

SURVEYED BY: N/A
 CLOSURE: .00:10,000
 MAP PAGE(S): 4-00-009-H
 APPROVED BY: RRM DATE: 2-6-13
 SCALE: 1"= 100 PRIOR INST.: 20120427295