

PARENT PARCEL: 17-07-017-000-011, -012, -013, -014
LD PARCEL: 17-07-017-000-038
STARTING POINT: CL OF MEDINA-NORWALK RD. (S.R.18) & CL OF ASHLAND-KIPTON RD. (S.R. 511)

09-02657

MEDINA-NORWALK RD. (S.R. 18) 80'

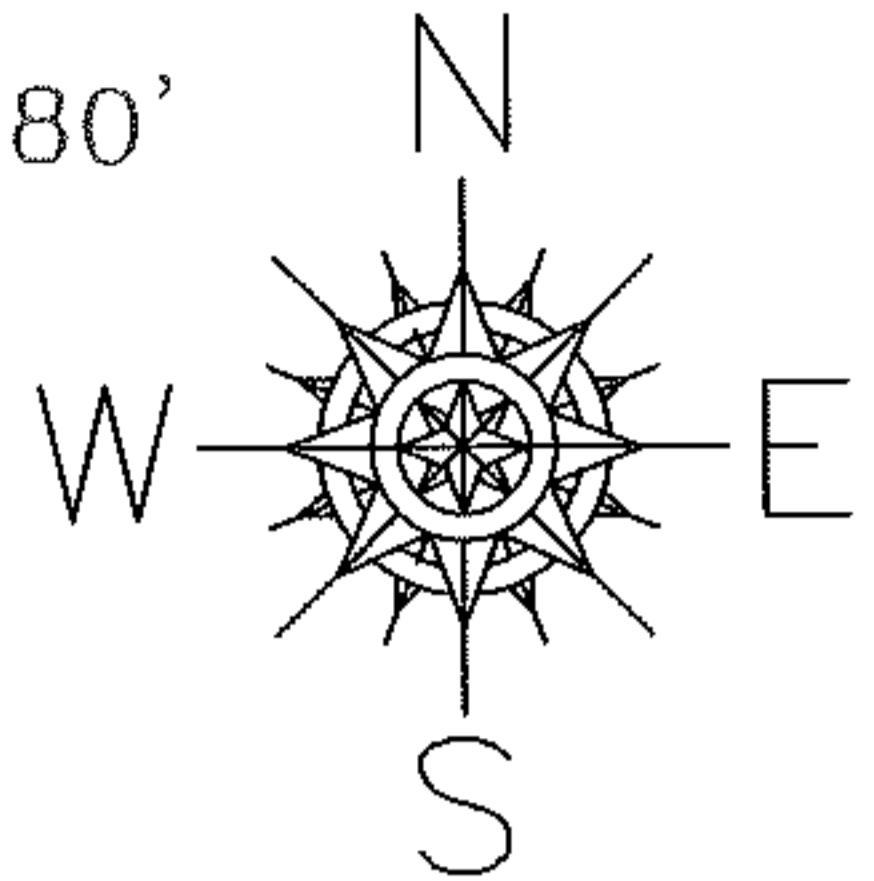

BEGINNING

BOUNDARY
CORRECTION & COMBINATION

~~17-07-017-000-011~~

~~1.50 A.~~

~~17-07-017-000-012~~

~~0.11 A.~~

~~17-07-017-000-013~~

~~0.81 A.~~

~~17-07-017-000-014~~

~~0.50 A.~~

17-07-017-000-038

~~2.92 A.~~

3.89 A.

CORR. PER SURV.

K. CARNEY (L.C. ENGINEERS)

936.80
ASHLAND - KIPTON RD. (S.R. 511) 60'
569.65

MUTUALLY AGREED
UPON BOUNDARY
CORRECTION OF
BRIGHTON CEMETERY
(ROY GREENE & BRIGHTON
TWP. TRUSTEES)
MEMORANDUM OF UNDERSTANDING
DEC. 4, 2008

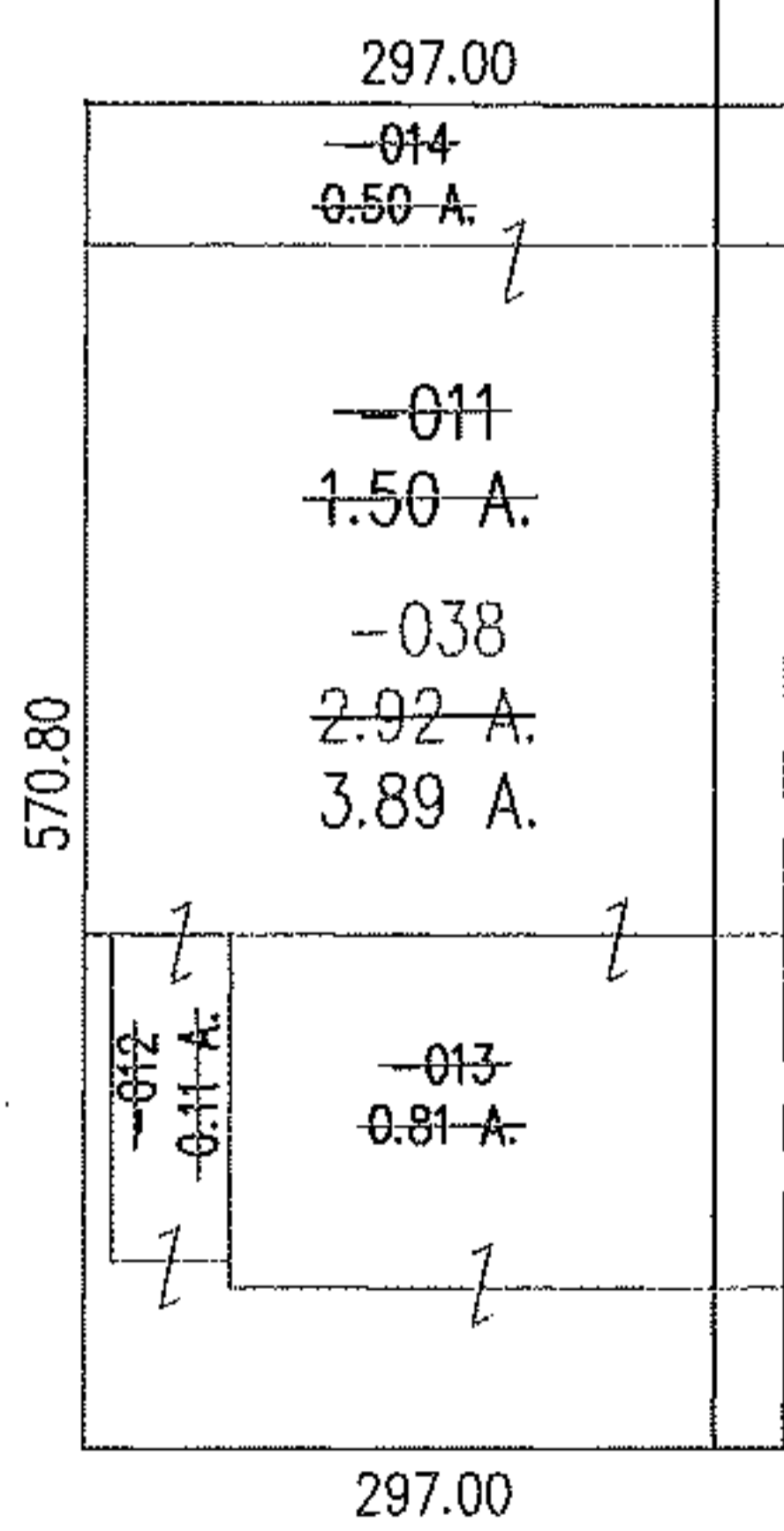

PRIOR INST.: DV 807/268
PRIOR INST.: DV Y / 471
PRIOR INST.: DV 807/268

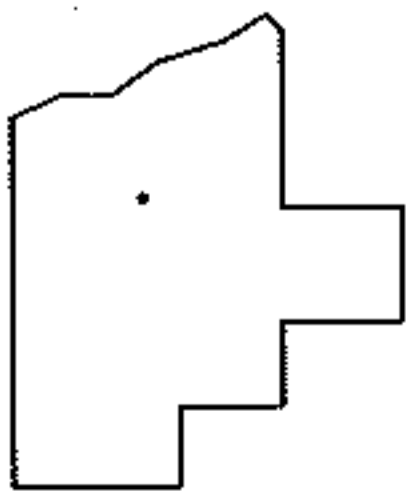

SPLITS/DEEDS PROCESSED

LORAIN COUNTY TAX MAP DEPARTMENT
226 MIDDLE AVE. ELYRIA, OHIO

SURVEYED BY: KEN CARNEY (L.C. ENGINEERS)
CLOSURE: 1 : 327637
MAP PAGE(S): 17-07-017-A
APPROVED BY: TJS DATE: 1/14/09
SCALE: 1" = 200