

PARENT PARCEL: 04-00-007-143-010

CHILD PARCEL: 04-00-007-143-033, -034

STARTING POINT: PART OF S/L 240 AND ALL OF S/L 239 IN BELMAR BEACH SUB.(VOL.12 PG.1)

12-02629-U

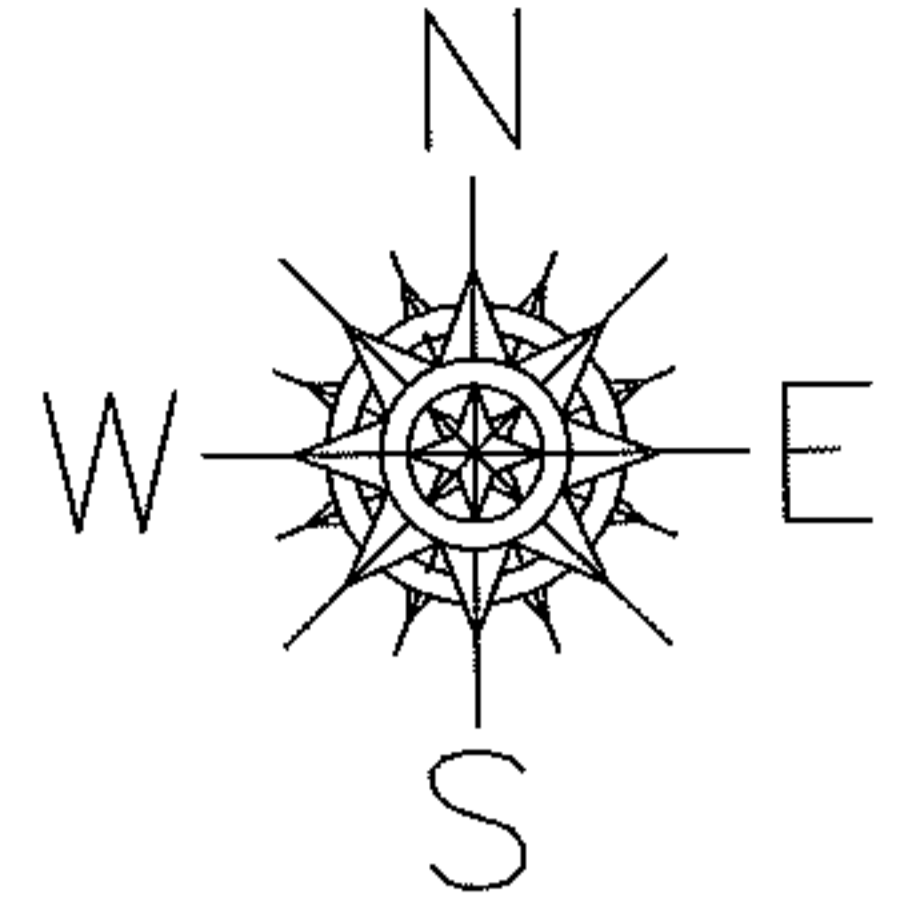

BELMAR BLVD.

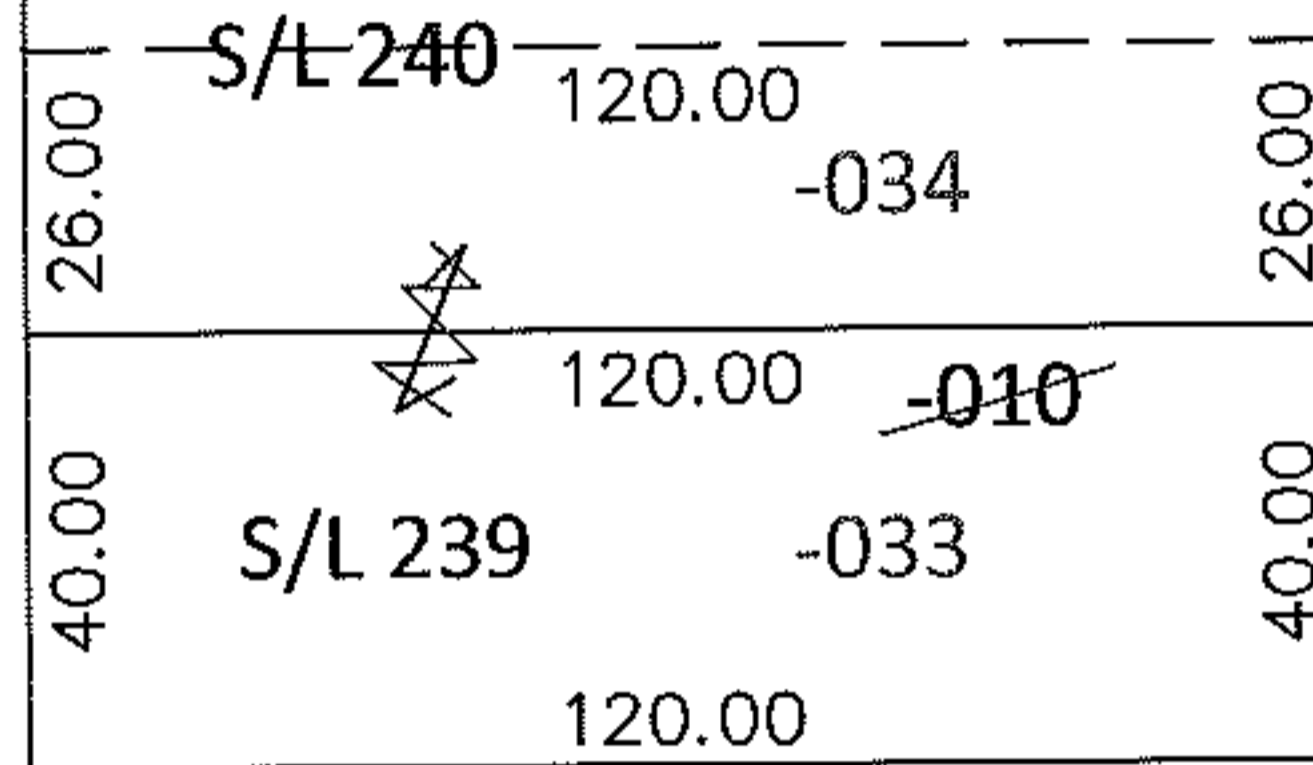

UNCOMBINATION

04-00-007-143-010
66 X 120

04-00-007-143-033 04-00-007-143-034
40 X 120 26 X 120

PER PRIOR DEEDS
TO REMOVE UPDATE LEGAL FOR 2 LEGALS, 1 PARCEL NO.

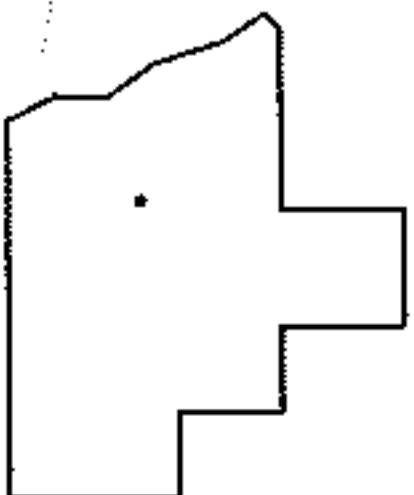

SPLITS/DEEDS PROCESSED

LORAIN COUNTY TAX MAP DEPARTMENT
226 MIDDLE AVE. ELYRIA, OHIO

SURVEYED BY: N/A
CLOSURE: N/A
MAP PAGE(S): 4-00-007-F
APPROVED BY: RRM DATE: 12-4-12
SCALE: 1"= 50' PRIOR INST.: 20080269363