

RABVER

PARENT PARCEL: 06-23-001-103-017

12-02571-D

CHILD PARCEL:

STARTING POINT: INTERSECTION OF C/L OF DELLEFIELD RD. AND EAST LINE OF TR.23 O.L.1

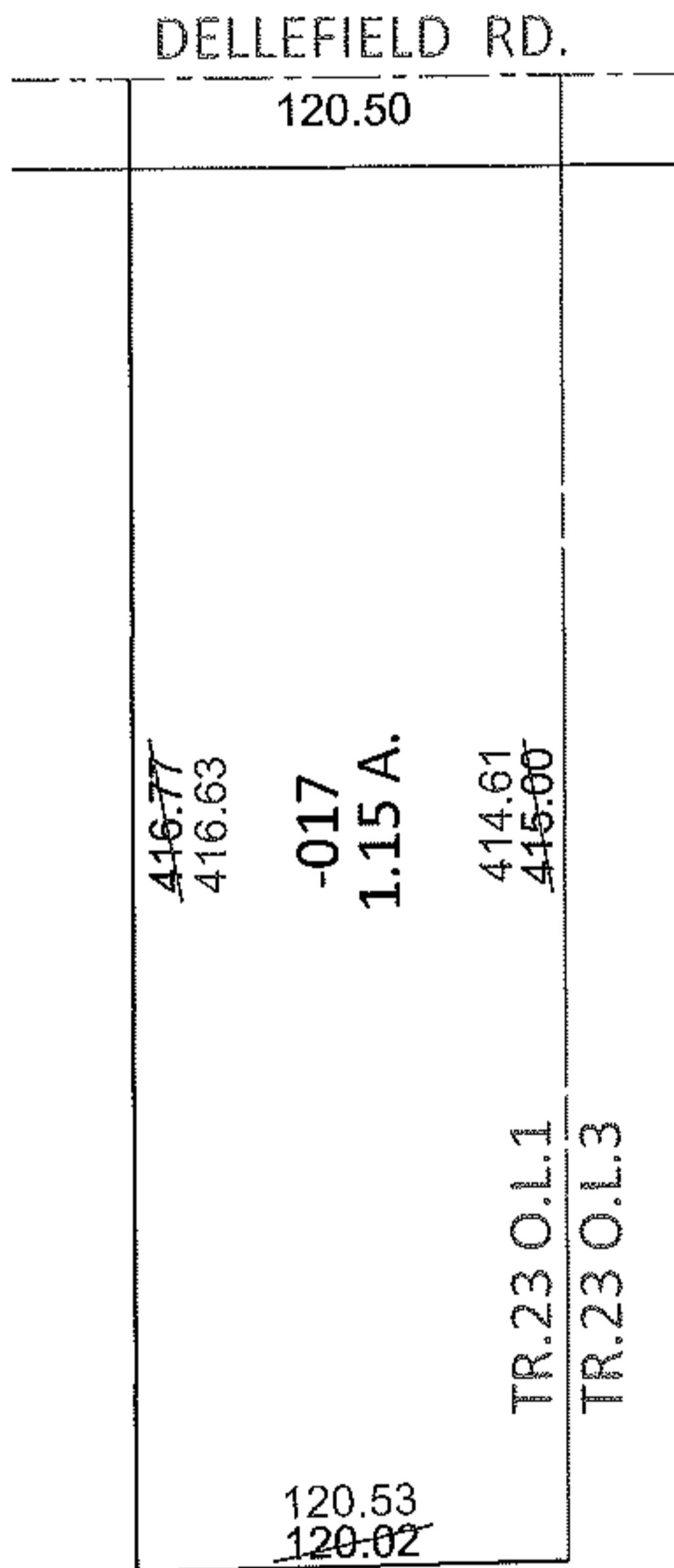
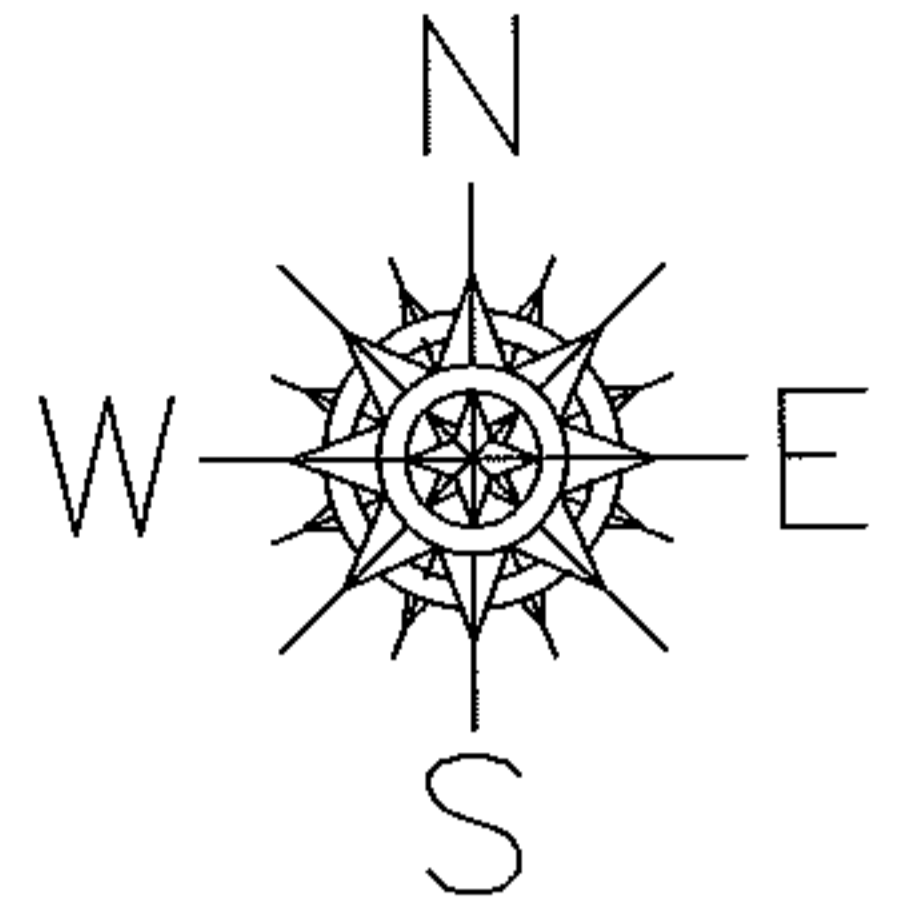

MAP CORRECTION ONLY

PER SURV. T.SIMON

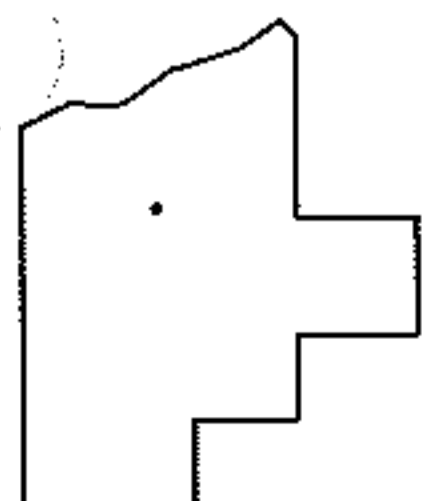

SPLITS/DEEDS PROCESSED

LORAIN COUNTY TAX MAP DEPARTMENT
226 MIDDLE AVE. ELYRIA, OHIO

SURVEYED BY: THOMAS A. SIMON

CLOSURE: .01:10,000

MAP PAGE(S): 6-20

APPROVED BY: RRM DATE: 9-4-12

SCALE: 1"= 100 PRIOR INST.: 20110363021