

PARENT PARCEL: 03-00-107-101-043

CHILD PARCEL: _____

12-02559-D

STARTING POINT: AT A MON BOX AT THE INTERSECTION OF C/L OF ELYRIA AVE. AND C/L OF DUNTON RD.

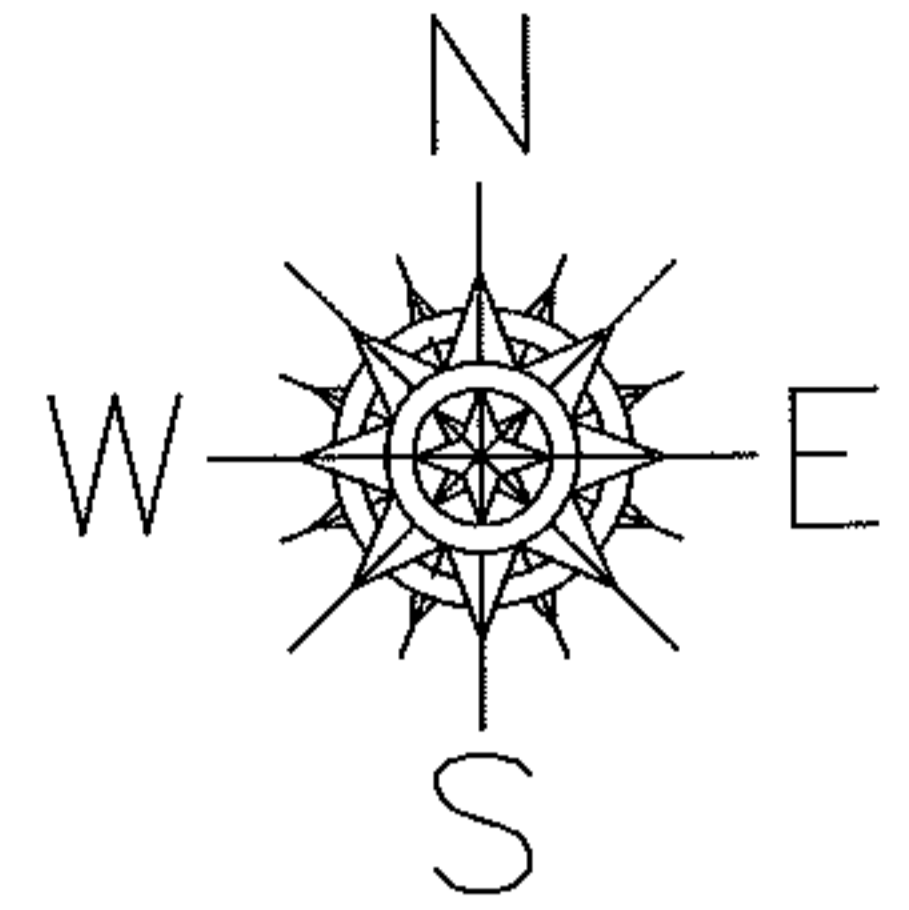
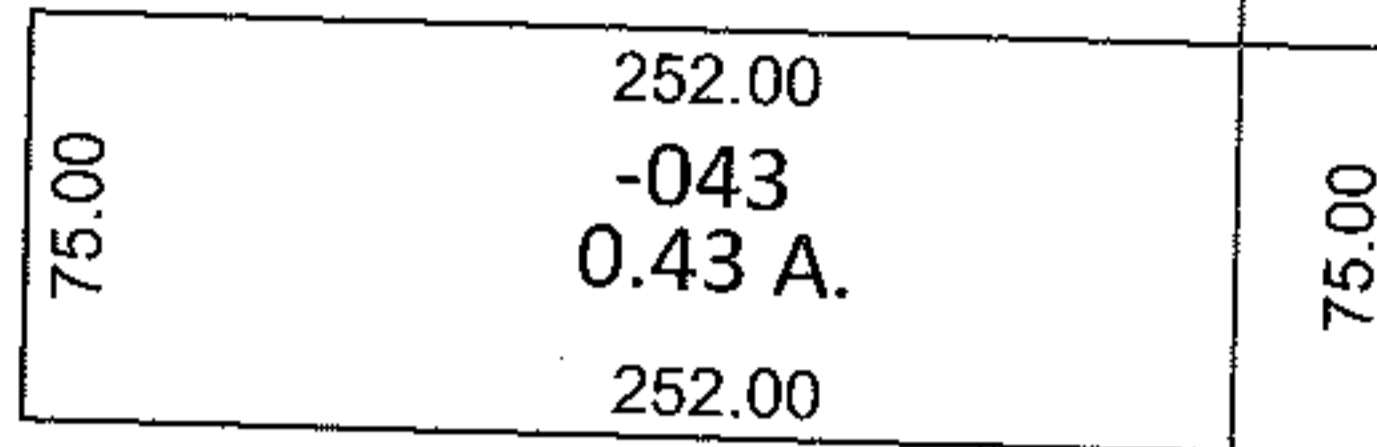

DUNTON RD.

1609.80

ELYRIA AVE.

REMOVE UPDATE LEGAL

2 LEGALS, 1 PARCEL NO.
NEW SURVEY BY M. BLASIO
NO MAP CHANGES

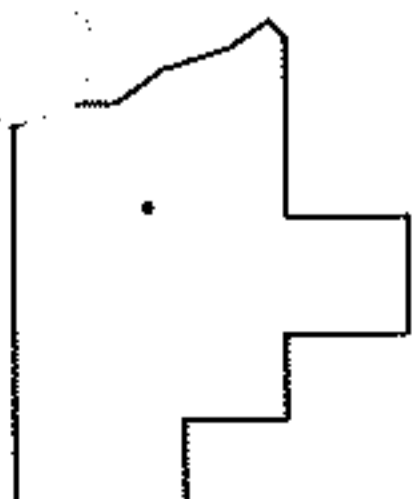

SPLITS/DEEDS PROCESSED

LORAIN COUNTY TAX MAP DEPARTMENT
226 MIDDLE AVE. ELYRIA, OHIO

SURVEYED BY: MICHAEL J. BLASIO

CLOSURE: .00:10,000

MAP PAGE(S): 3-00-107-B

APPROVED BY: RRM DATE: 8-22-12

SCALE: 1" = 100 PRIOR INST.: 20100348241