

PARENT PARCEL: 08-00-092-101-007

12-02511-A

CHILD PARCEL: _____

STARTING POINT: C/L OF S.R.113 AT THE SOUTHEAST CORNER OF LAND CONVEYED TO J.R. LEES(DV 104/409)

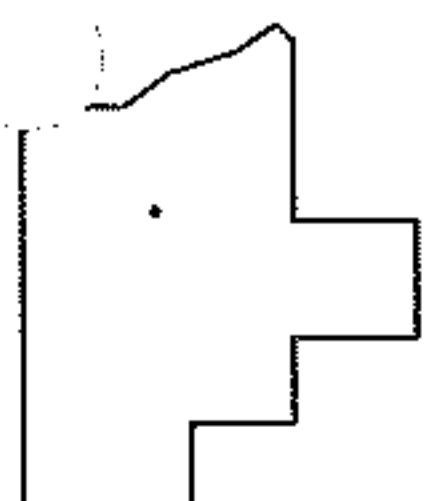
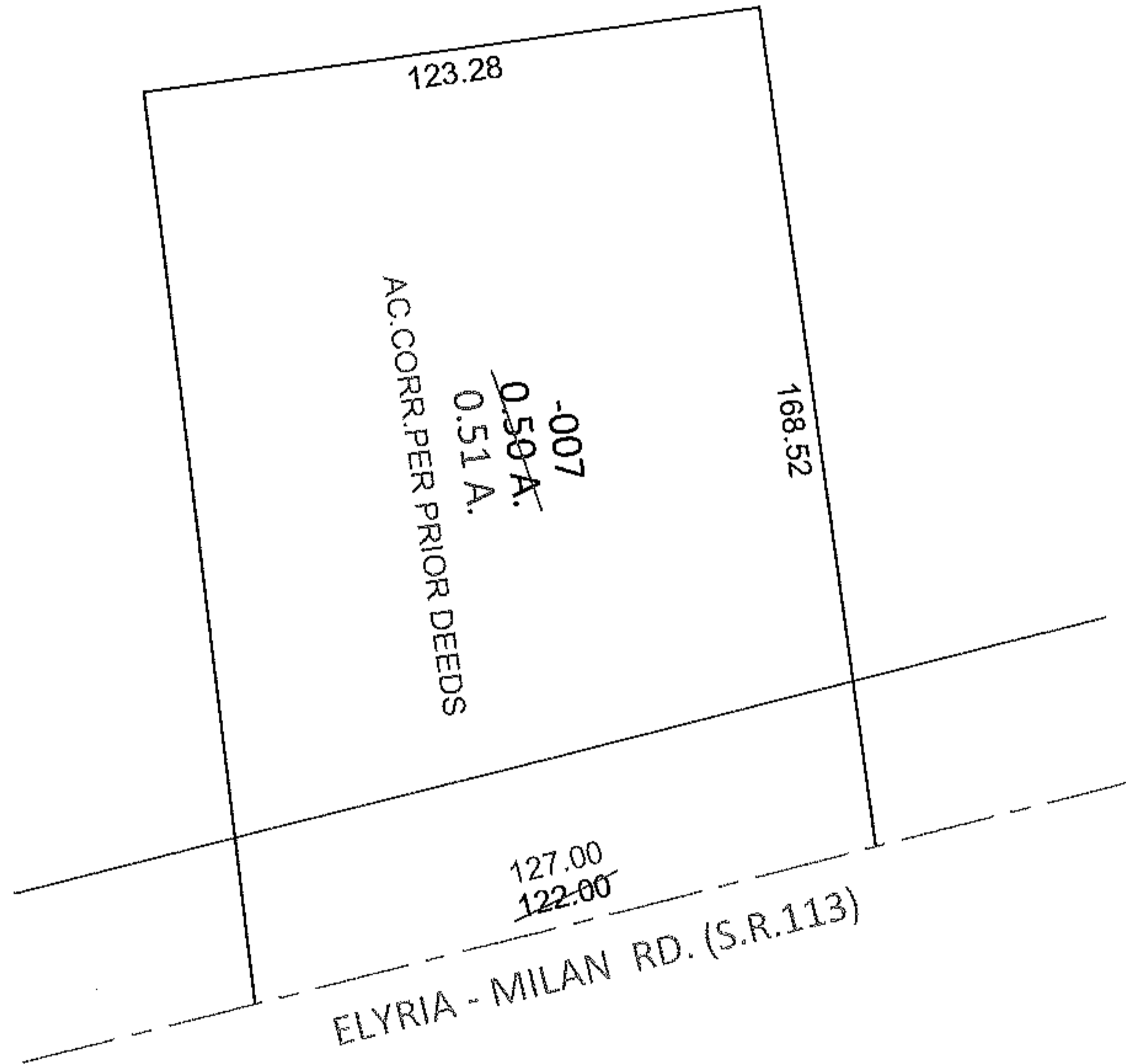
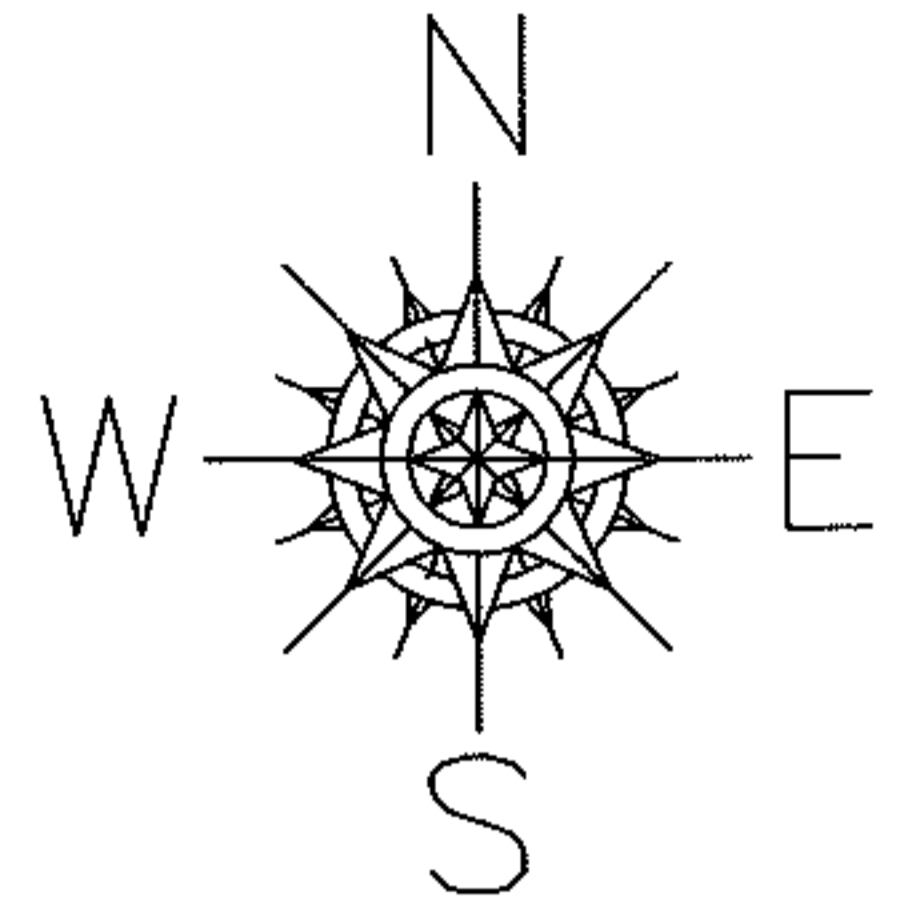

SPLITS/DEEDS PROCESSED

LORAIN COUNTY TAX MAP DEPARTMENT
226 MIDDLE AVE. ELYRIA, OHIO

SURVEYED BY: N/A

CLOSURE: N/A

MAP PAGE(S): 8-00-092-A

APPROVED BY: RRM DATE: 5-15-12

SCALE: 1" = 50' PRIOR INST.: 20120411696