

Raster

PARENT PARCEL: 02-01-006-156-011

CHILD PARCEL: 02-01-006-156-048, -049

STARTING POINT: PART OF S/L'S 286 & 287 IN STANG'S 2ND SUB. AND S/L 22 IN ZINK'S ADD.

12-02482-U

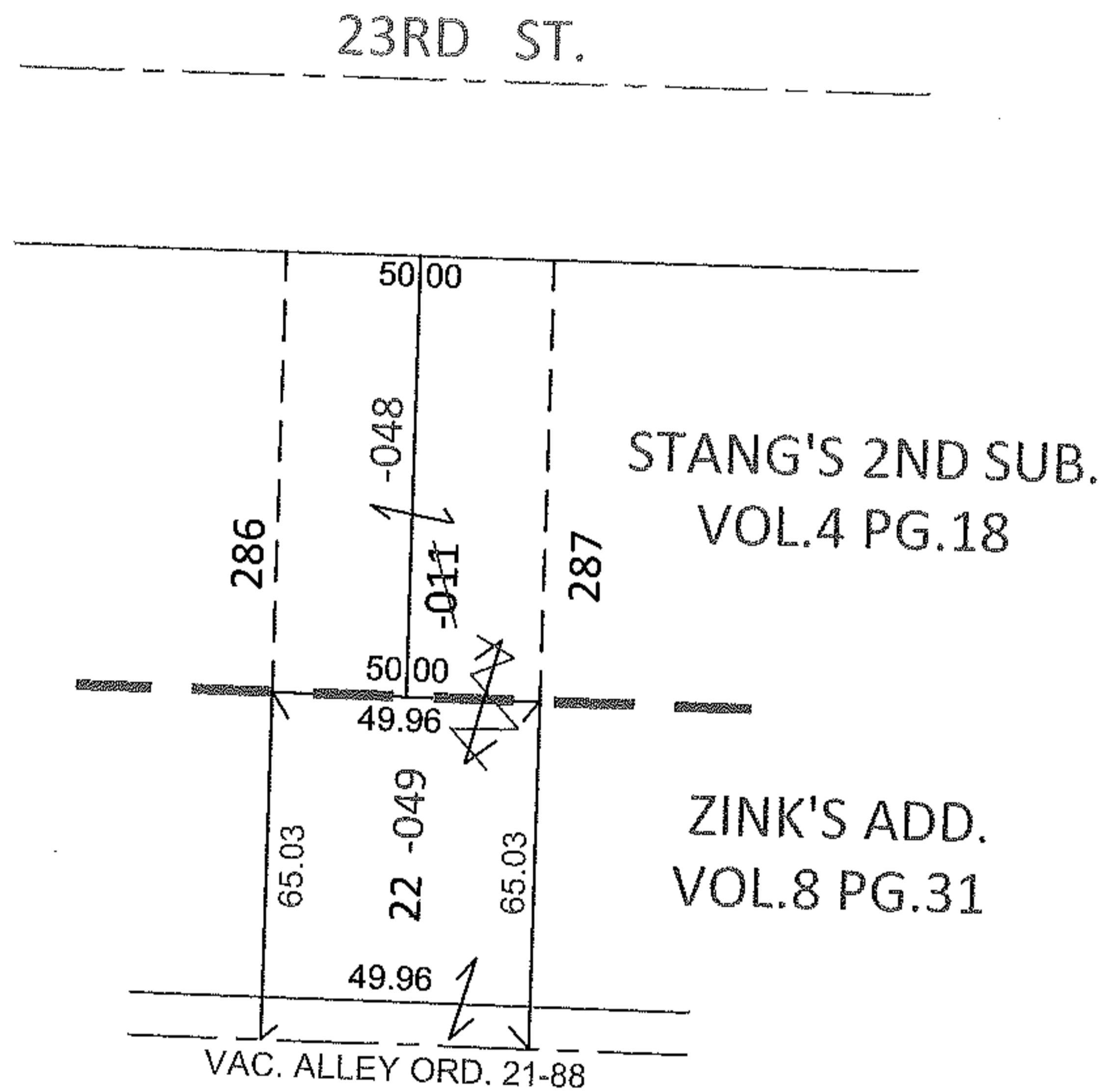
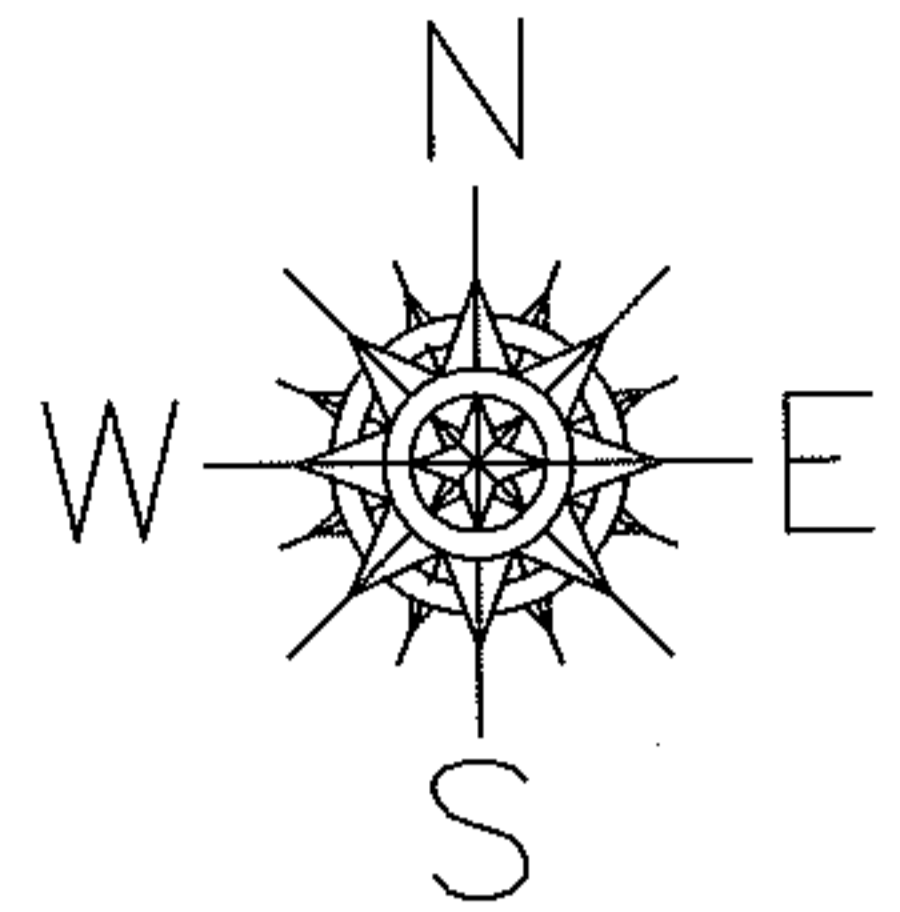

UNCOMBINATION

~~02-01-006-156-011~~

~~50 X 147.59~~

02-01-006-156-048

50 X 82.52

02-01-006-156-049

49.96 X 65.03

TO REMOVE UPDATE LEGAL FOR  
2 LEGALS, 1 PARCEL NO.

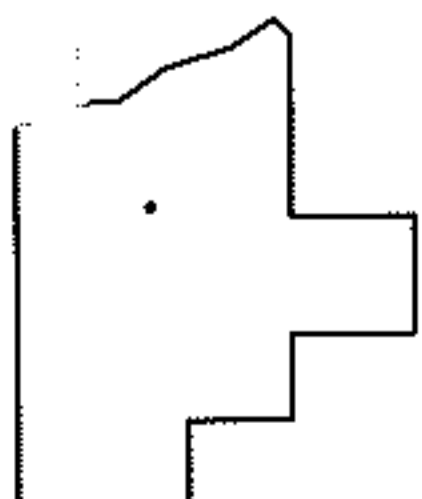

SPLITS/DEEDS PROCESSED

LORAIN COUNTY TAX MAP DEPARTMENT  
226 MIDDLE AVE. ELYRIA, OHIO

SURVEYED BY: N/A

CLOSURE: N/A

MAP PAGE(S): 2-01-006-E

APPROVED BY: RRM DATE: 4-4-12

SCALE: 1" = 50' PRIOR INST.: 20110384626